

RAV4  
2 0 1 8



QUICK REFERENCE GUIDE

# 2018

## RAV4

This Quick Reference Guide is a summary of basic vehicle operations. It contains brief descriptions of fundamental operations so you can locate and use the vehicle's main equipment quickly and easily.

The Quick Reference Guide is not intended as a substitute for the Owner's Manual located in your vehicle's glove box. We strongly encourage you to review the Owner's Manual and supplementary manuals so you will have a better understanding of your vehicle's capabilities and limitations.

Your dealership and the entire staff of Toyota Motor North America, Inc. wish you many years of satisfied driving in your new RAV4.

### *A word about safe vehicle operations*

This Quick Reference Guide is not a full description of RAV4 operations. Every RAV4 owner should review the Owner's Manual that accompanies this vehicle.

Pay special attention to the boxed information highlighted in color throughout the Owner's Manual. Each box contains safe operating instructions to help you avoid injury or equipment malfunction.

All information in this Quick Reference Guide is current at the time of printing. Toyota reserves the right to make changes at any time without notice.

# INDEX

## OVERVIEW

|   |     |
|---|-----|
| Engine maintenance                      | 9   |
| Fuel tank door release & cap            | 8   |
| Hood release                            | 8   |
| Indicator symbols                       | 4-5 |
| Instrument cluster                      | 4   |
| Instrument panel                        | 2-3 |
| Instrument panel light control          | 9   |
| Keyless (and remote) entry <sup>1</sup> | 6-7 |
| Smart Key system <sup>1</sup>           | 7   |

## FEATURES & OPERATIONS

|  |       |
|--|-------|
| Air conditioning/heating   | 15    |
| All-Wheel Drive Lock<br>(AWD models)                             | 22    |
| Audio  | 17    |
| Auto lock/unlock <sup>1</sup>                                    | 10    |
| Automatic transmission   | 10    |
| Bird's Eye View Camera<br>with Perimeter Scan function           | 20    |
| Blind Spot Monitor with Rear<br>Cross Traffic Alert (BSM w/RCTA) | 21    |
| Clock  | 20    |
| Cup holders  | 24    |
| Door locks   | 13    |
| Door-Power Liftgate  | 14    |
| ECO drive mode   | 23    |
| Garage door opener (Homelink®) <sup>3</sup>                      | 24    |
| Intuitive parking assist   | 22    |
| Lights <sup>1,2</sup> & turn signals <sup>1</sup>                | 11-12 |
| Moonroof   | 16    |
| Multi-Information Display (MID) <sup>2</sup>                     | 19    |
| Parking brake  | 10    |
| Power outlets-12V DC & 120V AC                                   | 19    |
| Rear view monitor system   | 21    |
| Seat adjustments-Front   | 13    |
| Seat adjustments-Rear  | 13    |
| Seat heaters   | 16    |
| Seats-Head restraints  | 13    |

## FEATURES & OPERATIONS (continued)

|  |    |
|--|----|
| Sport drive mode                                       | 23 |
| Steering wheel-Heater                                  | 16 |
| Steering wheel switches<br>(Audio & phone: Bluetooth®) | 18 |
| Tilt & telescopic steering wheel                       | 11 |
| USB/AUX Port   | 18 |
| Vehicle Stability Control<br>(VSC) OFF button          | 23 |
| Windows-Power  | 24 |
| Windshield wipers & washers                            | 12 |

## TOYOTA SAFETY SENSE™ P (TSS-P)

|   |       |
|---|-------|
| Automatic High Beams (AHB)  | 35    |
| Dynamic Radar   |       |
| Cruise Control (DRCC)   | 31-34 |
| Lane Departure Alert with Steering<br>Assist function (LDA w/SA)      | 28-31 |
| Pre-Collision System with Pedestrian<br>Detection function (PCS w/PD) | 26-28 |
| Quick overview-<br>Toyota Safety Sense™ P (TSS-P)                     | 25    |
| Sensors   | 25    |

## SAFETY & EMERGENCY FEATURES

|   |       |
|---|-------|
| Floor mat installation                              | 39    |
| Rear door child safety locks                        | 37    |
| Seat belts  | 36    |
| Seat belts-Shoulder belt anchor                     | 37    |
| Spare tire & tools                                  | 37    |
| Star Safety System™                                 | 38-39 |
| Tire Pressure Monitoring<br>(warning) System (TPMS) | 36    |

## BLUETOOTH® DEVICE PAIRING SECTION

|       |
|-------|
| 40-49 |
|-------|

<sup>1</sup> Visit your Toyota dealer for information on customizing this feature.

<sup>2</sup> Programmable by customer. Refer to the Owner's Manual for instructions and more information.

<sup>3</sup> HomeLink® is a registered trademark of Genex Corporation.

# Instrument panel

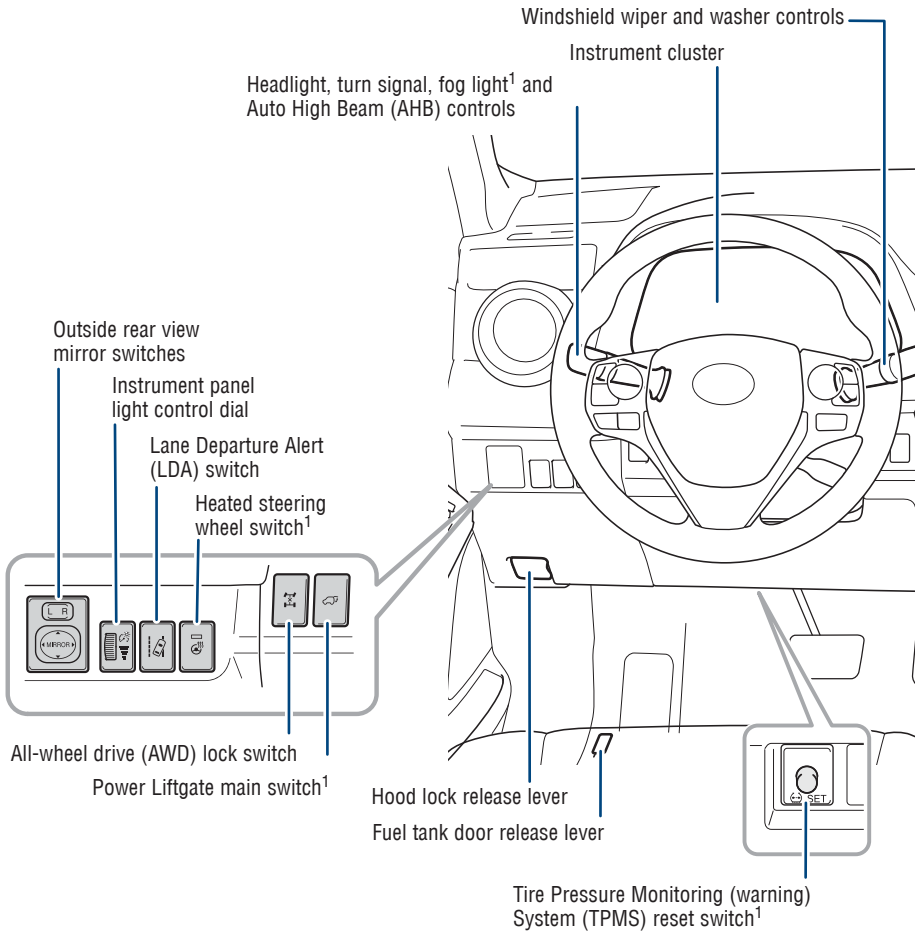
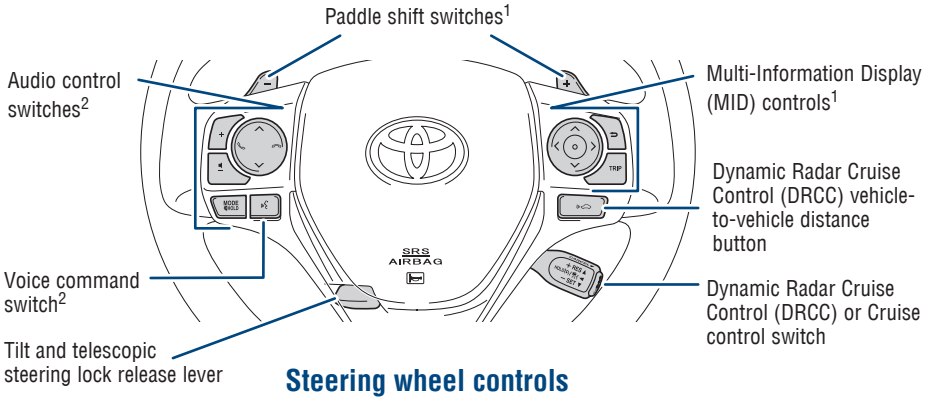

- <sup>1</sup> If equipped
- <sup>2</sup> For details, refer to the “Navigation System Owner’s Manual.”
- <sup>3</sup> For details, refer to the “2018 Entune™ Audio Quick Reference Guide.”

“ENGINE START STOP” button (Smart Key)<sup>1</sup>

Emergency flasher switch

Bird’s Eye View Camera<sup>1</sup> ON/OFF switch

Vehicle Stability Control (VSC) OFF switch

Audio<sup>2</sup>/Navigation<sup>1,2,3</sup> system

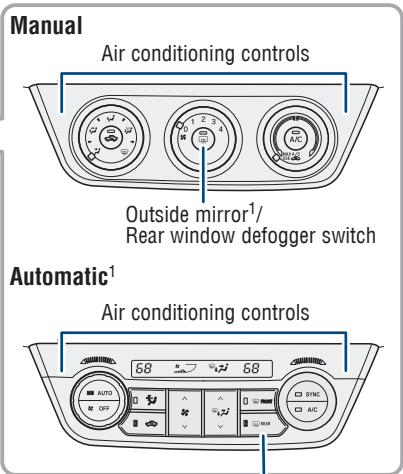

**Manual**

Air conditioning controls

Outside mirror/  
Rear window defogger switch

**Automatic<sup>1</sup>**

Air conditioning controls

Outside mirror/  
Rear window defogger switch

12V DC power outlet

12V DC power outlet

USB/AUX port<sup>2</sup>

Windshield wiper de-icer switch<sup>1</sup>

Seat heater switches<sup>1</sup>

Driving mode select switches



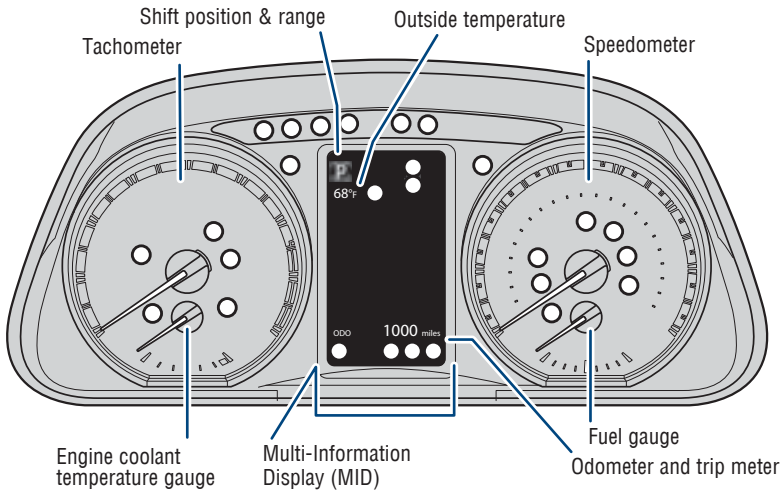







## Instrument cluster



○ Service indicators and reminders

## Indicator symbols

For details, refer to "Indicators and warning lights," Section 2-2, 2018 Owner's Manual.

|  |   |   |   |
|--|---|---|---|
|  | Airbag ON/OFF indicator                           |  | Blind Spot Monitor outside mirror indicators <sup>1</sup>                               |
|  | All-wheel drive lock indicator <sup>1</sup>       |  | Blind Spot Monitor (BSM) warning <sup>1,2</sup>   |
|  | ABS Anti-lock Brake System warning <sup>2</sup>   |  | BRAKE Brake system warning <sup>2</sup>   |
|  | Arrow direction indicates fuel tank door position |  | SET Constant speed cruise control indicator/Constant speed cruise control SET indicator |
|  | AUTO LSD indicator <sup>1,2</sup>                 |  | SET Dynamic Radar Cruise Control (DRCC) indicator/DRCC SET indicator                    |
|  | Automatic High Beam (AHB) indicator               |   |   |

<sup>1</sup> If equipped.

<sup>2</sup> If indicator does not turn off within a few seconds of starting engine, there may be a malfunction. Have vehicle inspected by your Toyota dealer.



Electric power steering system warning<sup>2</sup>



Rear passenger's seat belt reminder



ECO mode indicator



Theft deterrent/Engine immobilizer system indicator



Eco driving indicator<sup>2</sup>



Turn signal indicator



Fog light indicator<sup>1</sup>



Vehicle Stability Control (VSC) OFF indicator<sup>2</sup>



Headlight high beam indicator



Seat belt reminder (alarm will sound if speed is over 12 mph)



Headlight indicator



Slip indicator<sup>2,3</sup>



Ice warning indicator<sup>1</sup>



SPORT mode indicator



Intuitive parking assist indicator<sup>1</sup>



SRS airbag warning<sup>2</sup>



Lane Departure Alert (LDA) indicator



Low Tire Pressure Warning<sup>2</sup>



Low fuel level warning



Malfunction/Check Engine indicator<sup>2</sup>



Master warning<sup>2</sup>



Pre-Collision System (PCS) warning<sup>2</sup>

<sup>3</sup> The indicator flashes to indicate that the system is operating.

# OVERVIEW

## Keyless (and remote) entry

Beep sound can be switched ON or OFF. Refer to the Owner's Manual for more details.

### UNLOCKING OPERATION

#### Smart Key

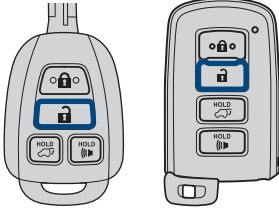

Push  
ONCE: Driver door  
TWICE: All doors

Carry Smart key

Front door unlock\*

Grasp

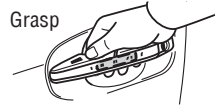

**NOTE: If a door is not opened within 60 seconds of unlocking, all doors will relock for safety.**

### LOCKING OPERATION

#### Smart Key

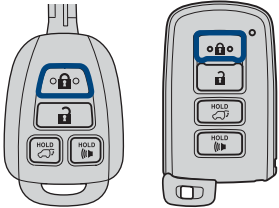

Push

Carry Smart key

Front door lock

Touch



### POWER LIFTGATE LOCK/UNLOCK (IF EQUIPPED)

#### Smart Key

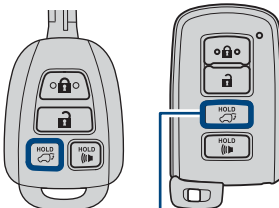

Power Liftgate hold button  
not equipped on all models

**HOLD**



Push and hold

Carry Smart key

All-door unlock and lock

Push to  
unlock

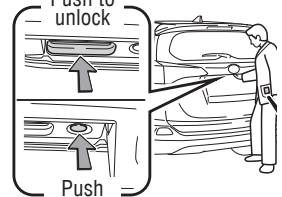

Push to  
lock

\* Driver door unlocking function can be programmed to unlock driver door only, or all doors. Grasping passenger door handle will unlock all doors.

**NOTE: Doors may also be locked/unlocked using remote.**



PANIC BUTTON

Smart Key

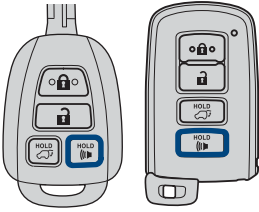

**HOLD**  
  
 Push and hold



**Smart Key system**

START FUNCTION

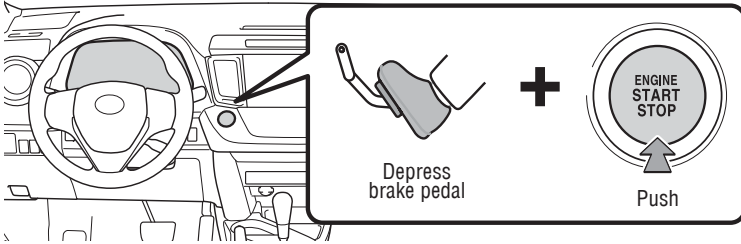

**NOTE: Gear shift lever must be in Park and brake pedal depressed.**

POWER (WITHOUT STARTING ENGINE)

Without depressing the brake pedal, pressing the “ENGINE START STOP” switch will change the operation mode in succession from:

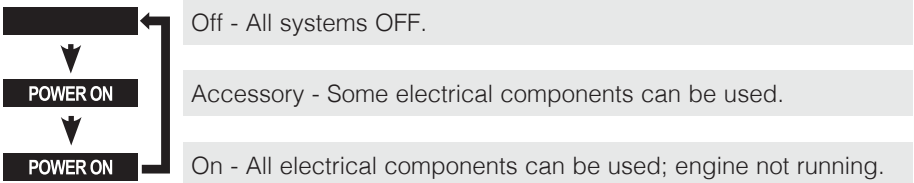

## Fuel tank door release & cap

Driver seat

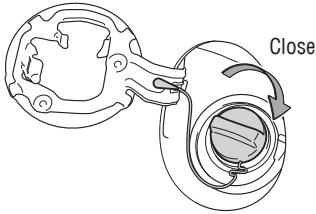
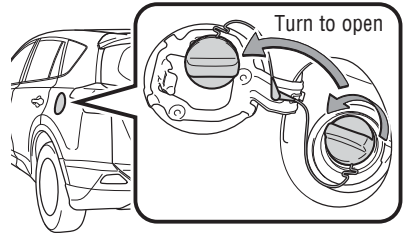
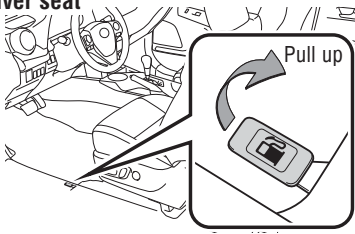

**NOTE:** Tighten until one click is heard. If the cap is not locked or tightened, Check Engine “” indicator may illuminate.

## Hood release

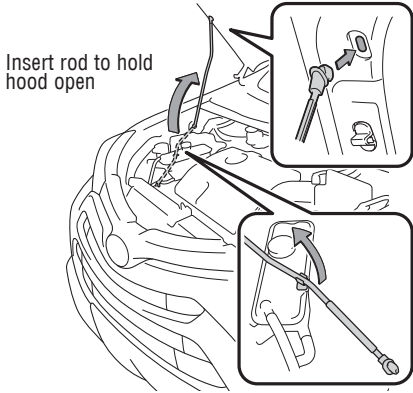
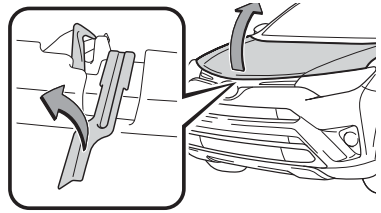
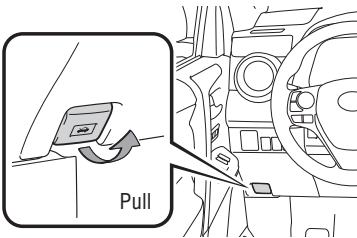

## Instrument panel light control

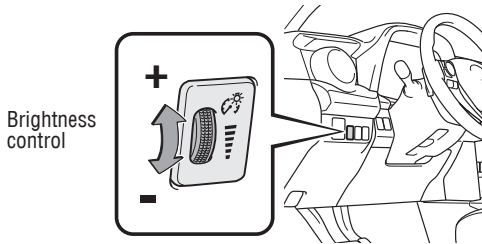

With the dial turned fully up, instrument panel lights will not dim when the headlights are turned ON.

## Engine maintenance

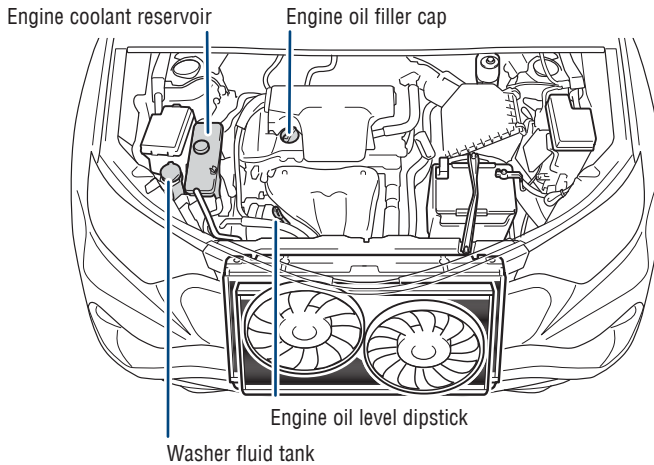

**NOTE: Regularly scheduled maintenance, including oil changes, will help extend the life of your vehicle and maintain performance. Please refer to the “Warranty & Maintenance Guide.”**

# FEATURES & OPERATIONS

## Auto lock/unlock

Automatic door locks can be programmed to operate in different modes, or turned OFF.

### Shift position linked door locking/unlocking function

- Doors lock when shifting from Park.
- Doors unlock when shifting into Park.

### Speed linked door locking function

-(With Smart Key system) Doors lock when the vehicle speed goes above approximately 12 mph.

### Driver's door linked door unlocking function

- Doors unlock when the engine switch is set from "ON" to "ACC" or "LOCK" and driver's door is opened.
- Doors unlock when the engine switch is set to OFF and driver's door is opened.

Refer to the Owner's Manual for more details.

## Automatic transmission

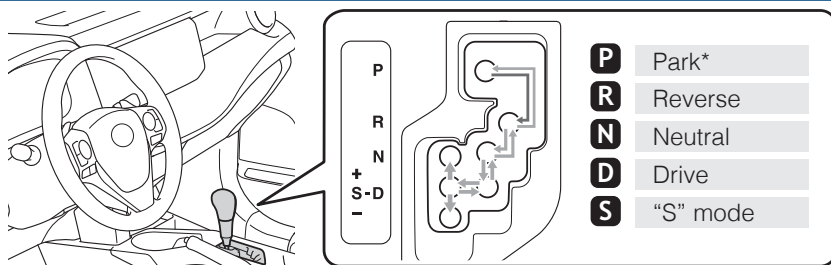

\* The "ENGINE START STOP" switch/ignition switch must be "ON" and the brake pedal depressed to shift from Park.

### "S" (SEQUENTIAL) MODE

Shift the shift lever to "S" position from "D" position.

- + : Upshift (push and release)
- : Downshift (pull and release)

Downshifting increases power going uphill, or provides engine braking downhill. For best fuel economy during normal driving conditions, always drive with the shift lever in the "D" position.

## Parking brake

Set

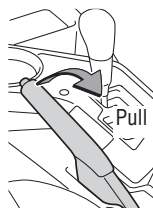

Release

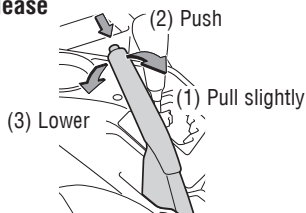

**BRAKE**

## Tilt & telescopic steering wheel

Lock release lever

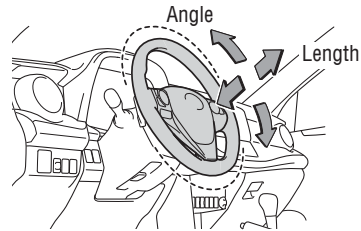
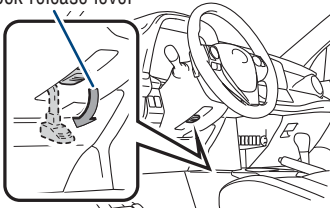

Hold wheel, push lever down, set angle and length, and return lever.

**NOTE: Do not attempt to adjust while the vehicle is in motion.**

## Lights & turn signals

### HEADLIGHTS

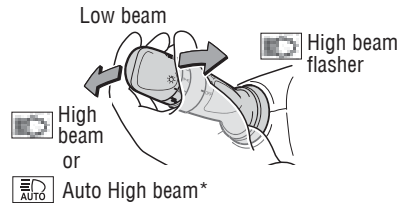
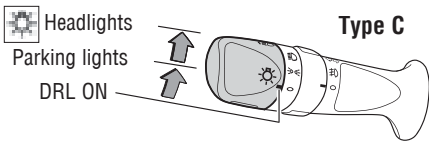
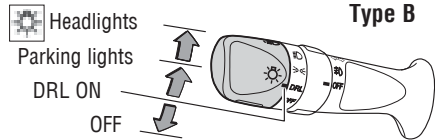
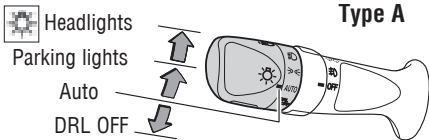

**Daytime Running Light system (DRL)** Automatically turns on the headlights at a reduced intensity.

**Automatic On/Off<sup>1</sup>** The side marker, parking, tail, license plate, instrument panel and headlights turn on and off automatically

**Automatic light cut off system<sup>1</sup>** Automatically turns lights off after a 30-second delay, or when lock switch on remote is pushed after all the doors are locked.

**Automatic High Beam (AHB) system** Automatically switches between high and low beams as appropriate to provide the most light possible and enhance forward visibility. Refer to *Toyota Safety Sense™ P (TSS-P)* in this guide or the *Owner's Manual* for more details on the Automatic High Beam feature.

\* Operating conditions must be met. Refer to Owner's Manual for details.

<sup>1</sup> If equipped.

# FEATURES & OPERATIONS

## FOG LIGHTS (IF EQUIPPED)

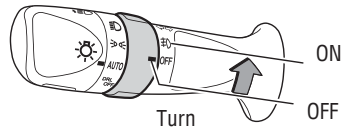

Front fog lights come on only when the headlights are on low beam.

## TURN SIGNALS

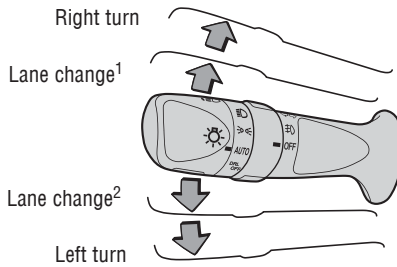
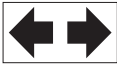

<sup>1</sup> The right hand signals will flash three times.

<sup>2</sup> The left hand signals will flash three times.

## Windshield wipers & washers

### FRONT

#### Intermittent

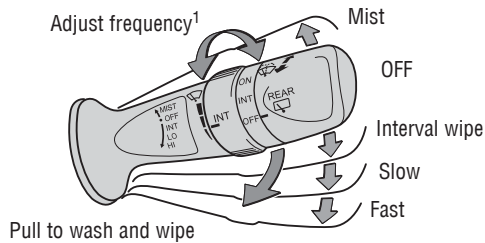

<sup>1</sup> **Intermittent windshield wiper frequency adjustment** Rotate to increase/ decrease wipe frequency.

### REAR

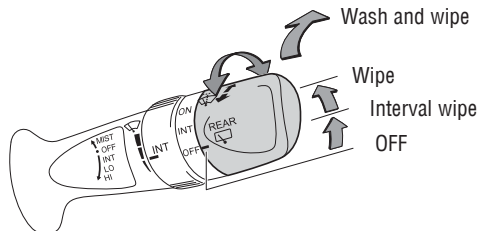

## Seats-Head restraints

Front seats

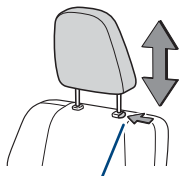

Push lock release button to push down

Rear seats

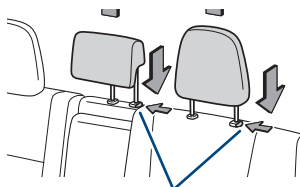

Push lock release button to push down

Rear outboard seat

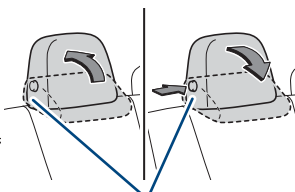

Push lock release button to push down

## Seat adjustments-Front

MANUAL SEAT

Seatback angle

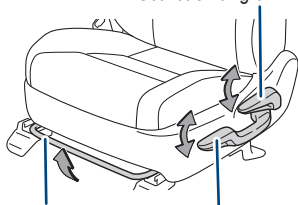

Seat position  
(forward/backward)

Height crank  
(driver side only)

POWER SEAT

Seat position  
(forward/backward)

Seatback angle

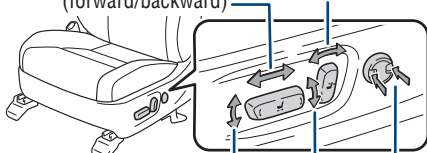

Seat position,  
cushion angle and height

Vertical height adjustment

Lumbar support (if equipped)

## Seat adjustments-Rear

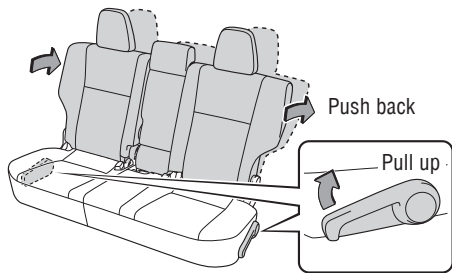

Push back

Pull up

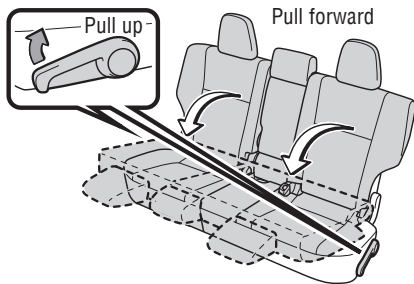

Pull up

Pull forward

## Door locks

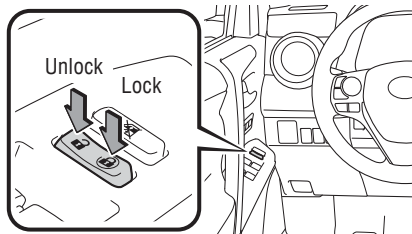

Unlock

Lock

## FEATURES & OPERATIONS

### Door-Power Liftgate (if equipped)

#### Instrument panel

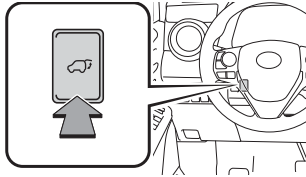

Open: Push and hold  
Close: Push and hold again

#### Power Liftgate (back door)

(close only)

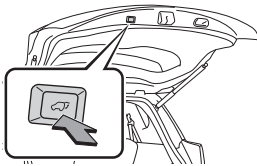

(open only)

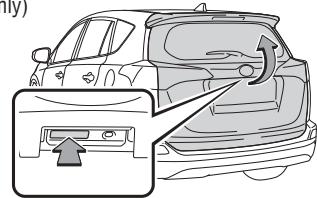

#### Touchless Power Liftgate (if equipped)

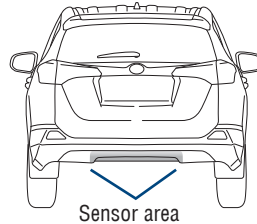
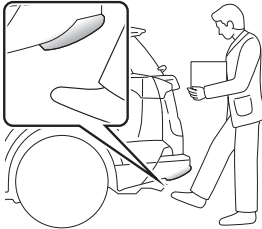



Carry remote  
Smart key feature



**To automatically open/close Power Liftgate** Put your foot near the lower center part of the rear bumper for less than 2-seconds to trigger sensor. To operate, make sure that the touchless sensor operation is enabled and that you are carrying the remote.

**NOTE: If battery is disconnected, the power back door needs to be reinitialized.**

#### PROGRAMMABLE POWER LIFTGATE

1. When the liftgate reaches the desired height, push the rear liftgate close-button (on the door jam of the liftgate) once. Press and hold the button until the buzzer sounds.
2. To reset the height, with the liftgate open and not moving, press and hold the rear liftgate close-button until it buzzer sounds 4 times, and continue to hold until it buzzes again -then let go. Push the same button to close the liftgate. When you next open the liftgate it will open to the maximum height.
3. To set the height using the Multi-Information Display, press  $\leftarrow$  or  $\rightarrow$  meter control switches and select  from the MID. Press  $\nabla$  or  $\blacktriangle$  and select  and then press  $\odot$ . Select Opening Adjustment, then press  $\odot$ . Select desired position (5 height options to choose from,) then press  $\odot$ .

**NOTE: If the liftgate has stopped operating, check inside the glove box, on the left side, to ensure the PWR DOOR OFF button has not been pushed.**

For more details, see Owner's Manual.



# Air conditioning/heating

## DUAL ZONE AUTOMATIC CLIMATE CONTROL (IF EQUIPPED)

Micro dust and pollen filter ON/OFF

Automatic climate control ON<sup>2</sup>

Temperature selector (driver side)

Synchronizes driver, front passenger and rear temperature settings

Temperature selector settings (front passenger side)

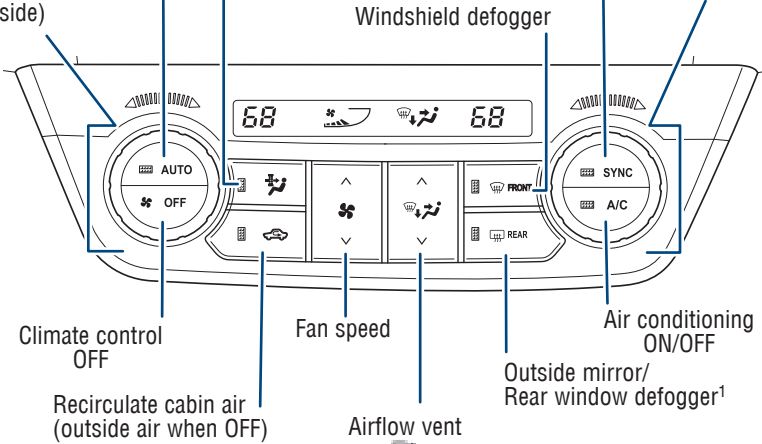

Climate control OFF

Recirculate cabin air (outside air when OFF)

Fan speed

Airflow vent

In “” or “” mode, use outside air (“” indicator OFF) to reduce window fogging.



<sup>1</sup> If equipped.

<sup>2</sup> Adjust the temperature setting, and airflow vents and fan will adjust automatically.

## MANUAL AIR CONDITIONING (IF EQUIPPED)

Recirculate cabin air (outside air when OFF)

Outside rearview mirror/Rear window defogger<sup>1</sup>

Air conditioning ON/OFF

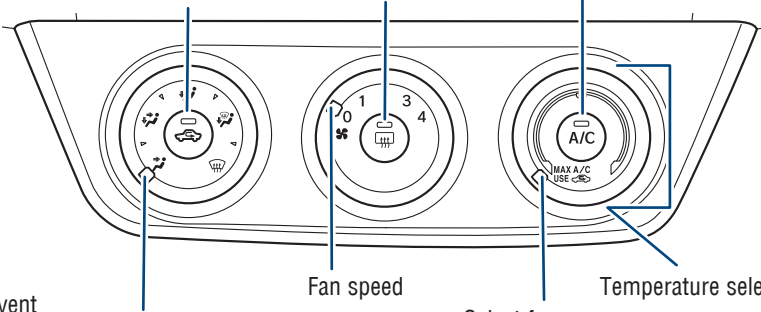

Airflow vent

In “” or “” mode, use outside air (“” indicator OFF) to reduce window fogging.

Fan speed

Select for maximum cooling

Temperature selector

<sup>1</sup> If equipped.

Refer to the Owner's Manual for more information.

# FEATURES & OPERATIONS

## Moonroof (if equipped)

### SLIDING OPERATION

Push once to open partway; again to open completely.

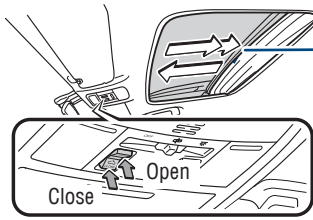

Recommended open position to minimize wind noise

### TILTING OPERATION

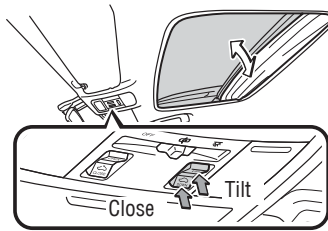

**NOTE:** If battery is disconnected, the moonroof needs to be reinitialized. *Refer to the Owner's Manual for more details.*

## Steering wheel-heater (if equipped)

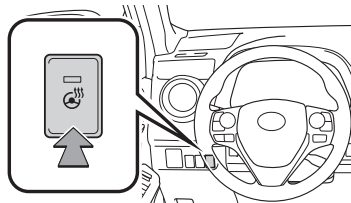

Engine switch must be in the "ON" position or MID must display the "IGNITION ON."

## Seat heaters (if equipped)

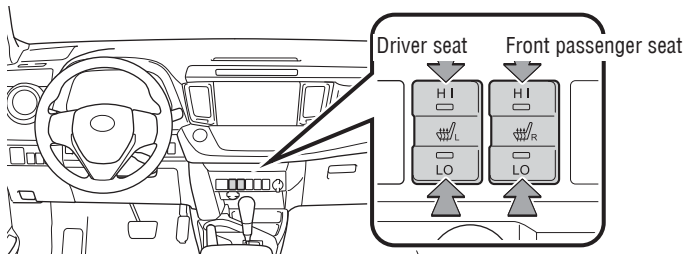

*Refer to the Owner's Manual for more details.*

# Audio

## ENTUNE™ AUDIO (LE)

Push to turn ON/OFF.

**AUDIO Button**  
Access to audio functions.

**CAR Button**  
Access to vehicle information.

**Button**  
Access telephone option screen.

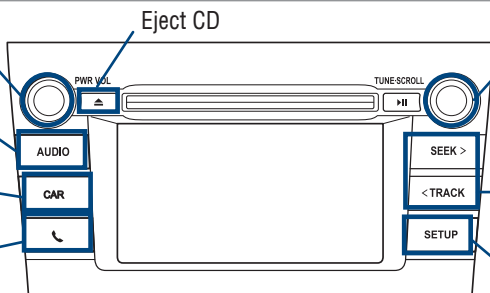

Turn to tune radio stations manually or select tracks or files.

Seek station/ CD track select.

**SETUP Button**  
Access function settings.

## ENTUNE™ AUDIO PLUS WITH CONNECTED NAVIGATION APP (XLE)

**AUDIO Button**  
Access to audio functions.

**APPS Button**  
Access to Entune® App Suite, sports, stocks, news, traffic and weather.

**HOME Button**  
Access to Home screen.

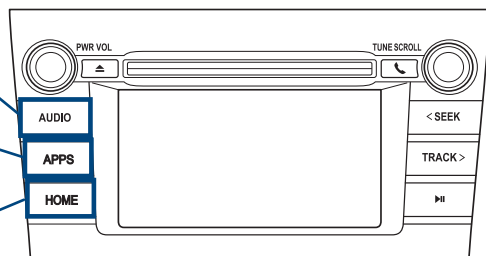

HOME SCREEN - the home screen offers a two panel and a three panel layout. Information and layout will vary depending on selected set up.

## ENTUNE™ PREMIUM (JBL®) AUDIO WITH INTEGRATED NAVIGATION AND APP SUITE (XLE/LTD)

**AUDIO Button**  
Access to audio functions.

**APPS Button**  
Access to Entune® App Suite, sports, stocks, news, traffic and weather.

**HOME Button**  
Access to Home screen. Access to Navigation System.

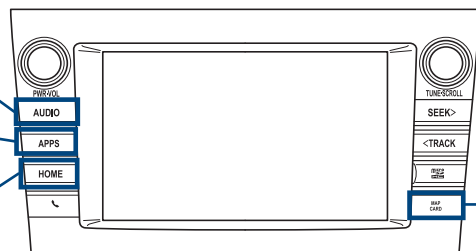

Map card insert

HOME SCREEN - the home screen offers a two panel and a three panel layout. Information and layout will vary depending on selected set up.

Refer to the Navigation System Owner's Manual and 2018 Entune™ Audio Quick Reference Guide.

**NOTE: Concentrating on the road should always be your first priority while driving. Do not use the Entune™ system if it will distract you.**

## FEATURES & OPERATIONS

### Steering wheel switches (Audio & phone: Bluetooth®)

Start call/  
Mobile Assistant access\*

Volume

End call



Use to search within the selected audio medium (radio, CD, etc.).

Microphone

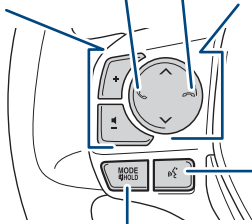

Voice command switch

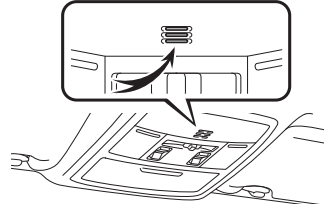

**"MODE/HOLD"** Push and hold to mute or pause current operation or change audio source.

Bluetooth® technology allows dialing or receipt of calls without removing your hands from the steering wheel or using a cable to connect the compatible telephone and the system.

\* Push and hold to access Mobile Assistant. Once you connect a compatible, registered mobile phone, you can access Siri® Eyes Free using Mobile Assistant access switch.

Refer to the *Owner's Manual and Navigation System Owner's Manual* for more details.

**NOTE: Concentrating on the road should always be your first priority while driving. Do not use the hands-free phone system if it will distract you.**

### USB/AUX port

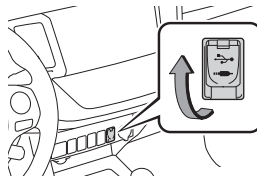

#### USB port

By connecting a USB-compatible portable audio device or USB memory to the USB port, you can listen to music from the portable audio device or USB memory through the vehicle's speaker system.

#### AUX port

By inserting a mini plug into the AUX port, you can listen to music from a portable audio device through the vehicle's speaker system while in AUX mode.

Refer to the *Navigation System Owner's Manual and 2018 Entune™ Audio Quick Reference Guide*.

## Multi-Information Display (MID)

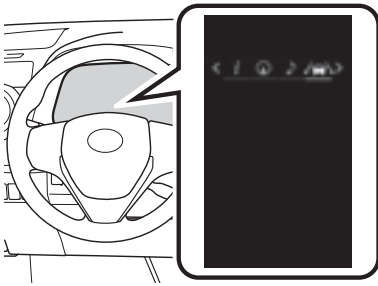





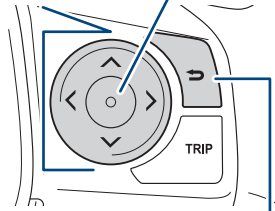

“◀” and “▶”  
Press to select an item/change  
pages

**Enter/Set:**  
Press to enter/set,  
press and hold to  
reset



Return to previous screen

Push MID control switches to view or change information in the following:

-  Drive information
-  Navigation system linked display (if equipped)
-  Audio system-linked display
-  Driving assist information (if equipped)
-  Warning messages
-  Settings display

Refer to the Owner's Manual for more information.

## Power outlets-12V DC & 120V AC

### 12V DC - Front

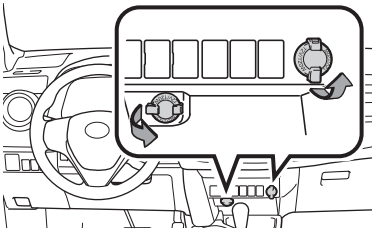

### 12V DC - Rear

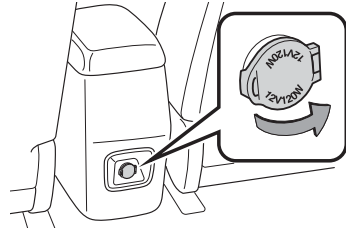

### 120V AC (if equipped)

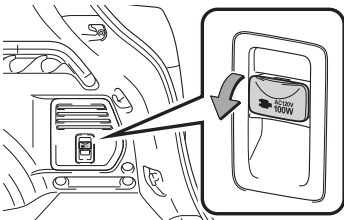

**NOTE:** Designed for car accessories. Engine switch must be in the “ACC” or “ON” position to be used.

## FEATURES & OPERATIONS

### **Bird's Eye View Camera with Perimeter Scan Function (if equipped)**

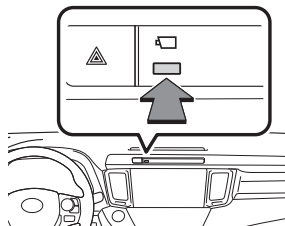

Moving view



Rotation pause switch  
See-through view switch

See through view



Rotation pause switch  
Moving view switch

The Bird's Eye View Camera with Perimeter Scan function assists the driver in viewing the surroundings, when operating at low speeds or parking, by combining front, side and rear cameras and displaying an overhead image on the Entune™ screen.

To view or turn OFF the screen, press the camera switch when the shift lever is in the "P" position. It will display two angles, the Moving view and the See Through view.

*For limitations and more details, refer to section 6-3 in the "Navigation System Owner's Manual."*

## **Clock**

To find your system, refer to the Audio section of this guide.

### FOR ENTUNE™ AUDIO

- 1) Push "SETUP" next to the screen. The system displays the Setup screen.
- 2) Select "General" to access General settings screen.
- 3) Select "Clock" to access settings.

### FOR ENTUNE™ AUDIO PLUS WITH CONNECTED NAVIGATION APP AND ENTUNE™ PREMIUM (JBL®) AUDIO WITH INTEGRATED NAVIGATION AND APP SUITE

- 1) Push "APPS" button next to the screen, then select "Setup" on the touch screen.
- 2) Select "General" on the touch screen. The system displays the "General Settings" screen.
- 3) Then select "Clock" to access settings.

*Refer to the Owner's Manual or the Navigation System Owner's Manual for more information.*

## Blind Spot Monitor with Rear Cross Traffic Alert (BSM w/RCTA) (if equipped)

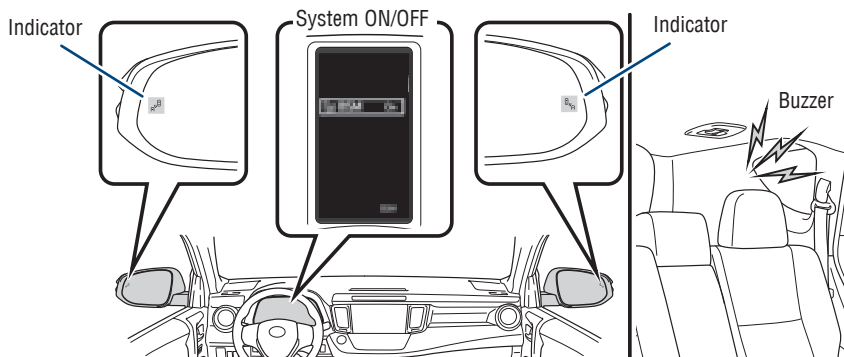

### The Blind Spot Monitor is a system that has two functions:

- The Blind Spot Monitor function (assists the driver in making the decision when changing lanes)
- The Rear Cross Traffic Alert function (assists the driver when backing up)

The system is designed to use radar sensors to detect vehicles traveling in the RAV4's blind spot and advises the driver of the vehicles' presence via the outside rear view mirror indicators.

Refer to the Owner's Manual for limitations and more details on this system before attempting to use it.

## Rear view monitor system (if equipped)

Refer to the Owner's Manual for more information.

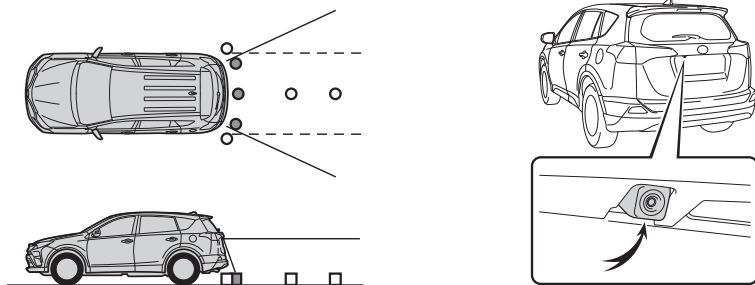

The rear view monitor system displays an image of the view from the bumper of the rear area of the vehicle. The camera for the rear view monitor system is located above the license plate.

To adjust the image on the rear view monitor screen, press the "APPS" button and select "Display" on the "Setup" screen. Select "Camera" to adjust the screen contrast and brightness.



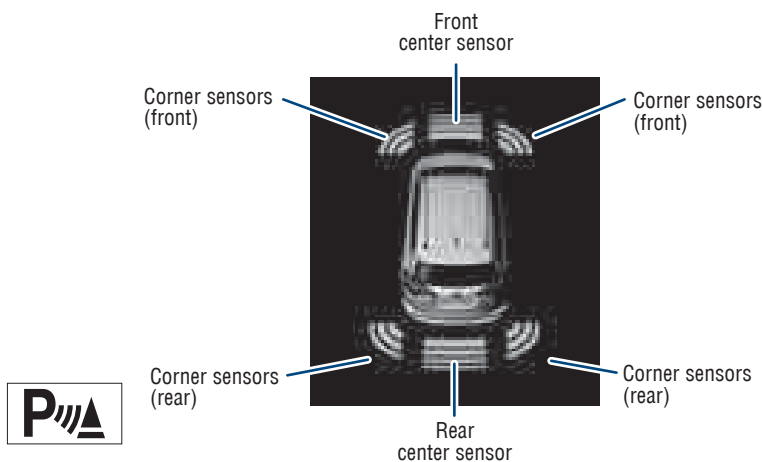

Refer to the Owner's Manual for limitations and more details on this system.

## **Intuitive parking assist (if equipped)**

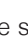

If the sensors detect an obstacle, the buzzer and MID display informs the driver of the approximate position and distance of the obstacle by illuminating continuously (far) or blinking (near). Depending on your Entune™ Audio system, you can adjust settings.

### **To turn system ON/OFF:**

- 1) Press “ < / > ”, “ ^ / v ” and “  ” of the meter control switches and select  from the Multi-Information Display (MID).
- 2) Select  and press “  ”. The system displays  when the the system is operational.

Refer to section *Intuitive parking assist* in the *Owner’s Manual* for more details.

## **All-Wheel Drive Lock (AWD models)**

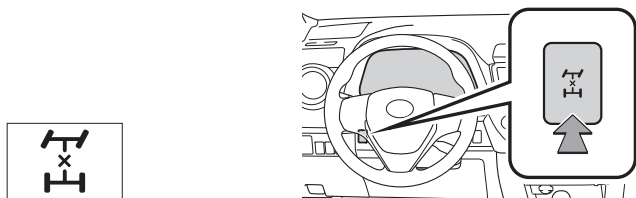

Push the switch to ensure that the engine torque is applied to the four wheels.

**NOTE: Should ONLY be used when wheel spinning occurs on loose or unpaved surfaces.**

Refer to the *Owner’s Manual* for more details.



## ECO drive mode

**ECO MODE**

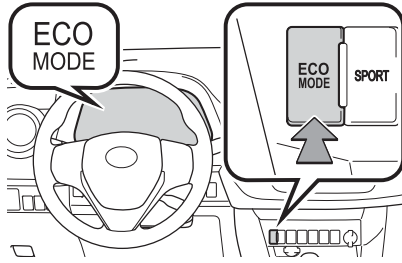

Use Eco drive mode to help achieve lower fuel consumption during trips that involve frequent accelerating.

## SPORT drive mode

**SPORT**

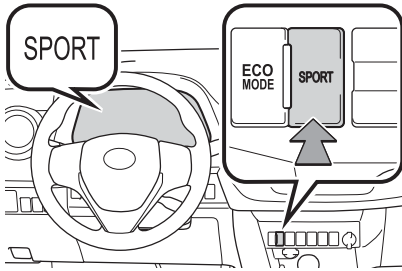

Use EV drive mode when driving short distances to reduce noise late at night in residential areas or to cut emissions when parking in a small garage or underground car park.

## Vehicle Stability Control (VSC) OFF button

### 2-Wheel Drive

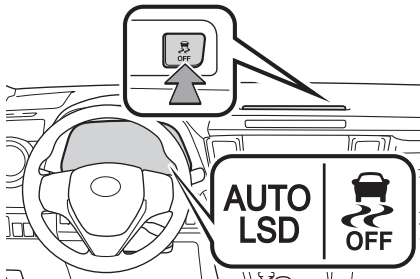

### All-Wheel Drive

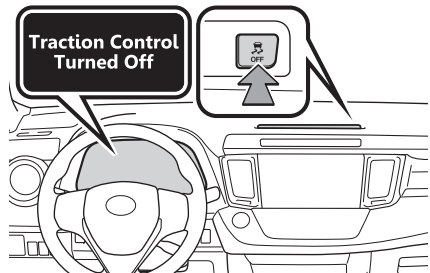

The VSC OFF button is used to switch between modes related to the TRAC, VSC and Auto LSD functions (2WD and 4WD models.)

Refer to Section 4-5 of the Owner's Manual for more information.

## FEATURES & OPERATIONS

### Garage door opener (HomeLink®)\* (if equipped)

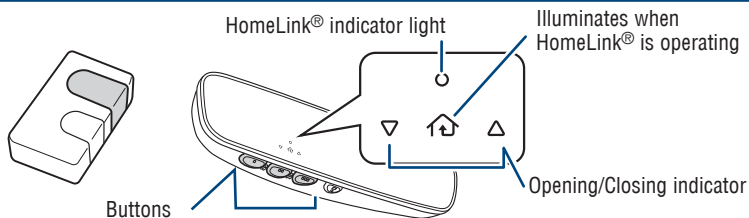

Garage door openers manufactured under license from HomeLink®\* can be programmed to operate garage doors, estate gates, security lighting, etc.

Refer to "Garage door opener," Section 6-4 in the Owner's Manual, for more details.

For programming assistance, contact HomeLink® at 1-800-355-3515, or visit <http://www.homelink.com>.

\* HomeLink® is a registered trademark of Gentex Corporation.

### Windows-Power

#### Driver side

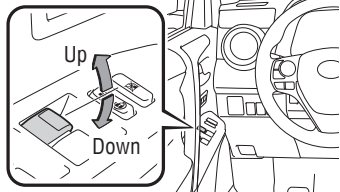

#### Window lock switch

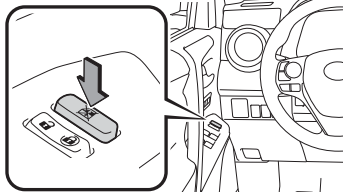

**Automatic operation** Push the switch completely down or pull it completely up and release to fully open or close. To stop window partway, lightly push the switch in the opposite direction.

**Window lock switch** Deactivates all passenger windows. Driver's window remains operable.

### Cup holders

#### Front

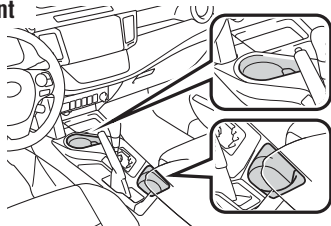

#### Rear

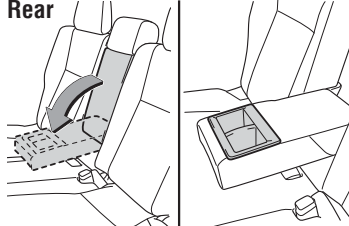

## Quick overview-Toyota Safety Sense™ P (TSS-P)

Toyota Safety Sense™ P (TSS-P) is a set of active safety technologies designed to help mitigate or prevent collisions across a wide range of traffic situations, in certain conditions. TSS-P is designed to help support the driver's awareness, decision making and vehicle operation contributing to a safe driving experience.

**Refer to the Owner's Manual for operation, setting adjustments, limitations and more details to understand these functions and complete safety precautions. For more information, please go to <http://www.toyota.com/safety-sense>**



**Pre-Collision System with Pedestrian Detection function (PCS w/PD)**  
PCS w/PD is designed to provide alert, mitigation, and/or avoidance support in certain conditions, when the system detects a potential collision with a preceding vehicle is likely to occur.



Advanced millimeter-wave radar sensor system is designed to work with the camera sensor to help recognize a preceding pedestrian, and provide an alert, mitigation and/or avoidance support in certain conditions.



**Lane Departure Alert with Steering Assist function (LDA w/SA)**  
LDA w/SA is designed to provide notification when the system detects an unintended lane departure.

The Steering Assist function is designed to provide small corrective steering inputs to the steering wheel for a short period of time to help keep the vehicle in its lane.



### Dynamic Radar Cruise Control (DRCC)

DRCC is designed to help maintain a pre-set distance to a preceding vehicle when the preceding vehicle is traveling at a lower speed.



### Automatic High Beams (AHB)

AHB is designed to detect the headlights of oncoming vehicles and the tail lights of preceding vehicles and switch between high beams and low beams as appropriate.

## Sensors

TSS-P combines an in-vehicle camera mounted in front of the inside rear view mirror and a millimeter-wave radar mounted in the front grill. These sensors support the driver assist systems.

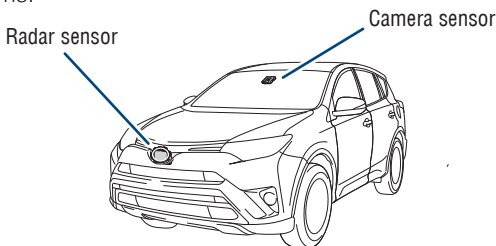

## **Pre-Collision System with Pedestrian Detection function (PCS w/PD)**

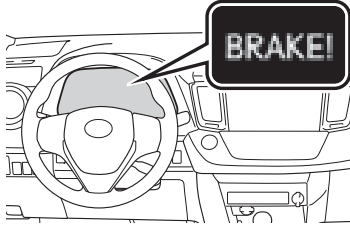

The Pre-Collision System uses a radar sensor and camera sensor to help detect a vehicle or pedestrian in front of your vehicle.

As there is a limit to the degree of recognition accuracy and control performance that this system can provide, do not overly rely on this system. This system will not prevent collisions or lessen collision damage or injury in every situation. Do not use PCS instead of normal braking operations under any circumstances. Do not attempt to test the operation of the pre-collision system yourself, as the system may not operate or engage, possibly leading to an accident. In some situations, such as when driving in inclement weather such as heavy rain, fog, snow or a sandstorm or while driving on a curve and for a few seconds after driving on a curve, a vehicle may not be detected by the radar and camera sensors, preventing the system from operating or engaging properly.

*Refer to a Toyota Owner's Manual for a list of additional situations in which the system may not operate properly.*

### **Pre-Collision Warning**

When the system determines that the possibility of a frontal collision is high, a buzzer will sound and a warning message will be displayed on the Multi-Information Display (MID) to urge the driver to take evasive action.

### **Pre-Collision Brake Assist**

If the driver notices the hazard and brakes, the system may provide additional braking force using Brake Assist. This system may prime the brakes and may apply greater braking force in relation to how strongly the brake pedal is depressed.

### **Pre-Collision Braking**

If the driver does not brake in a set time and the system determines that the possibility of a frontal collision with a preceding vehicle is extremely high, the system may automatically apply the brakes, reducing speed in order to help the driver reduce the impact and in certain cases avoid the collision.

*Refer to a Toyota Owner's Manual for additional information on PCS w/PD operation, settings adjustments, limitations, and precautions before attempting to use it.*

## THE PCS WITH PEDESTRIAN DETECTION FUNCTION

In certain conditions, the PCS system included with the TSS-P package may also help to detect a pedestrian in front of your vehicle. With Toyota Safety Sense™ P, PCS uses an in-vehicle camera and front-grill mounted millimeter-wave radar to help detect a pedestrian in front of your vehicle in certain conditions. The in-vehicle camera of PCS detects a potential pedestrian based on size, profile, and motion of the detected pedestrian. However, a pedestrian may not be detected depending on the conditions, including the surrounding brightness and the motion, posture, size, and angle of the potential detected pedestrian, preventing the system from operating or engaging. Refer to a Toyota Owner's Manual for additional information.

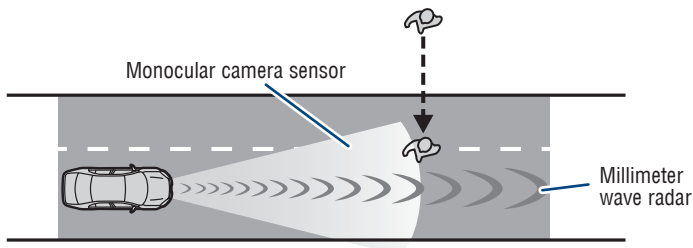

As part of the Pre-Collision System, this function is also designed to first provide an alert and then automatic braking if needed.

## CHANGING THE PCS ALERT TIMING

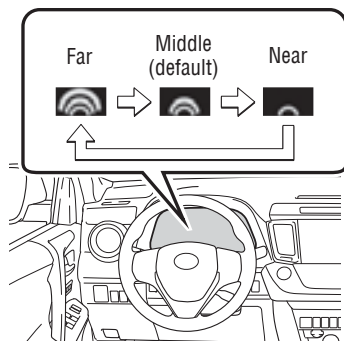



- (1) Press “<>” switches and select  from the Multi-Information Display (MID).
- (2) Press “<” switches and select  from the MID and then press “○.”
- (3) Select “Sensitivity” and then press “○.”

Each time “○” is pressed, the response to the PCS alert timing changes as shown above. You can press “➔” to go back to the menu.

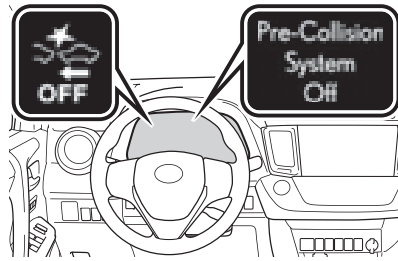
**Note: PCS is enabled each time the engine switch is turned to Ignition On. The system can be disabled/enabled and the alert timing of the system can be changed. (Alert timing only, brake operation remains the same).**



- (1) Press “<>” switches and select  from the Multi-Information Display (MID).
- (2) Press “◇” switches and select the  setting function from the MID and then press “○”. The setting screen is displayed.
- (3) Select **PCS** and then press “○”. The Pre-Collision System will be disabled. Press again to enable. You can press “➔” to go back to the menu.

**Note:** The system is enabled each time the engine switch is turned to Ignition On.

## Lane Departure Alert with Steering Assist function (LDA w/SA)

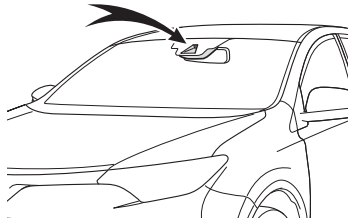

LDA in TSS-P uses an in-vehicle camera designed to detect visible white and yellow lane markers in front of the vehicle and the vehicle's position on the road. If the system determines that the vehicle is starting to unintentionally deviate from its lane, the system alerts the driver with an audio and visual alert. When the alerts occur, the driver must check the surrounding road situation and carefully operate the steering wheel to move the vehicle back to the center part of their lane.

LDA is designed to function at speeds of approximately 32 MPH or higher on relatively straight roadways.

In addition to the alert function, LDA w/SA also features a steering assist function. When enabled, if the system determines that the vehicle is on a path to unintentionally depart from its lane, the system may provide small corrective steering inputs to the steering wheel for a short period of time to help keep the vehicle in its lane.

## TURNING THE LDA SYSTEM ON/OFF

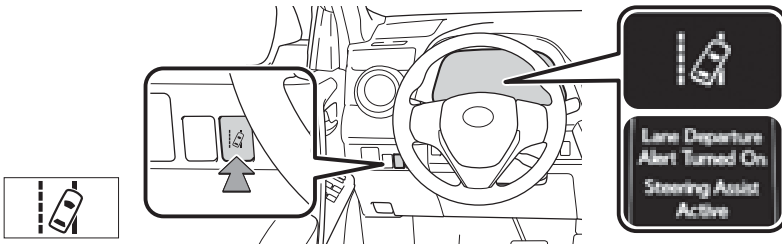

Press the LDA switch to turn the LDA system on. Depress again to turn it off.

**Note: The system will continue in the last state it was in (ON or OFF) when the engine is started again.**

Refer to a Toyota Owner's Manual for additional information on LDA operation, settings adjustments, limitations, and precautions before attempting to use it.

## LDA FUNCTIONS

### LDA function display

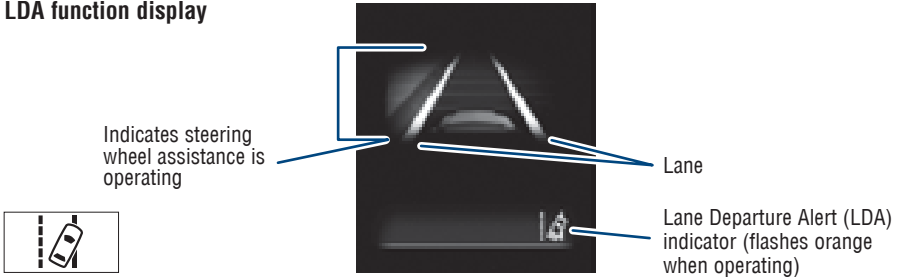



Indicates steering wheel assistance is operating

Lane

Lane Departure Alert (LDA) indicator (flashes orange when operating)

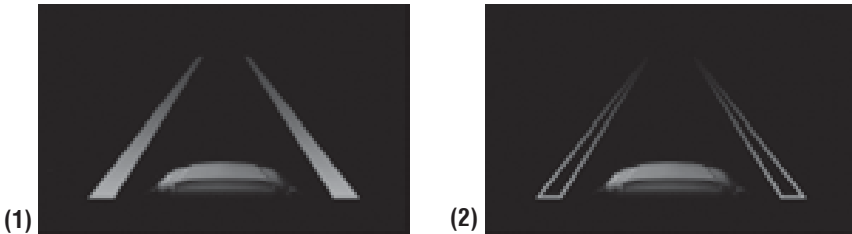
Lane Departure Alert (LDA) indicator flashes orange when operating



The LDA function  displays when the Multi-Information Display (MID) is switched to the driving assist system information screen.

(1) The system displays solid white lines on the LDA indicator when visible lane markers on the road are detected. A side flashes orange to alert the driver when the vehicle deviates from its lane.

(2) The system displays outlines on the LDA indicator when lane markers on the road are not detected or the function is temporarily cancelled.

**Note: When operation conditions are no longer met, a function may be temporarily canceled. However, when the operation conditions are met again, operation of the function is automatically restored. For example, LDA may not function on the side(s) where white/yellow lines are not detectable.**

## DISABLING THE STEERING ASSIST FUNCTION

- (1) Press “◀▶” switches and select  from the Multi-Information Display (MID).
- (2) Press “◊” switches to find the steering assist function and then press “○” to select. You can press “↩” to go back to the menu.

**Note: Operation of the LDA system and setting adjustments continues in the same condition regardless of ignition cycle until changed by the driver or the system is reset.**

## ADJUSTING LDA ALERT SENSITIVITY

The driver can adjust the sensitivity of the LDA (warning) function from the Multi-Information Display (MID) customization screen.

**High** - Is designed to warn approximately before the front tire crosses the lane marker.

**Normal** - Is designed to warn approximately when the front tire crosses the lane marker.

- (1) Press “◀▶” switches and select  from the Multi-Information Display (MID).
- (2) Press “◊” switches to find the alert sensitivity setting and then press “○” to select. You can press “↩” to go back to the menu.

## THE SWAY WARNING SYSTEM (SWS) FUNCTION



Continuous lane deviations from swaying.



Gentle swaying from driver's inattentiveness.



Acute steering wheel operation after the number of operations decrease due to driver's inattentiveness.



SWS is a function of LDA and is designed to detect swaying based on the vehicle location in the lane and the driver's steering wheel operation. To help prevent swaying, the system alerts the driver using a buzzer sound and a warning displays in the MID.



DISABLING THE LDA SWAY WARNING SYSTEM

- (1) Press “<>” switches and select  from the Multi-Information Display (MID).
- (2) Press “<” switches to find the sway warning function and then press “○” to select. You can press “>” to go back to the menu.

**Note: Operation of the LDA system and setting adjustments continues in the same condition regardless of ignition cycle until changed by the driver or the system is reset.**

ADJUSTING SWAY ALERT SENSITIVITY

- (1) Press “<>” switches and select  from the Multi-Information Display (MID).
- (2) Press “<” switches to find the sway warning function and then press “○” to select. You can press “>” to go back to the menu.

**Note: Operation of the LDA system and setting adjustments continues in the same condition regardless of ignition cycle until changed by the driver or the system is reset.**

**Dynamic Radar Cruise Control (DRCC)**

DRCC helps maintain a pre-set distance to a preceding vehicle when the preceding vehicle is traveling at a lower speed. This mode is always selected first when the cruise control button is depressed. Constant speed cruise control mode is also available.

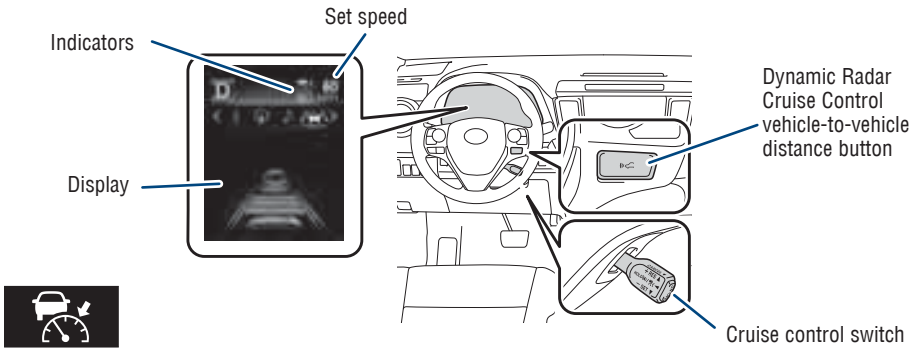

TURNING SYSTEM ON/OFF

(1)

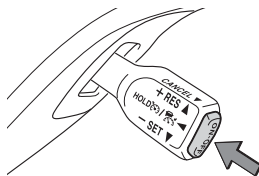

Note: If DRCC is turned off and you hold the ON-OFF button for at least 1.5 seconds, the system switches to constant speed control mode.

# TOYOTA SAFETY SENSE™

## ADJUSTING DRCC SET SPEED

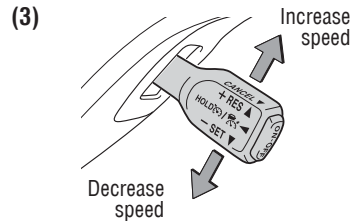
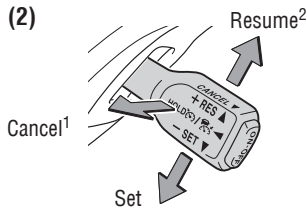
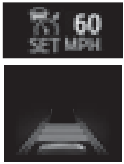

Vehicle will cruise at a set speed, decelerate to maintain selected distance from a slower vehicle traveling in front and accelerate back up to the selected speed if the vehicle in front changes lanes or speeds up.

- (1) Push the ON-OFF button. The “RADAR READY” or “” indicator will come on.
- (2) Push the lever down to SET speed, push it up to Resume and pull it or depress brake to Cancel.
- (3) Push up to increase the set speed, push down to decrease (1 mph increments).

<sup>1</sup> The set speed may also be cancelled by depressing the brake pedal.

<sup>2</sup> The set speed may be resumed once vehicle speed exceeds 25 mph (40 km/h).

## ADJUSTING DISTANCE

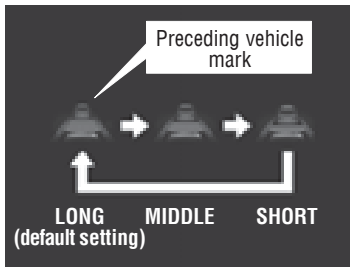
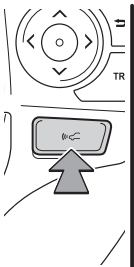

To change the vehicle-to-vehicle distance  
Push the “” button to cycle through the settings, which will change progressively.

This mode employs a radar sensor to detect the presence of vehicles up to approximately 160 ft (50 m) ahead, determines the current vehicle-to-vehicle following distance and operates to maintain a suitable following distance from the vehicle ahead.

**Note: Vehicle-to-vehicle distance will close in when traveling on long downhill slopes.**

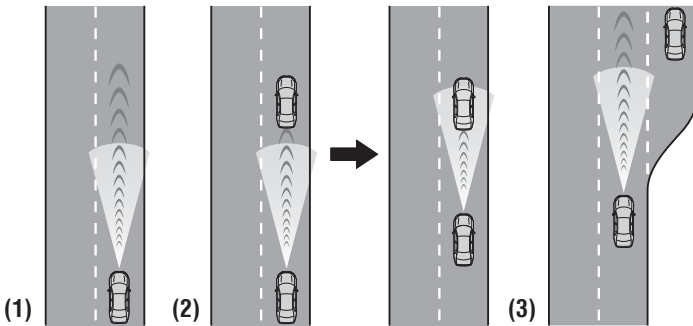

(1) **Constant speed cruising when there are no vehicles ahead**

The vehicle travels at the speed set by the driver. The desired vehicle-to-vehicle distance can also be set by operating the vehicle-to-vehicle distance control.

(2) **Deceleration cruising and follow-up cruising when a preceding vehicle driving slower than the set speed appears**

When a vehicle is detected running ahead of you, the system automatically decelerates your vehicle. When a greater reduction in vehicle speed is necessary, the system applies the brakes (the brake lights will come on at this time). The system will respond to changes in the speed of the vehicle ahead in order to maintain the vehicle-to-vehicle distance set by the driver. A warning tone warns you when the system cannot decelerate sufficiently to prevent your vehicle from closing in on the vehicle ahead.

(3) **Acceleration when there are no longer any preceding vehicles driving slower than the set speed**

The system accelerates until the set speed is reached. The system then returns to constant speed cruising.

**Note:** When your vehicle is too close to a vehicle ahead, and sufficient automatic deceleration via the cruise control is not possible, the display will flash and the buzzer will sound to alert the driver. An example of this would be if another driver cuts in front of you while you are following a vehicle. Depress the brake pedal to ensure an appropriate vehicle-to-vehicle distance.

## SWITCHING TO CONSTANT SPEED (CRUISE) CONTROL MODE

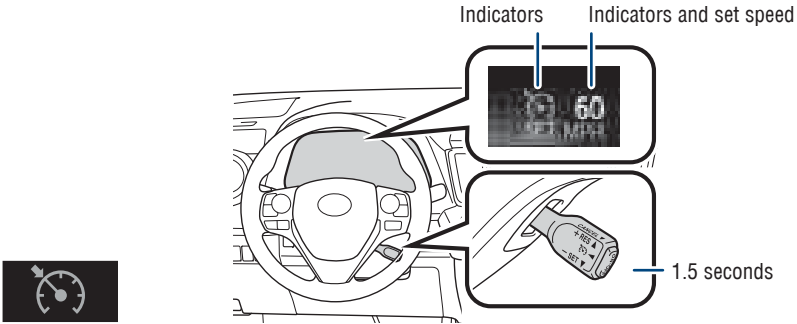

If you are already using DRCC “”, push button again to turn the system off first, then push and hold button for at least 1.5 seconds to switch.

**Note: When the engine is turned off, it will automatically default to DRCC.**

## SETTING CONSTANT SPEED (CRUISE) CONTROL

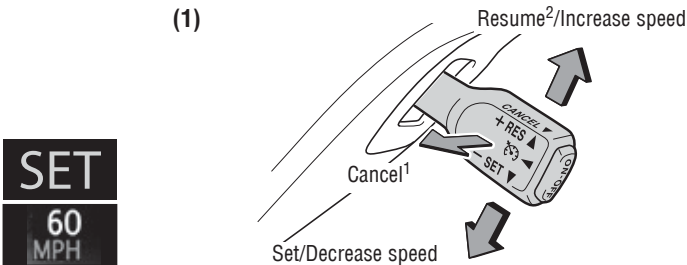

(1) To adjust speed or cancel, see steps (2) and (3) of ADJUSTING DRCC SET SPEED on page 32.

<sup>1</sup> The set speed may also be cancelled by depressing the brake pedal.

<sup>2</sup> The set speed may be resumed once vehicle speed exceeds 25 mph (40 km/h).

Refer to a Toyota Owner's Manual for additional information on DRCC operation, settings adjustments, limitations, and precautions before attempting to use it.

## Automatic High Beams (AHB)

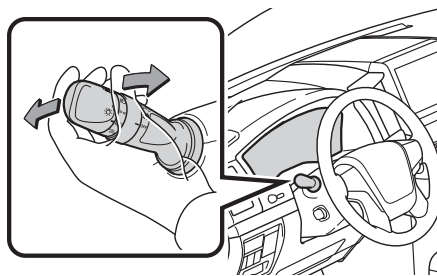

AHB is a safety system designed to help drivers see more of what's ahead at nighttime without dazzling other drivers. When enabled, AHB uses an in-vehicle camera to help detect the headlights of oncoming vehicles and tail lights of preceding vehicles, then automatically switches between high and low beams as appropriate to provide the most light possible and enhance forward visibility. By using high beams more frequently, the system may allow earlier detection of pedestrians and obstacles.

*Refer to a Toyota Owner's Manual for additional information on AHB operation, settings adjustments, limitations, and precautions before attempting to use it.*

### ACTIVATING THE AHB SYSTEM

- (1) With the engine switch in IGNITION ON mode and headlight switch turned to "AUTO" position, push lever away from you.

The "  " indicator will come on when the headlights are turned on automatically to indicate that the system is active.

- (2) Pull the lever back toward you to turn the AHB system off.

The "  " will turn off and the "  " turns on.

### CONDITIONS WHERE AHB WILL TURN ON/OFF AUTOMATICALLY

When all of these conditions are met, high beams will be automatically turned on (after approximately 1 second):

- Vehicle speed is above approximately 21 mph (34 km/h).
- The area ahead of the vehicle is dark.
- There are no oncoming or preceding vehicles with headlights or tail lights turned on.
- There are few street lights on the road ahead.

If any of these conditions occur, the system is designed to automatically turn off high beams:

- Vehicle speed drops below approximately 17 mph (27 km/h).
- The area ahead of the vehicle is not dark.
- Oncoming or preceding vehicles have headlights or tail lights turned on.
- There are many streetlights on the road ahead.

## SAFETY & EMERGENCY FEATURES

### Seat belts

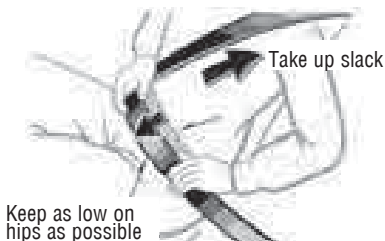
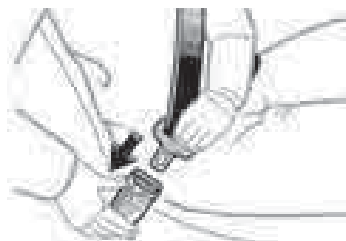

**NOTE: If a passenger's seat belt is fully extended, then retracted even slightly, the Automatic locking retractor (ALR) will prevent it from being re-extended beyond that point, unless fully retracted again. This feature is used to help hold child restraint systems securely.**

*To find more information about seat belts, and how to install a child restraint system, refer to the Owner's Manual.*

### Tire Pressure Monitoring (warning) System (TPMS)

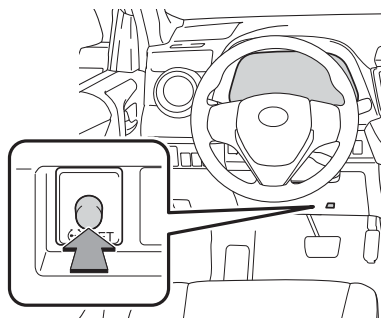

#### System reset initialization

1. Push and hold "SET" button until the indicator blinks three times.
2. Wait a few minutes to allow initialization to complete.

After adjusting tire pressures, or after tires have been rotated or replaced, turn the ignition switch to "ON" and follow the steps above to reset the TPMS.

*Refer to the load label on the door jamb or the Owner's Manual for tire inflation specifications.*

If the tire pressure indicator flashes for more than 60 seconds and then remains on, take the vehicle to your local Toyota dealer.

**NOTE: The warning light may come on due to temperature changes or changes in tire pressure from natural air leakage. If the system has not been initialized recently, setting the tire pressures to factory specifications should turn off the light.**

## Rear door child safety locks

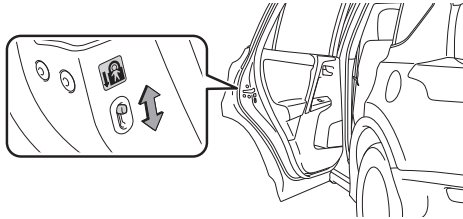

Moving the lever downward will allow the door to be opened only from the outside.

## Seat belts-Shoulder belt anchor

Push up or squeeze lock release to lower

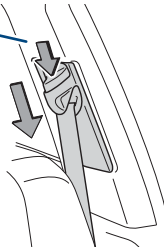

## Spare tire & tools

### TOOL LOCATION

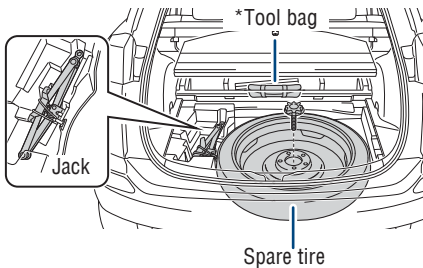

\* May be placed with Jack

### REMOVING THE SPARE TIRE

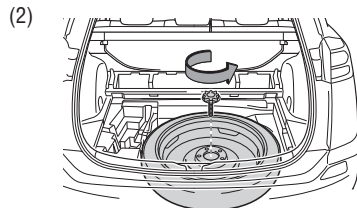
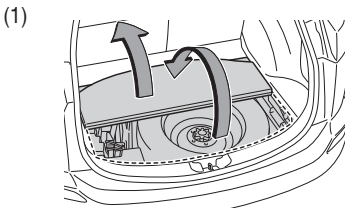

- (1) Remove the rear deck board.
- (2) Loosen the center fastener that secures the spare tire.

Refer to the Owner's Manual for tire changing and jack positioning procedures.

# SAFETY & EMERGENCY FEATURES

## Star Safety System™

Your vehicle comes standard with the Star Safety System™, which combines Anti-lock Braking System (ABS), Brake Assist (BA), Electronic Brake-force Distribution (EBD), Smart Stop Technology (SST), Vehicle Stability Control (VSC) and Traction Control (TRAC).

*Refer to the Owner's Manual for more details and important information on limitations to these systems.*

### ANTI-LOCK BRAKE SYSTEM (ABS)

Toyota's ABS sensors detect which wheels are locking up and limits wheel lockup by "pulsing" each wheel's brakes independently. Pulsing releases brake pressure repeatedly for fractions of a second. This helps the tires attain the traction that current road conditions will allow, helping you to stay in directional control.

### BRAKE ASSIST (BA)

Brake Assist is designed to detect sudden or "panic" braking, and then add braking pressure to help decrease the vehicle's stopping distance. When there's only a split second to react, Brake Assist can add additional brake pressure more quickly than just the driver alone can.

### ELECTRONIC BRAKE FORCE DISTRIBUTION (EBD)

Toyota's ABS technology has Electronic Brake-force Distribution (EBD) to help maintain control and balance when braking. Abrupt stops can cause a vehicle to tilt forward, reducing the braking power of the rear wheels. EBD responds to sudden stops by redistributing brake force to enhance the braking effectiveness of all four wheels.

### SMART STOP TECHNOLOGY (SST)

Smart Stop Technology automatically reduces engine power when the accelerator and brake pedals are pressed simultaneously under certain conditions.

SST engages when the accelerator is depressed first and the brakes are applied firmly for longer than one-half second at speeds greater than five miles per hour.

SST doesn't engage if the brake pedal is depressed before the accelerator pedal, allowing vehicles to start on a steep hill and safely accelerate without rolling backward.

### VEHICLE STABILITY CONTROL (VSC)

VSC helps prevent loss of traction during cornering by reducing engine power and applying brake force to selected wheels.

Toyota's VSC monitors steering angle and the direction your vehicle is traveling. When it senses that the front or rear wheels begin to lose traction, VSC reduces engine power and applies braking to selected wheels. This helps restore traction and vehicle control.



## TRACTION CONTROL (TRAC)

VSC helps prevent loss of traction during cornering by reducing engine power, and Traction Control helps maintain traction on loose gravel and wet, icy, or uneven surfaces by applying brake force to the spinning wheel(s).

Toyota's TRAC sensors are activated when one of the drive wheels starts to slip. TRAC limits engine output and applies the brakes to the spinning wheel. This transfers power to the wheels that still have traction to help keep you on track.

## Floor mat installation

There are two types of Toyota floor mats: carpeted and all-weather. Each vehicle has model-specific floor mats. Installation is easy.

To keep your floor mat properly positioned, follow these steps:

- Only use Toyota floor mats designed for your specific model.
- Use only one floor mat at a time, using the retaining hooks to keep the mat in place.
- Install floor mats right side up.

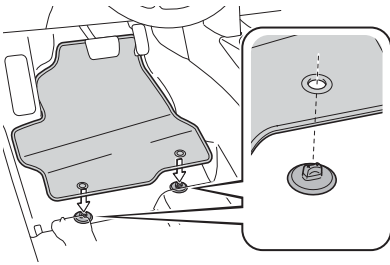

Always align the  $\Delta$  marks

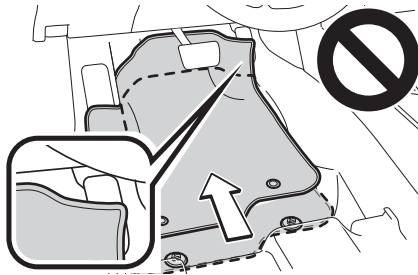
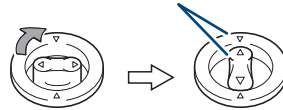

# **BLUETOOTH® DEVICE PAIRING SECTION**

Do not attempt the Bluetooth® Pairing process while driving.

To begin the Bluetooth® Pairing process, press the HOME button on the faceplate of your Toyota Vehicle Entune™ Multimedia Head Unit.<sup>1</sup>

## Bluetooth® Pairing for Android phone and Entune™ touch screen system

Pairing your phone is the first step in connecting with your Toyota for hands-free calling and for audio streaming via Bluetooth. This pairing process is quick and easy: all Android mobile digital devices have Bluetooth integrated; all you have to do is setup the phone and multimedia system to “talk” to each other and form a connection.<sup>2</sup>

### Initiate Bluetooth® on your Android®

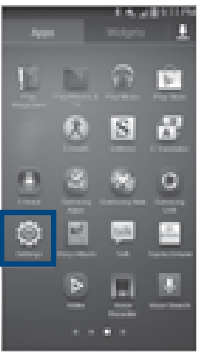

**STEP 1**  
From your **APPS SCREEN**, select **SETTINGS**.

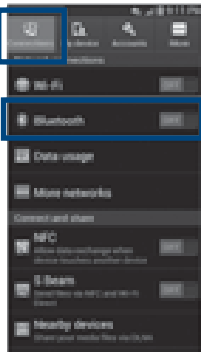

**STEP 2**  
Select **CONNECTIONS** and select **BLUETOOTH**.

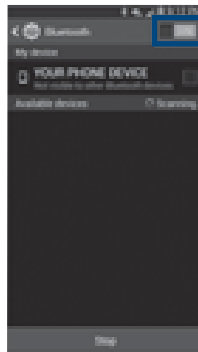

**STEP 3**  
Ensure **BLUETOOTH** is **ON**.



**STEP 4**  
Select **YOUR PHONE DEVICE** to make it discoverable.

*Phone will seek out Bluetooth devices while remaining discoverable.*



**STEP 5**  
While your Android device is seeking out Bluetooth devices, proceed to your Entune Multimedia Head Unit on your Toyota vehicle.

<sup>1</sup> To determine which head unit is installed in your vehicle, refer to the Audio section in this guide. Entune™ Premium Audio screens are shown in this section. Screens and features may vary by Entune™ system.

<sup>2</sup> Some Android devices may have slightly different SETTINGS screen layout depending on manufacturer of device and Android OS version.

# BLUETOOTH® DEVICE PAIRING

## Initiate Bluetooth® on your Entune™ Multimedia Head Unit

Once you have Bluetooth enabled on your phone and ready to pair, you will need to initiate Bluetooth on your Entune head unit. Please follow the instructions below to pair your Bluetooth enabled phone to your Entune system.

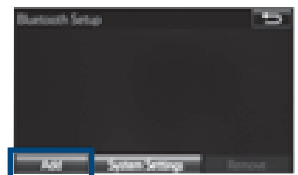
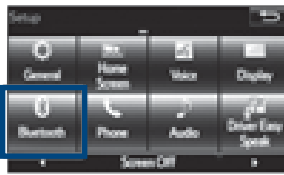

### STEP 6

On your Toyota Vehicle Entune Multimedia Head Unit, Select **SETUP BUTTON** on the Home Screen.

### STEP 7

Select **BLUETOOTH**.  
*Image shown is a sample image, features may vary.*

### STEP 8

Select **ADD**, to add your phone device.

For Entune™ Audio System, press the **SETUP BUTTON** on the faceplate to access the Setup Screen.

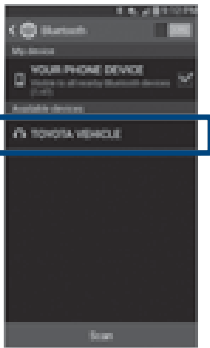

### STEP 9

Back on your smartphone, you can now select your **TOYOTA VEHICLE** in Bluetooth Settings.



### STEP 10

Your smartphone is now paired with Entune.



### STEP 11

Once paired, Entune will attempt to connect audio and contacts on your phone.

*You may need to enter the provided Bluetooth PIN on your phone.*

## Initiate Bluetooth® on your Entune™ Multimedia Head Unit

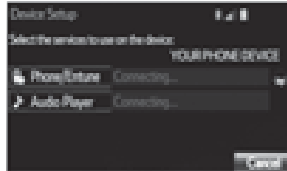

### STEP 12

Using your smartphone, you will need to allow Entune access to your messaging and contacts.

*It is recommended to check the “Don't ask again” box, so as not to have to press OK every time the phone makes a Bluetooth connection with your Toyota.*

### STEP 13

A confirmation will appear once your phone has been paired and connected.

#### Additional Resources

If you're having trouble pairing your phone, Toyota has you covered. You can get more information from the following sources:

Online Pairing Guide:  
[www.toyota.com/connect](http://www.toyota.com/connect)

Your Toyota Owner's Manual  
Located in the vehicle glovebox

Toyota Customer  
Experience Center  
(800) 331-4331

#### Disclosures

This brochure is accurate at the time of print; content subject to change based on periodic multimedia software updates.

1. Concentrating on the road should always be your first priority while driving. Do not use the hands-free phone system if it will distract you.
2. The Bluetooth word mark and logos are registered trademarks owned by Bluetooth SIG, Inc. and any use of such marks by Toyota is under license. A compatible Bluetooth enabled phone must first be paired. Phone performance depends on software, coverage & carrier.
3. Android is a trademark of Google Inc.
4. Apps/services vary by phone/carrier; functionality depends on many factors. Select apps use large amounts of data; you are responsible for charges. Apps & services subject to change. See [Toyota.com/entune](http://Toyota.com/entune) for details.

## Bluetooth® Pairing for iPhone and Entune™ touch screen system

**\*\*Do not attempt the Bluetooth® Pairing process while driving.\*\***

Pairing your phone is the first step in connecting with your Toyota for hands-free calling and for audio streaming via Bluetooth. This pairing process is quick and easy: all iPhone mobile digital devices have Bluetooth integrated; all you have to do is setup the phone and multimedia system to “talk” to each other and form a connection.

### Initiate Bluetooth® on your iPhone®



#### STEP 1

From the **HOME SCREEN**, select **SETTINGS**.

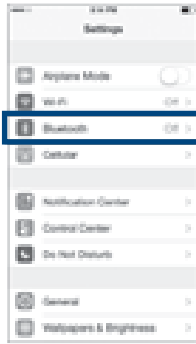

#### STEP 2

Select **BLUETOOTH**.



#### STEP 3

Ensure **BLUETOOTH** is **ON**.



#### STEP 4

Your iPhone will seek out Bluetooth devices while remaining discoverable.



#### STEP 5

While your iPhone device is seeking out Bluetooth devices, proceed to your Entune Multimedia Head Unit on your Toyota vehicle.

## Initiate Bluetooth® on your Entune™ Multimedia Head Unit

Once you have Bluetooth enabled on your phone and ready to pair, you will need to initiate Bluetooth on your Entune head unit. Please follow the instructions below to pair your Bluetooth enabled phone to your Entune system.



### STEP 6

On your Toyota Vehicle Entune Multimedia Head Unit, Select **SETUP BUTTON** on the Home Screen.

For Entune™ Audio System, press the **SETUP BUTTON** on the faceplate to access the Setup Screen.

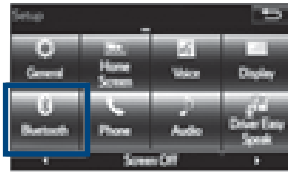

### STEP 7

Select **BLUETOOTH**.

*Image shown is a sample image, features may vary.*



### STEP 8

Select **ADD**, to add your phone device.



### STEP 9

Back on your smartphone, you can now select your **TOYOTA VEHICLE** in Bluetooth Settings.

*You may need to enter the provided Bluetooth PIN on your phone.*



### STEP 10

Your smartphone is now paired with Entune.

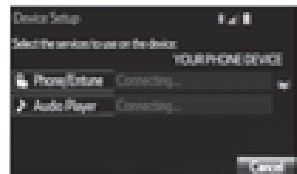

### STEP 11

Once paired, Entune will attempt to connect audio and contacts on your phone.

# BLUETOOTH® DEVICE PAIRING

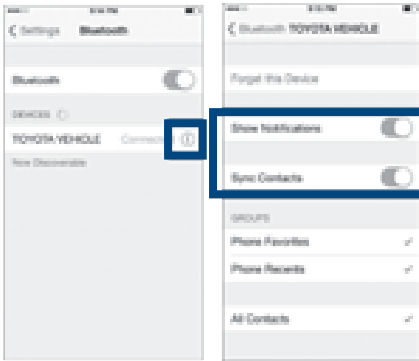

## STEP 12

Using your smartphone, you may need to allow Entune access to your messaging and contacts.

*Only current iPhone text messages can be viewed on the head unit. iPhone does not allow text message reply.*

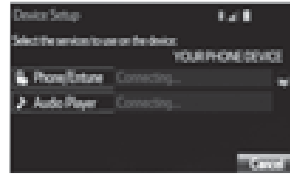

## STEP 13

A confirmation will appear once your phone has been paired and connected.

### Additional Resources

If you're having trouble pairing your phone, Toyota has you covered. You can get more information from the following sources:

Online Pairing Guide:  
[www.toyota.com/connect](http://www.toyota.com/connect)

Your Toyota Owner's Manual  
Located in the vehicle glovebox

Toyota Customer  
Experience Center  
(800) 331-4331

### Disclosures

This brochure is accurate at the time of print; content subject to change based on periodic multimedia software updates.

1. Concentrating on the road should always be your first priority while driving. Do not use the hands-free phone system if it will distract you.
2. The Bluetooth word mark and logos are registered trademarks owned by Bluetooth SIG, Inc. and any use of such marks by Toyota is under license. A compatible Bluetooth enabled phone must first be paired. Phone performance depends on software, coverage & carrier.
3. Android is a trademark of Google Inc.
4. Apps/services vary by phone/carrier; functionality depends on many factors. Select apps use large amounts of data; you are responsible for charges. Apps & services subject to change. See [Toyota.com/entune](http://Toyota.com/entune) for details.



## Bluetooth® Pairing for Windows Phone and Entune™ touch screen system

**\*\*Do not attempt the Bluetooth® Pairing process while driving.\*\***

Pairing your phone is the first step in connecting with your Toyota for hands-free calling and for audio streaming via Bluetooth. This pairing process is quick and easy: all Windows Phone mobile digital devices have Bluetooth integrated; all you have to do is setup the phone and multimedia system to “talk” to each other and form a connection.

### Initiate Bluetooth® on your Windows Phone®

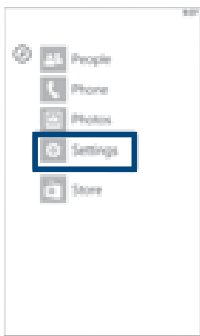

#### STEP 1

From your APP LIST, select **SETTINGS**.

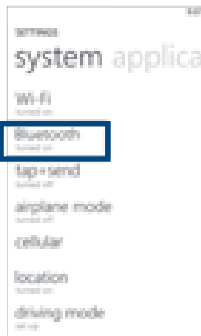

#### STEP 2

Select **BLUETOOTH**.

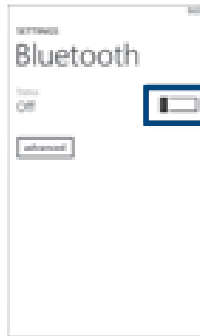

#### STEP 3

Ensure **BLUETOOTH** is **ON**.



#### STEP 4

Phone will seek out Bluetooth devices while remaining discoverable.



#### STEP 5

While your iPhone device is seeking out Bluetooth devices, proceed to your Entune Multimedia Head Unit on your Toyota vehicle.

# BLUETOOTH® DEVICE PAIRING

## Initiate Bluetooth® on your Entune™ Multimedia Head Unit

Once you have Bluetooth® enabled on your phone and ready to pair, you will need to initiate Bluetooth® on your Entune head unit. Please follow the instructions below to pair your Bluetooth enabled phone to your Entune system.



### STEP 6

On your Toyota Vehicle Entune Multimedia Head Unit, Select **SETUP BUTTON** on the Home Screen.

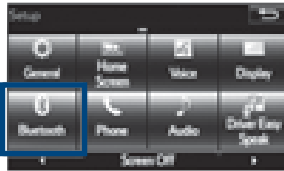

### STEP 7

Select **BLUETOOTH**.

*Image shown is a sample image, features may vary.*

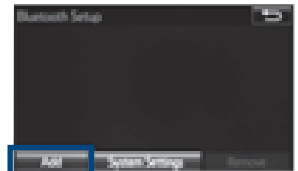

### STEP 8

Select **ADD**, to add your phone device.

For Entune™ Audio System, press the **SETUP BUTTON** on the faceplate to access the Setup Screen.

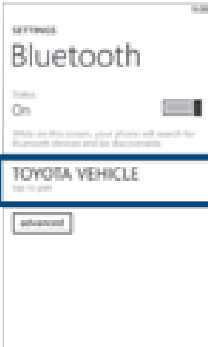

### STEP 9

Back on your smartphone, you can now select your **TOYOTA VEHICLE** in Bluetooth Settings.

*You may need to enter the provided Bluetooth PIN on your phone.*



### STEP 10

Your smartphone is now paired with Entune.

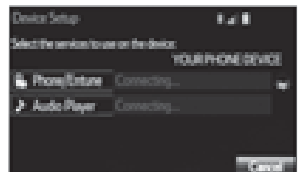

### STEP 11

Once paired, Entune will attempt to connect audio and contacts on your phone.

## Initiate Bluetooth® on your Entune™ Multimedia Head Unit

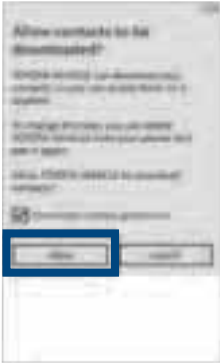

### STEP 12

Using your smartphone, you may need to allow Entune access to your contacts.



### STEP 13

A confirmation will appear that your phone has been paired and connected.

#### Additional Resources

If you're having trouble pairing your phone, Toyota has you covered. You can get more information from the following sources:

Online Pairing Guide:  
[www.toyota.com/connect](http://www.toyota.com/connect)

Your Toyota Owner's Manual  
Located in the vehicle glovebox

Toyota Customer  
Experience Center  
(800) 331-4331

#### Disclosures

This brochure is accurate at the time of print; content subject to change based on periodic multimedia software updates.

1. Concentrating on the road should always be your first priority while driving. Do not use the hands-free phone system if it will distract you.
2. The Bluetooth word mark and logos are registered trademarks owned by Bluetooth SIG, Inc. and any use of such marks by Toyota is under license. A compatible Bluetooth enabled phone must first be paired. Phone performance depends on software, coverage & carrier.
3. Android is a trademark of Google Inc.
4. Apps/services vary by phone/carrier; functionality depends on many factors. Select apps use large amounts of data; you are responsible for charges. Apps & services subject to change. See [Toyota.com/entune](http://Toyota.com/entune) for details.



[www.toyota.com/owners](http://www.toyota.com/owners)

CUSTOMER EXPERIENCE CENTER

1-800-331-4331

