

# PLASTIC HOSE BARB STYLES

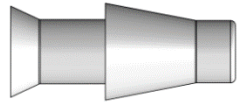

## STANDARD

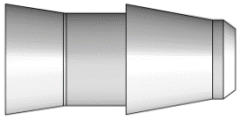

## HIGH PRESSURE

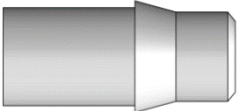

## EASY ASSEMBLY

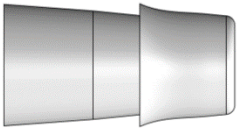

## FULL RANGE

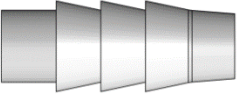

## LARGE MULTI-BARB

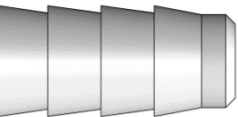

## SMALL MULTI-BARB

**Industrial Specialties Mfg.** has one of the world's largest selections of plastic barb fittings. With such a wide choice in barb styles and configurations, Industrial Specialties Mfg. is the best source for finding a plastic barb fitting for your specific application.

The **Standard Barb Style** is characterized by a longer barb that extends the sealing surface of the fitting. Tubing is expanded from 42% to 69% above its nominal ID.

The **High Pressure Barb Style** offers outstanding performance characteristics when used with flexible tubing. Tubing is expanded by 50% above its nominal ID permitting high-pressure capabilities.

The **Easy Assembly Barb Style** provides easy assembly while maintaining excellent pressure and tensile capabilities. The tubing is expanded to 25% above its nominal ID.

The **Full Range Barb Style** is designed to accommodate a range of tube sizes and tube types. Consideration should be given to flow restriction, pressure capability and the force required for assembly of the tube. No parting lines are present on these single barb styles.

The **Multi-Barb Style** is featured with 2 or more barbed ridges providing more contact with the tubing.

The **Small Multi-Barb Style** does not have a molded parting line on the first barb. This prevents the part from leaking.

[Learn more about hose barbs, hose barbed fittings and hose barb design.](#)



**Industrial Specialties Mfg. and IS Med Specialties**

*End your search, simplify your supply chain*  
ISO 9001:2015 Certified Companies

4091 S. Eliot St., Englewood, CO 80110-4396

Phone 303-781-8486 | Fax 303-761-7939

industrialspec.com | ismedspec.com

© Copyright 2022 Industrial Specialties Mfg.