

# HONEY BADGER®

## PERSONAL OFFENSIVE WEAPON

### SPECS

MODEL:	HONEY BADGER-SD	HONEY BADGER SBR	HONEY BADGER PISTOL
CALIBER:	300 BLK	300 BLK	300 BLK
BARREL:	7 in, 1.5 TWIST	7 in, 1.5 TWIST	7 in, 1.5 TWIST
GAS SYSTEM :	PISTOL LENGTH	PISTOL LENGTH	PISTOL LENGTH
MUZZLE:	HB Ti SILENCER	5/8-24 CHERRY BOMB	5/8-24 CHERRY BOMB
LENGTH :	26.75 - 31.75 in	20 - 24.75 in	20.75 - 25.5 in
WEIGHT:	5.4 lbs	4.8 lbs	4.9 lbs
TRIGGER:	2-STAGE	2-STAGE	2-STAGE

### LAWYER SHIT

⚠ BEFORE USING THIS FIREARM: BE CERTAIN YOU HAVE READ AND UNDERSTAND THE MANUAL AND THE ACCOMPANYING "FINE PRINT" SHEET. FAILURE TO DO SO CAN RESULT IN PROPERTY DAMAGE, SERIOUS INJURY AND/OR DEATH. USE EXTREME CARE AND CAUTION WHEN HANDLING ANY FIREARM.

⚠ DO NOT FIRE ANY CARTRIDGE OTHER THAN THE ONE MARKED ON THE BARREL OR UPPER RECEIVER OF THIS FIREARM.

⚠ ONLY USE SAAMI / C.I.P. APPROVED AMMUNITION THAT MATCHES THE CHAMBER OF THIS FIREARM.

### STATE FIREARM LAWS

⚠ A Q ONLY SHIPS TO STATES THAT ARE COMPLIANT WITH OUR PRODUCTS. WITH THAT SAID, SOME STATES ARE LESS AWESOME THAN OTHERS.

⚠ PLEASE REVIEW AND FULLY UNDERSTAND YOUR LOCAL, STATE, AND FEDERAL LAWS AND REGULATIONS BEFORE USING THIS FIREARM. WE ENCOURAGE YOU TO DO YOUR HOMEWORK AND USE YOUR FIREARMS IN ACCORDANCE WITH THE LAW.

For information about firearm laws in your state, visit [www.nrila.org/gun-laws/state-gun-laws](http://www.nrila.org/gun-laws/state-gun-laws)

### FIREARM SAFETY 101

1. Treat every firearm as if it were loaded.

2. Always point your firearm in a safe direction.

⚠ A SAFE DIRECTION MEANS ZERO INJURY TO YOURSELF AND OTHERS, AND THE LEAST AMOUNT OF PROPERTY DAMAGE WILL OCCUR IF THE FIREARM WERE TO BE DISCHARGED.

3. Keep your finger off the trigger until you are on target and ready to fire.

4. Keep the safety in the "safe" position until you intend to fire. 

5. Be aware of what is between you and your target, and what lies beyond your target.

6. If any of these safety rules do not make sense to you, please stop and seek professional help from a qualified firearms instructor.

### WHAT'S IN THE BOX?

1. HONEY BADGER

2. AR15 PATTERN MAGAZINE (1)

3. .05 INCH HEX KEY

4. 5/64 INCH HEX KEY

5. LOCKING DEVICE

6. OPERATORS MANUAL

7. THE FINE PRINT (WARRANTY CARD)

Here's some helpful nomenclature to know when reading this manual or other related documents / watching instructional videos via the dark web about how to train like an operator.

- |                           |                              |
|---------------------------|------------------------------|
| 1. SILENCER               | 11. TRIGGER & TRIGGER GUARD  |
| 2. BARREL / MUZZLE DEVICE | 12. SAFETY SELECTOR          |
| 3. HANDGUARD              | 13. GRIP                     |
| 4. HANDGUARD TURNBUCKLE   | 14. EJECTION PORT & COVER    |
| 5. UPPER RECEIVER         | 15. MAGAZINE RELEASE BUTTON  |
| 6. TAKEDOWN PIN           | 16. STOCK RELEASE BUTTON     |
| 7. PIVOT PIN              | 17. CHARGING HANDLE          |
| 8. MAGAZINE               | 18. QD SLING CUP             |
| 9. LOWER RECEIVER         | 19. COLLAPASIBLE STOCK       |
| 10. BOLT CATCH & RELEASE  | 20. PISTOL STABILIZING BRACE |

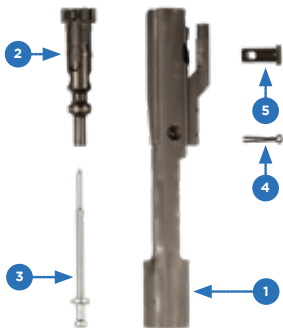

- |                             |
|-----------------------------|
| 1. BOLT CARRIER             |
| 2. BOLT ASSEMBLY            |
| 3. FIRING PIN               |
| 4. FIRING PIN RETAINING PIN |

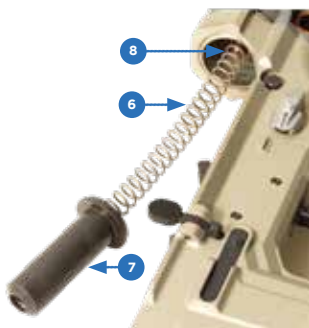

- |                            |
|----------------------------|
| 5. CAM PIN                 |
| 6. ACTION SPRING           |
| 7. ACTION SPRING SEAT      |
| 8. ACTION SPRING GUIDE ROD |



1. The HONEY BADGER is equipped with an ambidextrous fire control safety selector.
2. There are two (2) safety selector positions.

**SAFE:** The selector lever is parallel to the bore and mechanically blocks the trigger.

**FIRE:** The selector lever is NOT parallel to the bore.

3. To operate the safety, simply rotate it to the desired position as indicated on the receiver.

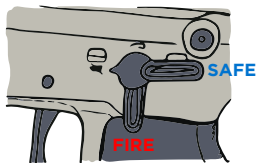

### ▲ MAKE SURE THE FIREARM IS UNLOADED

1. Place the safety selector in the safe position.
2. Press the magazine release button and remove the magazine from the firearm.
3. Lock the bolt open by pulling the charging handle to the rear while holding down the bolt catch button.
4. Perform a visual and physical inspection of the chamber to ensure it is clear of any live cartridges, spent cases or other obstructions.
5. With the bolt locked to the rear, feed the opened cable lock through the ejection port window and down into the magazine well.
6. Connect both ends and lock the device. Give it a tug to make sure it is locked.
7. Gently close the bolt to the rear by pulling the charging handle until the bolt disengages from the bolt catch and slowly let it forward.

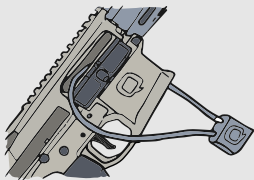

▲ STORE THE CABLE LOCK KEYS IN A SAFE PLACE INACCESSIBLE TO CHILDREN, YOUR SIGNIFICANT OTHER, OR ANYONE ELSE WHO (WHOM?) YOU DON'T WANT PUTTING THEIR GRUBBY HANDS ON YOUR HONEY BADGER.

▲ ALWAYS WEAR PROTECTIVE EQUIPMENT WHEN HANDLING A FIREARM. THIS INCLUDES EYE PROTECTION, HEARING PROTECTION (EITHER ATTACHED TO THE MUZZLE OR YOUR HEAD), GLOVES IF NECESSARY, AND AS ALWAYS, USE COMMON SENSE.

▲ ONLY USE FACTORY CERTIFIED SAAMI / C.I.P. AMMUNITION THAT MATCHES THE CHAMBER OF THIS FIREARM.

1. Point the muzzle in a safe direction.
2. Place the safety selector in the safe position.
3. Lock the bolt open by pulling the charging handle to the rear while also holding down the bolt catch button.
4. Ensure the firearm is clear of any obstructions by visually and physically inspecting the barrel's chamber, the magazine well, and the bolt face.

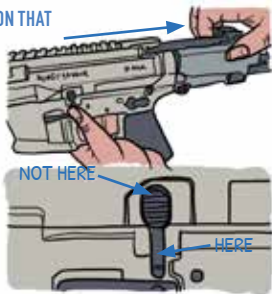

5. Insert a loaded magazine into the magazine well until fully seated. Pull down on the magazine to ensure that it is properly engaged on the magazine catch.
6. Push the bolt release button to strip the top cartridge off the magazine, feeding it into the chamber.
7. Identify your target first with your eyes, and then through your sights or optic.
8. Once your intended target is identified, rotate the safety selector to the fire position.
9. Slowly pull the trigger to the rear while maintaining your optic on target.

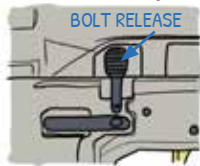

▲ BY NOW YOU MAY HAVE NOTICED THE HONEY BADGER SHIPS WITH A WICKED AWESOME 2-STAGE TRIGGER.

10. Once you've finished shooting, place the safety selector back to the safe position.

1. Point the muzzle in a safe direction.
2. Ensure the safety selector is in the safe position.
3. Press the magazine release button and remove the magazine.

▲ IF YOU EXPELLED ALL AMMUNITION FROM YOUR MAGAZINE, THE BOLT SHOULD ALREADY BE LOCKED TO THE REAR. SKIP TO STEP #5.

4. Lock the bolt to the rear by pulling the charging handle to the rear while holding down the bolt catch button.
5. Ensure the firearm is unloaded by visually and physically inspecting the barrel's chamber, the magazine well, and the bolt face.
6. Release the bolt by pressing the bolt release button or by pulling the charging handle back and releasing it at its most rearward position.

▲ IF YOUR RIFLE REQUIRES MORE OR LESS GAS TO PROPERLY CYCLE (EXTRACT, EJECT AND FEED THE NEXT CARTRIDGE), SKIP AHEAD FOR GAS BLOCK ADJUSTMENT INSTRUCTIONS.

▲ IN CASE YOU HAVEN'T FIGURED THIS OUT BY NOW, THIS IS A GOOD TIME TO PERFORM YOUR VISUAL AND PHYSICAL INSPECTION OF THE CHAMBER BEFORE TAKING YOUR FIREARM APART.

1. Extend the stock / brace by pulling it to the rear while pressing the stock release button.

[awkward blank space]

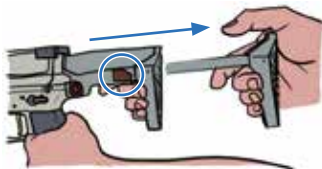

2. make sure the bolt is closed.
3. Push the pivot and takedown pins from left to right to disengage the upper receiver from the lower receiver.
4. Lift the upper receiver off of the lower receiver.

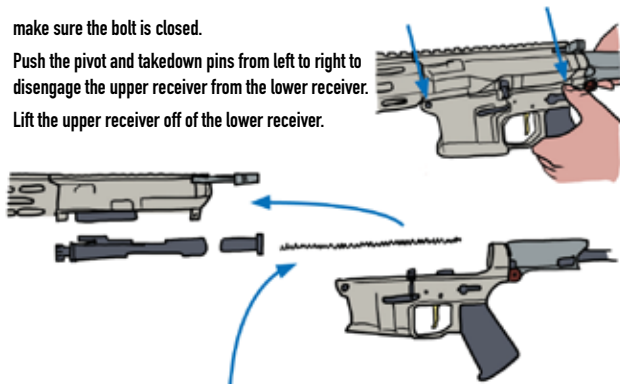

THE HONEY BADGER HAS A PROPRIETARY RECOIL SYSTEM, AND THE SPRING IS NOT RETAINED INSIDE THE RECEIVER EXTENSION TUBE LIKE A TRADITIONAL STONER DESIGN. DON'T BE ALARMED IF THE SPRING POPS OUT.

5. With the receivers apart, remove the action spring, the spring seat, and the bolt carrier group.



6. To field strip the bolt carrier group, remove the firing pin retaining pin from the bolt carrier.
7. Remove the firing pin through the rear of the bolt carrier.
8. To remove the cam pin, rotate the cam pin 90° to clear the gas key. Once clear, rotate the cam pin and pull it up and out of the bolt carrier.
9. Finally, remove the bolt from the bolt carrier.



## BARREL

1. Using your favorite copper solvent, clean your bore with an appropriately sized patch and copper or nylon bore brush for your specific caliber.
2. Clean your chamber with an appropriately sized chamber brush and mop.

## BOLT CARRIER GROUP

1. Wipe down all exterior surfaces with a rag and your preferred firearm specific cleaning oil.
  - ▲ IF NECESSARY, USE A BRUSH OR A CARBON SCRAPER TO REMOVE ANY BUILT UP CRUD.
2. Lubricate all bearing surfaces to include the bolt, bolt carrier, and cam pin.

## RECEIVERS

1. Wipe down all interior surfaces of the upper and lower receiver with a rag and your preferred firearm specific cleaning oil.
2. If compressed air is available, air out the trigger pocket area of the lower receiver to remove any unburnt powder, or other particles that may have entered the lower receiver.
  - ▲ SINCE THE HONEY BADGER DOESN'T USE A TRADITIONAL RECOIL SYSTEM, IT'S NOT AS CRITICAL TO CLEAN AND LUBRICATE INSIDE THE RECEIVER EXTENSION TUBE.
3. Lubricate all bearing surfaces inside the upper receiver, including the charging handle channel.

1. Insert the bolt into the front of the bolt carrier.
2. Insert the cam pin into the corresponding hole in the bolt carrier and rotate it 90° once it clears the gas tube.



3. With the cam pin installed and properly seated, insert the firing pin through the rear of the bolt carrier, penetrating the rear (there's a joke here somewhere...) of the bolt and through the cam pin until it is fully seated.
4. Insert the firing pin retaining pin into the corresponding hole on the side of the bolt carrier.

▲ MAKE SURE THE FIRING PIN IS PUSHED ALL THE WAY IN TO ENSURE THE RETAINING PIN SITS BEHIND THE LARGE SHOULDER OF THE FIRING PIN.

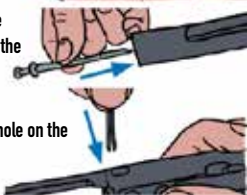

5. Install the charging handle into the upper receiver by aligning the charging handle key feature with the notches in the upper receiver's charging handle channel.

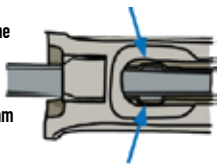

6. Pull the bolt forward within the bolt carrier group to bring the cam pin under the bolt carrier's gas key.

7. Insert the bolt carrier group into the rear of the receiver ensuring the gas key is riding within the underside of the charging handle.



8. Push both the charging handle and bolt carrier group forward until the bolt enters, rotates and locks into the barrel's chamber.

9. Insert the action spring seat into the rear of the bolt carrier.

10. For good measure, close the ejection port cover.

11. Insert the action spring into the lower receiver's extension tube and ensure the spring is riding on the action spring guide rod.

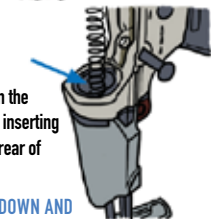

▲ **HERE COMES THE FUN PART...**

12. Holding the lower receiver in one hand and the upper receiver in the other, begin to mate the receivers together while simultaneously inserting the exposed end of the action spring into the spring seat at the rear of the carrier.

▲ **PRO TIP: IT'S HELPFUL IF YOU KEEP THE MUZZLE POINTING DOWN AND RESTING ON A BENCH TOP.**

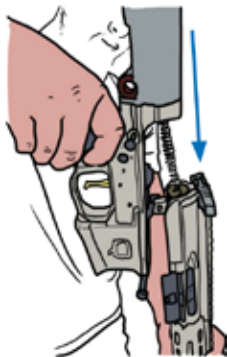
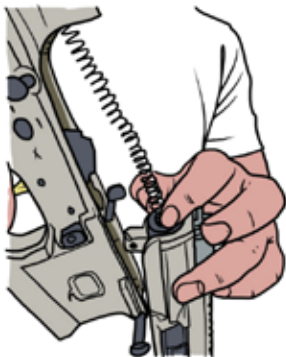

13. Continue guiding the spring into place until the receivers are together.

14. Lock the receivers together by engaging the pivot and takedown pins.

▲ **YOU SEE? I TOLD YOU THAT WAS THE FUN PART...**



### ▲ NOW, LET'S SEE IF YOU PUT IT BACK TOGETHER CORRECTLY...

1. Lock the bolt open by pulling the charging handle to the rear while pressing the bolt catch button.
2. Perform a visual and physical inspection of the firearm before performing a function check to ensure the firearm is unloaded and safe.
3. Release the bolt by pressing the bolt release button or by pulling the charging handle back and releasing it from its most rearward position.
4. Rotate the safety selector lever to the fire position.
5. With the rifle pointed in a safe direction, pull the trigger until the hammer is released from the sear. If all goes well, you will hear and feel the hammer striker the firing pin.
6. Continue to hold the trigger to the rear while pulling back the charging handle to cock the hammer. Release the charging handle from its most rearward position.
7. With the hammer re-cocked, slowly release the trigger. You should hear and feel the mechanical click of the trigger resetting.
8. Place the safety selector in the safe position, and attempt to pull the trigger.
9. If all goes well, you will hear and feel nothing.

▲ CONGRATULATIONS! I DIDN'T DOUBT YOU FOR A SECOND... NOW GO GET YOURSELF A FROSTY BEVERAGE. YOU'VE EARNED IT.

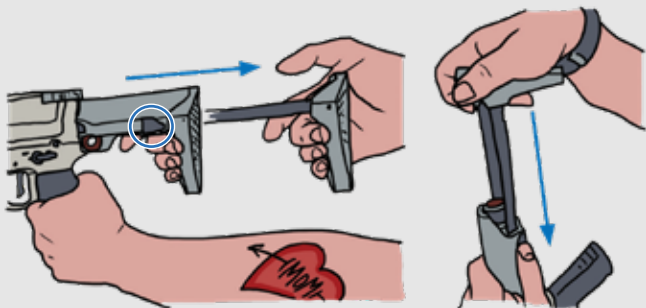

1. To extend the stock or brace, pull it to the rear while pressing the stock button with your thumb on the left side of the firearm until it locks in the extended position. If you don't have a thumb, ask a friend for help.
2. To collapse it, press the stock release button and push the stock or brace in with your other hand until it locks in the collapsed position. If you don't have another hand... nevermind.

The HONEY BADGER comes with an adjustable gas block to ensure the rifle performs optimally with the wide variety of ammunition available on today's market. As shipped, it may need to be adjusted for your specific ammo of choice.

**▲ SUBSONIC 300 BLK IS NOT INTENDED TO BE USED WITHOUT A SILENCER. NO AMOUNT OF GAS BLOCK ADJUSTMENT WILL MAKE THIS WORK RELIABLY. IF YOU INTEND TO SHOOT SUBSONIC 300 BLK WITHOUT A SILENCER, MAY GOD HAVE MERCY ON YOUR SOUL.**

**▲ THIS GAS BLOCK IS NOT INTENDED TO BE ADJUSTED "ON THE FLY". WHILE YOU MAY FIND A HAPPY MEDIUM SETTING FOR SUBSONIC AND SUPERSONIC AMMUNITION, WE HIGHLY ENCOURAGE DIALING IT IN FOR ONE SPECIFIC CARTRIDGE LOAD FOR OPTIMAL PERFORMANCE.**

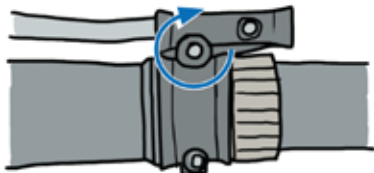

**RIGHT TIGHTY = DECREASE GAS FLOW**

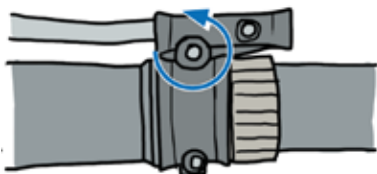

**LEFTY LOOSEY = INCREASE GAS FLOW**

1. Using a 5/64-inch hex key, loosen and remove the adjustment screw jam nut.
2. Using a .05-inch hex key, rotate the adjustment screw to increase or decrease the gas flow.

**▲ REINSTALL THE GAS BLOCK ADJUSTMENT SCREW JAM NUT BEFORE TEST FIRING TO PREVENT THE ADJUSTMENT SCREW FROM MOVING.**

3. Once your adjustment is made, tighten the adjustment screw jam nut. Screw it in until it is snug against the adjustment screw. Once snug, rotate it 1/4 turn more.

**▲ NEWER HONEY BADGERS HAVE A WINDOW ON THE HANDGUARD TO ACCESS THE GAS BLOCK. IF YOU HAVE AN OLDER HONEY BADGER (EARLY 2019-ISH), YOU MAY HAVE TO REMOVE YOUR HANDGUARD AND SILENCER TO ADJUST THE GAS BLOCK. MISTAKES WERE MADE...**

## WHEN TO INCREASE GAS

1. **Failure to EXTRACT:** This happens when there is not enough gas to unlock the bolt and drive the bolt carrier to the rear, failing to extract the spent case from the chamber. If your extractor is broken, chances are good you will experience a "double feed", and gas block adjustment is the least of your worries...
2. **Weak EJECTION:** Your rifle has enough gas to unlock and extract the empty case, but not quite enough to send the bolt carrier group all the way to the rear. This causes the spent case to miss the brass deflector all together and eject rear of the 5 o'clock position (assuming the ejection port is 3 o'clock).
3. **Failure to FEED (AKA Short Stroke, which happens to be my highschool nickname):** Your firearm has enough gas to unlock and eject the spent case, but not enough to feed the next cartridge in the magazine. This may cause the bolt to close on an empty chamber, or it may cause the bolt to pick up the next cartridge mid-case.
4. **Failure to LOCK:** The bolt does not lock to the rear on the bolt catch. Keep in mind that the bolt can also lock open on the magazine follower, and this does not constitute as proper lock back.

## WHEN TO DECREASE GAS

1. **Failure to EJECT (AKA Stove Pipe, which happens to be my other highschool nickname):** The rifle is over functioning, and the bolt carrier group is returning forward before the spent case can properly eject.

### ▲ FAILURE TO EJECT CAN ALSO OCCUR DUE TO UNDER FUNCTION / WEAK EJECTION.

2. **Forward / Erratic Ejection:** The case is ejecting without failure, but the ejection pattern is forward of the ejection port or ejecting in an inconsistent pattern.
3. **Failure to FEED (Bolt-Override):** The bolt carrier group is cycling too fast and the magazine can't keep up. Either the bolt picks up the next cartridge mid-case, or the cartridge is missed all together and the bolt closes on an empty chamber.

### ▲ AS MENTIONED ABOVE, THIS MALFUNCTION CAN ALSO OCCUR FROM BEING UNDER-GASSED. IN AN OVER-GASSED SCENERIO, THIS IS MORE LIKELY DUE TO A DIRTY OR FAILING MAGAZINE. TEST MULTIPLE MAGAZINES BEFORE INCREASING GAS FOR THIS TYPE OF FAILURE TO FEED.

4. **Failure to CHAMBER:** The feeding cartridge hits the feed ramp to fast and stops high on the face of the chamber OR the cartridge enters the chamber but doesn't fully seat due to cartridge deformation.

The HONEY BADGER was originally designed at the request of US SOCOM as a replacement system for the MP5-SD. Developed in conjunction with the 300 BLK cartridge, the intent was to fill the traditional submachine gun role with the capability of a rifle caliber platform. The HONEY BADGER exceeded all requirements by being lighter, shorter, quieter, more reliable, and more accurate and powerful at greater distances than its 9mm predecessor.

The HONEY BADGER is built in the USA and finished to mil-spec standards as originally designed. With a market cluttered with HONEY BADGER inspired bootlegs and hack-job wannabe's, be proud that you own real deal.



# UNPOSSIBLE

MADE PROUDLY IN NEW HAMPSHIRE / [www.liveQordie.com](http://www.liveQordie.com)



THESE GUYS WILL BUILD IT RIGHT. IF YOU GOT ANY ISSUES, LET ME KNOW AND I'LL WHIP THOSE PECKER-HEADS INTO SHAPE.

- KEN

Reach me at [KEN@KEVINWASANACCIDENT.COM](mailto:KEN@KEVINWASANACCIDENT.COM)

FOR WARRANTY INFORMATION, PLEASE REFER TO THE ACCOMPANIED "FINE PRINT" CARD.