



The World's Finest Triggers®

TRIGGER INSTALLATION INSTRUCTIONS

Thank you for purchasing this Timney Trigger. It has been designed and manufactured to provide you with a lifetime of dependable service. Each trigger is hand tested and calibrated on a rifle action before leaving our factory. Please read these instructions **fully** before you begin installing the trigger, you'll be glad you did.

Installation Instructions

1. Before beginning work on any firearm, remove the ammunition source and double check to ensure the chamber is empty.
2. To install the Ruger Rimfire Precision trigger the following tools are required:
 - 1/8" Allen key.
 - 5/64" Allen-key
 - Small screwdriver
3. Remove the Chassis Coring Cover.
4. To remove the bolt, press the bolt stop and pull back the bolt simultaneously.
5. Remove the 2 action screws on the bottom with a 1/8" hex key and with the safety selector on safe lift the barreled-action out of the stock to gain access to the stock trigger.
6. Release the cocking guide spring by depressing the pin and allowing it to move into the long portion of the "J" shaped slot.
7. Push in the cocking piece guide and slide the factory trigger assembly back and out.
8. Remove the cocking guide, cocking guide spring and plunger and install these components into your new Timney Ruger Precision Rimfire trigger.
9. Take your new Timney Trigger and make sure the trigger is in the safe position. If the trigger is not in the safe position the upper receiver will not fit in the lower receiver. Slide the trigger up and in. *If you have a gen.1 model RPR-22 you will need to install the shim that is provided with the trigger between the rear action screw and the trigger mounting hole. Don't forget to preload the cocking guide piece spring by putting the plunger back into the top of the "J" shaped slot.
10. With the safety selector switch in the "SAFE" position, install the lower receiver back onto the rifle. Next tighten the two bedding screws in the bottom of the stock to torque specs recommended by the manufacturer.
11. Reinstall the bolt and chassis coring cover.
12. The Timney Ruger Precision Rimfire's pull weight for the first stage (8oz-1lbs) and second stage (1lbs-2lbs) is fully adjustable by adjusting the setscrews as shown below with a 5/64" Allen key. Turn clockwise to increase pull weight and counterclockwise to decrease pull weight.
13. Perform a function check and enjoy your new Timney Trigger.



Chassis Coring Cover

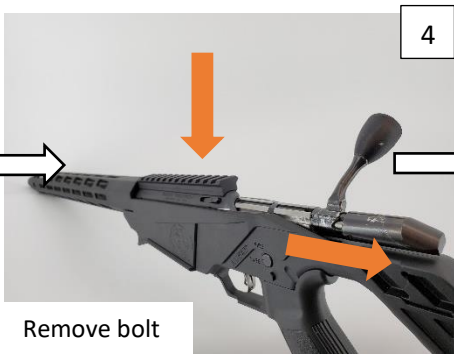

Remove bolt

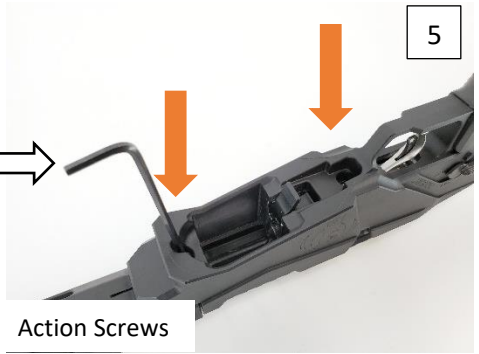

Action Screws

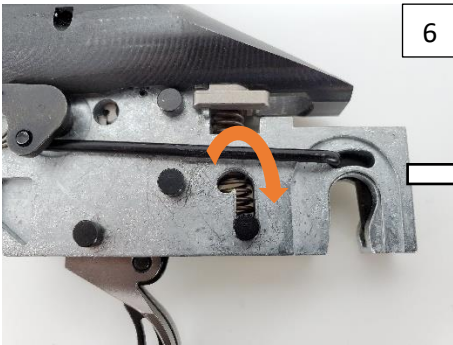

Cocking piece guide

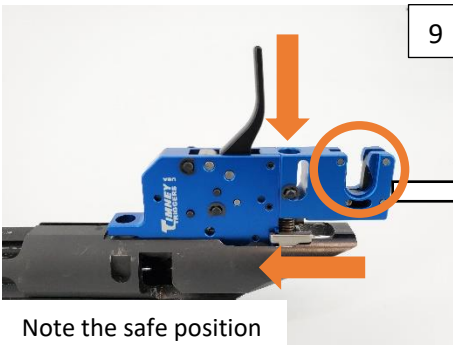
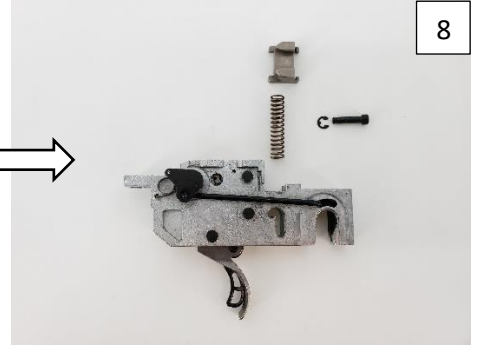
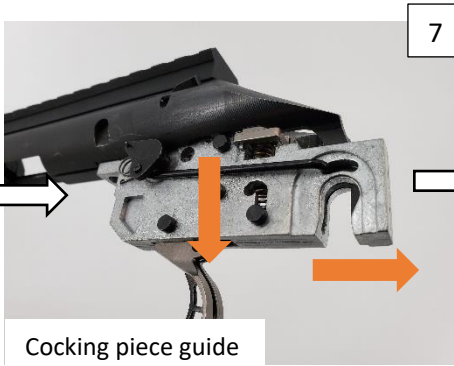

Note the safe position

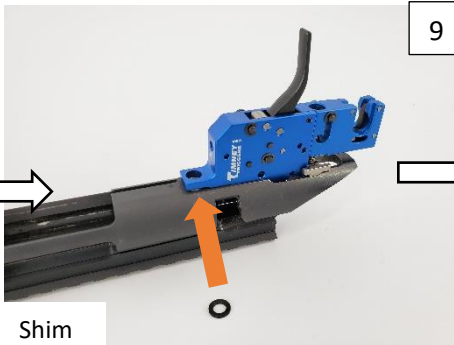

Shim



First stage adjustment

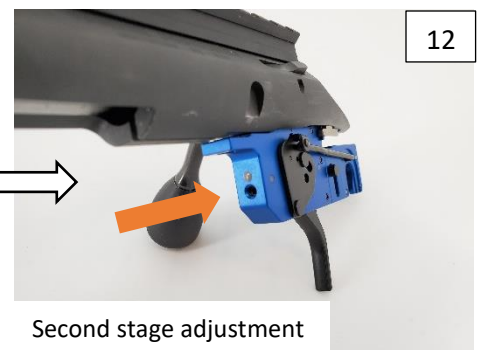
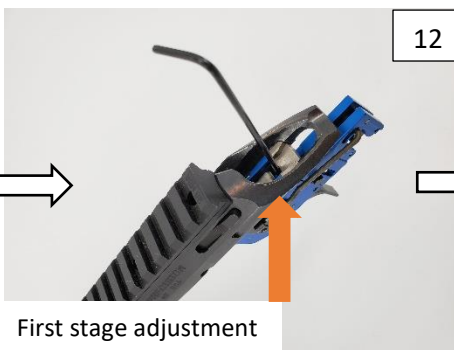

Second stage adjustment

NOTE: *If you have trouble, contact Timney or check out the troubleshooting steps on the Timney web site. Timney will also install your trigger for \$ 40.00 plus \$ 35.00 shipping and handling.*

TIMNEY TRIGGER GUARANTEE

Material and workmanship: This Timney trigger has been carefully inspected, tested and adjusted to give a lifetime of dependable service. Every possible care has been exercised in its design and construction. If any defect in workmanship or material should develop under conditions of normal use and service, any necessary repairs, including parts and labor will be made at NO CHARGE to the purchaser providing that our inspection reveals parts were not damaged through accident, alteration, misuse, abuse or other causes beyond our control. We neither assume nor imply any oral or statutory warranties, and we neither assume nor authorize any person to assume for us any obligation or liability in connection with this trigger. Repairs or disassembly of this trigger in any manner without specific authorization, voids the guarantee.