

**BRAVIA**  
**Internet Video Link**

DMX-NV1



**NETWORK VIDEO RECEIVER Quick Setup Guide**

© Sony Corporation 2008. Printed in USA.

4-116-031-11(1)

**BRAVIA® Internet Video Link Accessories**
Receiver (DMX-NV1)  
& Cable Cover

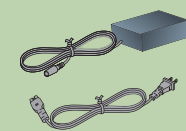
Quick Setup Guide

AC Adapter with  
AC Power Cord

Attachment Guide



Mounting Bracket



Mounting Knobs



Plastic Fasteners



HDMI Cable

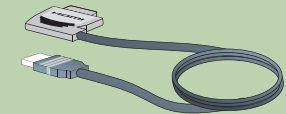

USB Cable

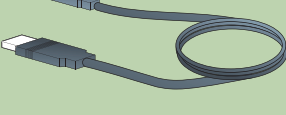
**Owner's Record**
Record the serial  
number below:
**For Your Convenience**

Please contact Sony Customer Support directly if you have questions on the use of your BRAVIA Internet Video Link after reading your Quick Setup Guide and Operating Instruction Manual (available on the Internet at <http://internet.sony.tv/manual>).

Contact Sony Customer Support at:

<http://esupport.sony.com/bravialink>

Or to speak with a support representative:

United States

1-866-918-BIVL (2485)

Please Do Not Return the Product to the Store

💡 Ethernet cable required  
(not supplied).

**Setting up the BRAVIA® Internet Video Link**

Your BRAVIA LCD TV includes BRAVIA Internet Video Link. The Sony BRAVIA Internet Video Link brings on-demand entertainment and information from the Internet, including movies, news, traffic, and weather. High-speed Internet access is also required. Power off your TV before beginning the setup.

Please read all instructions before beginning the installation.

Refer to the separate Attachment Guide for instructions on mounting to your TV.

**1 Remove Cable Cover**

Remove the cable cover to expose the ports located on the bottom of the receiver.

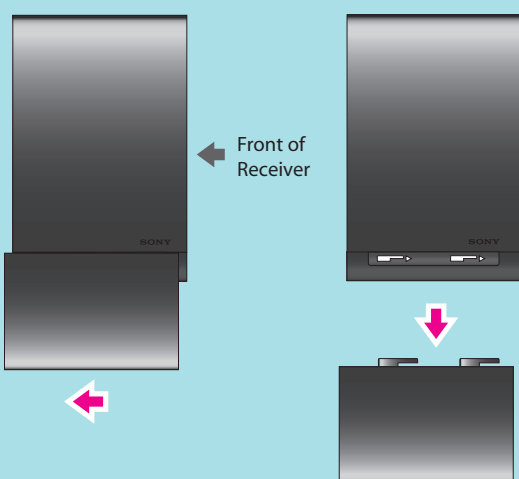
**2 Connect Cables**

Connect the cables in the order shown below.



💡 Look for the serial number found on the bottom of the receiver to record in the Owner's Record.

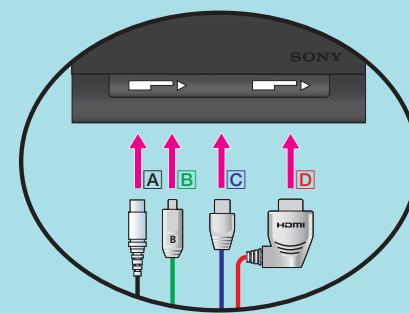

**A** DC IN 9V: Connect the AC adapter to this port. Do not plug into the wall outlet at this time.

**B** DMeX: Connect the small end of the USB cable to this port.

**C** LAN: Connect an Ethernet cable (not supplied) to this port.

**D** HDMI OUT: Connect the L-shaped end of the HDMI cable to this port.

**3 Connect to TV**

**B** Connect the large end of the USB cable to the DMeX/SERVICE port on the TV.

**D** Connect the straight end of the HDMI cable to any HDMI port on the TV.

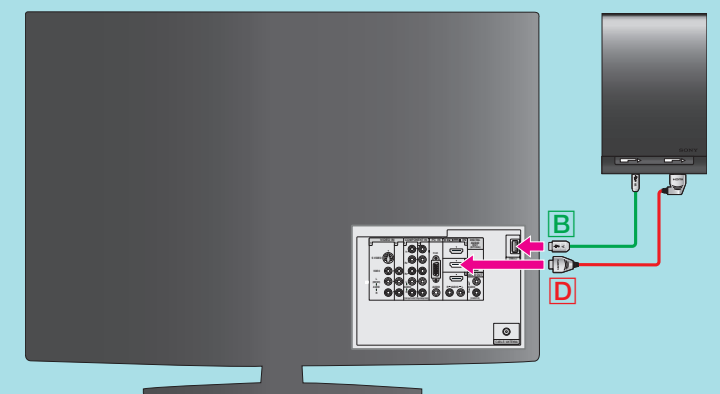
**4 Connect to the Internet**

Choose one of the following recommendations to connect the BRAVIA Internet Video Link receiver to the Internet with easy "plug and play." Connect an Ethernet cable (not supplied) between the receiver and your Internet source.

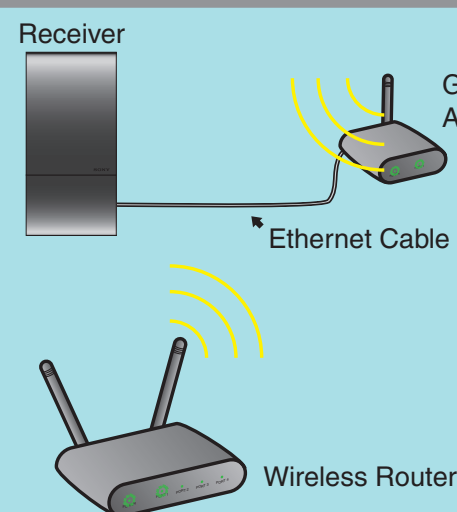
**Gaming Adapter as Wireless Bridge**

Standard Definition video: 802.11g  
High Definition video: 802.11n

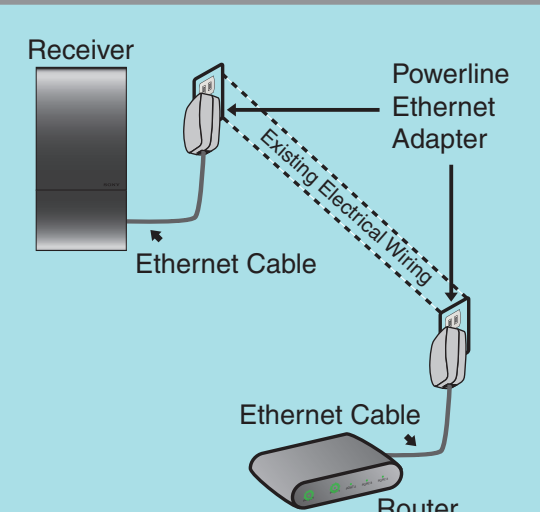
**Powerline Ethernet Adapter**

Standard Definition video: HomePlug Turbo,  
HomePlug AV, UPA, HD-PLC  
High Definition video: HomePlug AV, UPA, HD-PLC

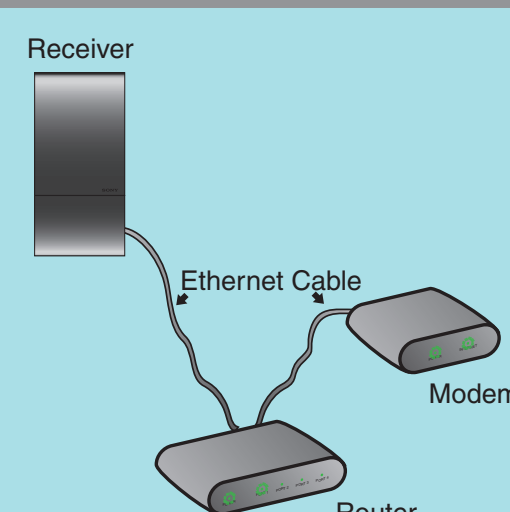
**Direct to Router**

💡 If you need to configure a fixed IP address or proxy server, check the Operating Instruction Manual for more information.

**6 Confirm Connection**

Follow these instructions to confirm.

a. Press the **DMeX** button on your TV's remote control to view the connection status.

💡 If "Feature available with DMeX module" appears on the screen, wait a few moments and try again.

💡 The first time the receiver is connected to the Internet, the software may require an update.

b. Follow the instructions on-screen to complete **Region Setup**.

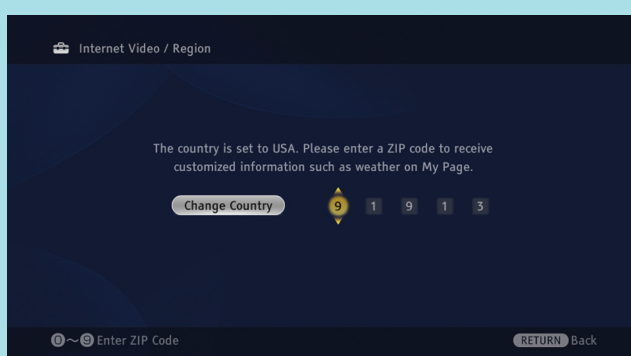

💡 Default country is the United States. Press the **HOME** button to select a different country.

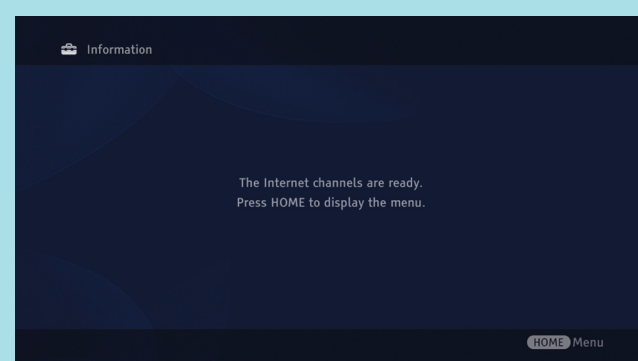

c. When your region is setup, the receiver will attempt to connect to the Internet. Upon successful connection, you will see the screen below.

d. Press the **HOME** button on your remote control to display the **XMB™**. These menu icons associated with the receiver will appear when the service content providers are ready.

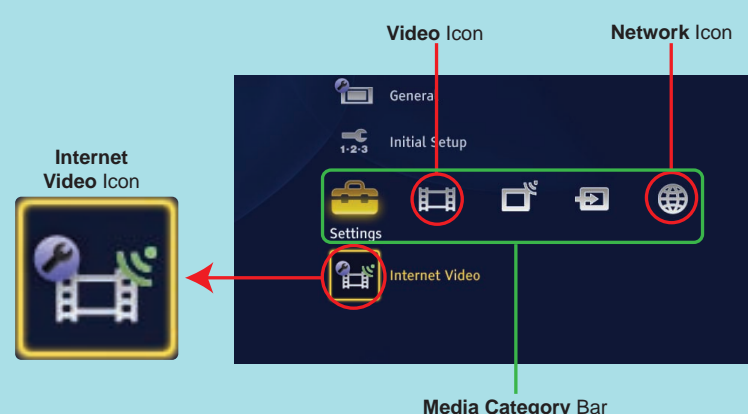

💡 **IMPORTANT:** Do not press the **INPUT** button on the remote control to access the BRAVIA™ Internet Video Link. It is available on the **XMB™**.

**5 Verify Connection**

a. Plug in the receiver and power on the TV.

b. Once the receiver and TV are powered on, confirm the LED lights.

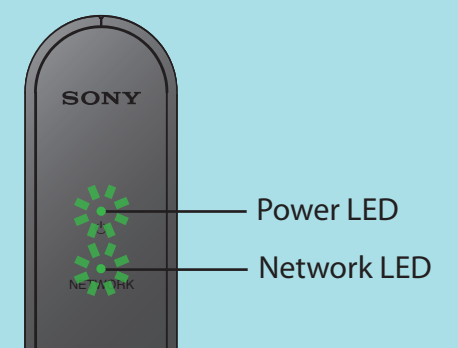

When you see...	Receiver...
<b>Power LED</b>	<b>Green</b> is powered "On."
	<b>Red</b> is not connected. Check all cable components.
	<b>Orange</b> is in update mode.
<b>Network LED</b>	<b>Green</b> is connected to the Internet.
	<b>Blinking Green</b> has network activity.

💡 If the LEDs do not light up in green, confirm that all cables are securely connected.

**7 Attach Cable Cover**

Slide the cable cover back into place.

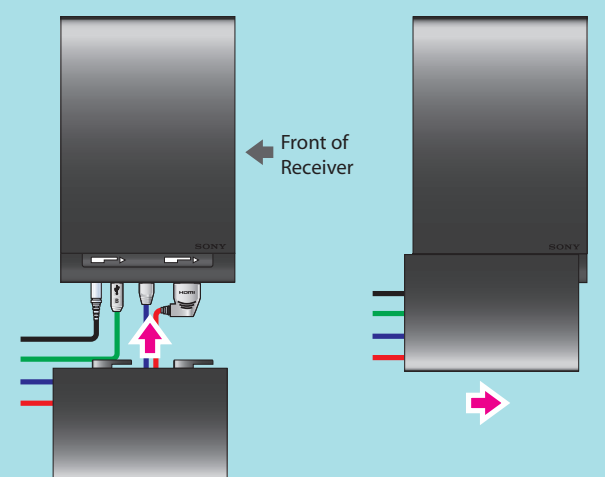

💡 For instructions on attaching to the TV, see the separate Attachment Guide.



Using Your TV's Remote Control with Your Receiver

Use your Sony TV's remote control with the DME<sup>x</sup> button to operate the BRAVIA Internet Video Link receiver.

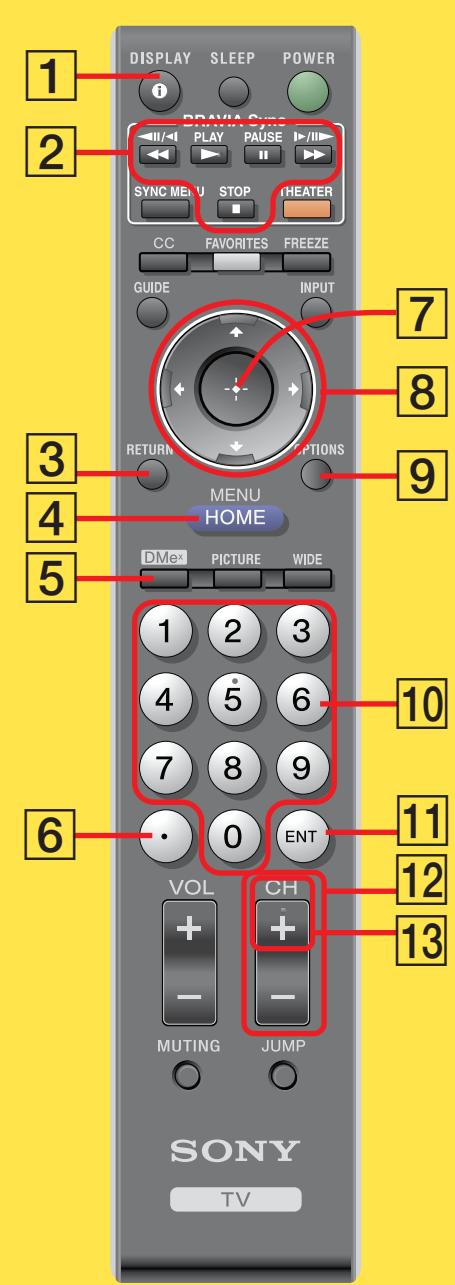

RM-YD023

Basic Menu Operations

Press...	To do this
3 RETURN	Return to the previous screen or save a selection, depending on the screen.
4 MENU HOME	Display the TV Home Menu/XMB™(XrossMediaBar)
5 MY PAGE	Launch My Page
6 Erase	Press to erase an entry in the keypad
7 +	Make or confirm a selection
8 DIRECTIONAL	Move up, down, left or right on the screen
10 0-9	Enter numbers
11 ENT	Press to change fields in the keypad
12 CH +	Page up or down within an Internet Video Guide

Video Operations

Press...	To do this
1 DISPLAY	Display basic information about the highlighted video or open the Control Panel when a video is playing
2 REWIND	Seek backwards during video playback. Press multiple times to increase the speed of the seek. PLAY Play a video ([7] can also be used to play a video)
3 STOP	Stop a video and return to the Internet Video Guide ([3] can also be used to stop a video)
4 PAUSE	Pause a video ([7] can also be used to pause a video)
5 FFWARD	Seek forwards during video playback. Press multiple times to increase the speed of the seek
9 OPTIONS	View Home Category, view additional Categories, Sort By, Save this Link
13 CH +	Skip ahead to the next video in queue

Getting to Know Your Receiver

Internet Video Guide

BRAVIA Internet Video Link is a gateway that brings Internet videos straight to your BRAVIA TV. Follow these instructions to access each individual service content provider's Internet Video Guide.

1. Press **HOME** on the remote control to access the **Video** menu on the **XMB™** (XrossMediaBar®).
2. Press the **▼** button to highlight the content provider of your choice.
3. Press **○** to open the **Internet Video Guide** with videos provided by the content provider.

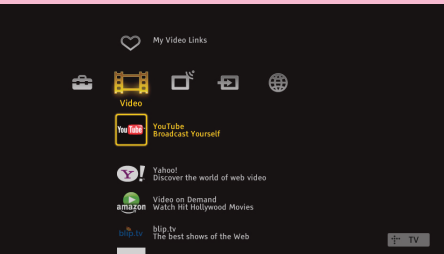

The videos in the **Internet Video Guide** are arranged in thumbnails. Each video's title and parental guideline rating is labeled in the lower left-hand corner of the screen.

1. Scroll between videos using the **▲/▼/◀/▶** buttons. To page up and down, press **CH +/-**.
2. Highlight the video you want to play.
3. Press **○** or **PLAY** to begin playing the video.

💡 In the **Internet Video Guide**, press **OPTIONS** and select a category from the list to view more videos.

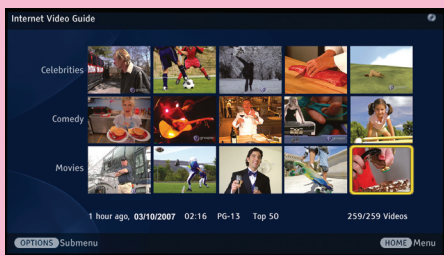

Video Playback

- Press **○** or **PAUSE** to **Pause** the video during playback. Press **○** or **PLAY** to **Play**.
- Press the **RETURN** button to stop the video and return to the **Internet Video Guide**.
- Press **▲/▼** to zoom in/out.
- Press **OPTIONS** to display other available options.

💡 For additional remote control operations while playing a video, see the "Using Your TV's Remote Control with Your Receiver" section.

💡 Original quality of the picture may be lost when zooming in or out.

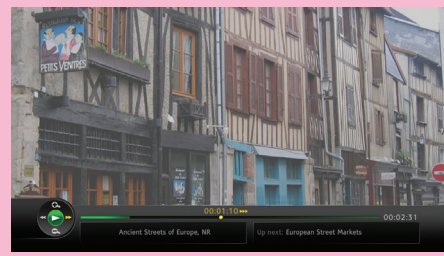

My Video Links

Follow the instructions below to save videos to **My Video Links** for quick and easy viewing.

- Save this Link**
1. In the **Internet Video Guide**, highlight the video you wish to save.
  2. Press the **OPTIONS** button and select **Save this Link**.

View My Video Links

1. Press the **HOME** button and highlight the **Video** icon on the **XMB™**.
2. Press the **▲** button to select **My Video Links**.

💡 The **Favorites** button on your TV's remote control is specifically for TV channel Favorites.

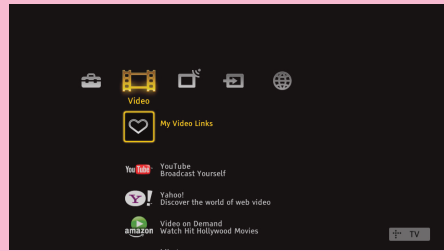

Helpful Hints and Troubleshooting

- The receiver should be installed near an easily accessible power outlet.
- To turn off or reset the receiver, unplug it from the wall.
- Test the receiver's connection before attaching it to your TV, especially if you are mounting the TV to a wall.
- If icons related to the receiver do not appear as shown in step 6 of Setting up the BRAVIA Internet Video Link, check your cable connections and Internet connection.
- Make sure that the USB and the HDMI cables are connected to the receiver and to the corresponding ports on the TV set.
- Verify your network connection by ensuring the **Internet Video** icon, shown to the right, appears on the **XMB™** under the **Settings** menu.
- If the screen is black, press the **HOME** button to access the **XMB™**, and select an icon associated with the receiver. Do not try to access the receiver using the **INPUT** button on the remote control. The HDMI input on the TV will not activate the receiver.
- To view more videos while in the **Internet Video Guide**, press the **OPTIONS** button and select a new category from the list. Select **Home Category** to return to the main page.
- Some videos may not be available for viewing, depending on the TV's **Parental Lock** settings.
- Videos saved to **My Video Links** may not be available if the service content provider has removed the video from their server.
- Your receiver will update software from time to time. See the Operating Instruction Manual (online) for more details.
- It is normal to see a black screen following an update or a reset of the receiver. To proceed, press the **HOME** button and select an icon from the **XMB™**.
- Recommended connection speed: Standard Definition video 2.5 Mbps, High Definition video 10 Mbps



(connected, green)

- To register your BRAVIA™ Internet Video Link and access enhanced features, visit <https://internet.sony.tv>
- To view or download the Operating Instruction Manual, visit <http://internet.sony.tv/manual>
- A hard copy of the Operating Instruction Manual is available by calling **800-488-SONY (7669)** or by visiting <http://www.sony.com/accessories> (handling charges may apply).
- For further assistance, please visit our web site or call the number provided below.

**Sony Customer Support**  
<http://esupport.sony.com/bravialink>  
**United States**  
**1-866-918-BIVL (2485)**

Specifications

Model Name: Network Video Receiver DMX-NV1	Dimensions (receiver alone): 4.1 x 6.4 x 1.3 inches (105.4 x 163.7 x 32.3 mm)
AC Adapter (included): Input: AC 120V 0.5A 60Hz Output: 9V ≒ 1.75A	Mass (receiver alone): 1.1 lbs (0.5 kg)
DC Input: 9V ≒ 1A 9W	

Messages

From time to time, Sony and the service content providers will send important information to your **Messages** Inbox.

To open your **Messages** Inbox:

1. Press **HOME** on your TV's remote control to access the **Network** menu on the **XMB™** (XrossMediaBar®).
2. Highlight the **Messages** icon and press **○**.
3. Your **Messages** Inbox will open. To read a message, highlight it using the **▲/▼** buttons and press **○**.

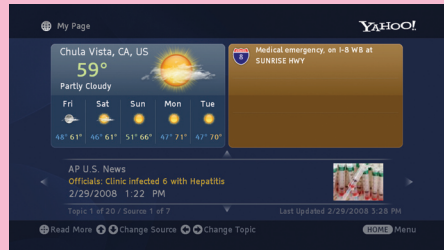

💡 **My Page** is also available from the **Network** icon on the **XMB™**.

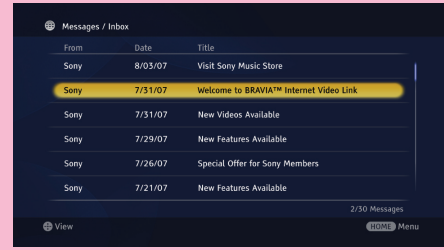

YouTube is a trademark of Google Inc.  
Yahoo! and the Yahoo! logo are registered trademarks of Yahoo! Inc.  
Amazon is a trademark of Amazon.com Inc.  
Blip.tv is a trademark of Blip Networks, Inc.

💡 The screen images shown above may differ from the actual images you see on your TV.