

**SRS Indicator Comes On With SRS DTC(s) 15-1, 15-2, 15-3**

(Replaces 00-033, *SRS Light On With DTC 15-1*, dated November 13, 2000, and 01-013, *SRS Indicator Comes On With DTC 15-3*, dated March 12, 2001)

**SYMPTOM**

The SRS indicator is on, and one or more of these SRS DTCs are set:

- SRS DTC 15-1 (faulty OPDS unit or OPDS not initialized)
- SRS DTC 15-2 (faulty side airbag indicator light circuit)
- SRS DTC 15-3 (faulty OPDS sensor)

**PROBABLE CAUSE****DTC 15-1**

A faulty occupant position detection system (OPDS) unit.

**DTC 15-2**

- A faulty OPDS unit
- Side airbag cutoff indicator (SIDE AIRBAG; SIDE AIRBAG OFF in later models) is faulty.
- Fuses in certain circuits (such as the odometer) blow or are removed while the ignition switch is ON (II)
- Any part of the SRS circuit (particularly the gauge assembly) is disconnected while the ignition switch is in ON (II)

**DTC 15-3**

- A faulty OPDS unit
- OPDS sensor interference from an electrical appliance operating near the front passenger seat-back

**VEHICLES AFFECTED****3.5RL**

- 1999-01 - ALL
- 2002 - From VIN JH4KA9...2C00001 thru JH4KA9...2C012399

**3.2TL**

- 2000-2002 - ALL

**3.2CL**

- 2001-02 - ALL
- 2003 - From VIN 19UYA4...3A000001 thru 19UYA4...3A000185

**RSX**

- 2002 - From VIN JH4DC5...2C000001 thru JH4DC5...2C025389

**MDX**

- 2001 - ALL
- 2002 - From VIN 2HNYD1...2H500001 thru 2HNYD1...2H515881

**CORRECTIVE ACTION**

Repair the vehicle as indicated by the **DIAGNOSIS**.

**TOOL INFORMATION**

PGM Tester with SN300 or later software

Autoprobe: P/N VET-02001373

*(The Autoprobe is part of your dealer's PGM Tester kit. It is commonly used to troubleshoot 1992-95 vehicles. If you need another Autoprobe, order it from the Acura Tool and Equipment Program at 888-424-6857.)*

or

SCS Service Connector: T/N 07PAZ-0010100

## PARTS INFORMATION

### OPDS Unit

1999–02 3.5RL: P/N 81334-SZ3-A13

2000–01 3.2TL: P/N 81334-S0K-305

2002 3.2TL: P/N 81334-S0K-A63

2002 3.2TL Type S: P/N 81334-S0K-A72

2001–03 3.2CL: P/N 81334-S3M-A73

2002 RSX: P/N 81334-S6M-A02

2001–02 MDX: P/N 81334-S3V-A33

All models except RSX: Seat-Back Panel Clips:

P/N 91566-SP0-003 (3.5RL: 3 required; 3.2TL, 3.2CL, MDX: 2 required)

## WARRANTY CLAIM INFORMATION

In warranty: The normal warranty applies.

OP#	Description	FRT
723507	Retrieve and clear SRS DTC(s) (3.5RL)	0.3
751109	Replace the OPDS unit (3.5RL)	0.4
723507	Retrieve and clear SRS DTC(s) (3.2TL)	0.3
751109	Replace the OPDS unit (3.2TL)	0.3
723507	Retrieve and clear SRS DTC(s) (3.2CL)	0.3
751109	Replace the OPDS unit (3.2CL)	0.3
723507	Retrieve and clear SRS DTC(s) (RSX)	0.3
751109	Replace the OPDS unit (RSX)	0.3
723507	Retrieve and clear SRS DTC(s) (MDX)	0.3
751109	Replace the OPDS unit (MDX)	0.3

Failed Part: P/N 81334-S0K-A61

Defect Code: 032

Contention Code: B03

Skill Level: Repair Technician

**Out of warranty:** Any repair performed after warranty expiration may be eligible for goodwill consideration by the District Parts and Service Manager or your Zone Office. You must request consideration, and get a decision, before starting work.

## DIAGNOSIS

Do the appropriate diagnosis based on what SRS DTC(s) are set.

### Diagnosing SRS DTC 15-1

Use the PGM Tester to clear the DTC:

- If the DTC sets again, disregard this service bulletin, and continue with normal troubleshooting.
- If the DTC does *not* set again, go to **REPAIR PROCEDURE**.

### Diagnosing SRS DTC 15-2

Use the PGM Tester to clear the DTC. Inspect the connections and wiring of the side airbag cutoff indicator circuit:

- If the connections and wiring are OK, and the circuit components were *not* disconnected for some previous repair, and the DTC does *not* set again, go to **REPAIR PROCEDURE**.
- If the connections or wiring are faulty, repair the circuit. If the DTC sets again, continue with normal troubleshooting.

### Diagnosing SRS DTC 15-3

Use the PGM Tester to clear the DTC. Ask your customer if he or she uses an aftermarket electrical appliance (laptop computer, fluorescent map light, etc.) near the front passenger's seat-back. Some electrical appliances that plug into the vehicle's accessory power socket—especially those using a power inverter/converter—can interfere with the seat-back sensors and cause SRS DTC 15-3 to set.

- If your customer uses any of these appliances, operate the appliance near the front passenger's seat-back. If the DTC sets again, clear the DTC, then return the vehicle to your customer. Advise him or her to avoid using the appliance near the front passenger's seat-back.
- If your customer does *not* use any of these appliances, and the DTC does *not* set again after clearing, go to **REPAIR PROCEDURE**.
- If the DTC sets again after clearing, disregard this service bulletin, and continue with normal troubleshooting.

## REPAIR PROCEDURE

1. Make sure you have the anti-theft code for the radio and for the navigation system (if equipped), then write down your customer's radio station presets.
2. Turn the ignition switch to LOCK (0).
3. Disconnect the negative battery cable, then wait at least **3 minutes** before you start work.

4. *All models except RSX:* Remove the front passenger's seat-back panel by prying out the bottom, then discard the lower clips.

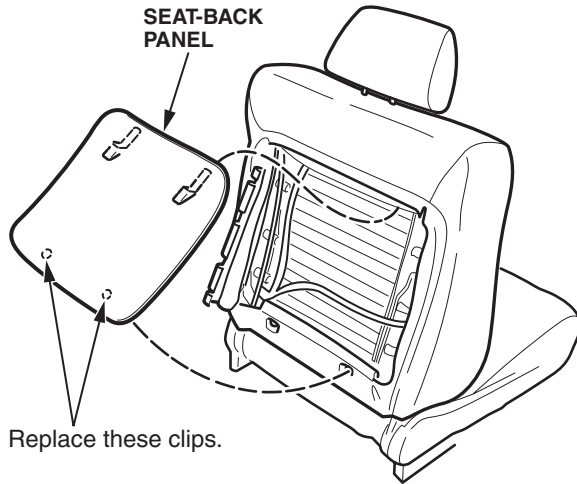

(3.2TL is shown.)

5. *RSX models only:* Unzip the two seat cover zippers on the back of the front passenger's seat.

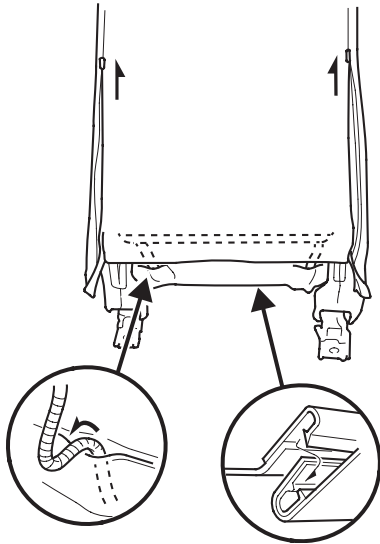

6. Pull back the seat-back cover from the left side bolster so you can access the OPDS unit cover.

7. Remove the OPDS unit cover from the seat frame (three clips).

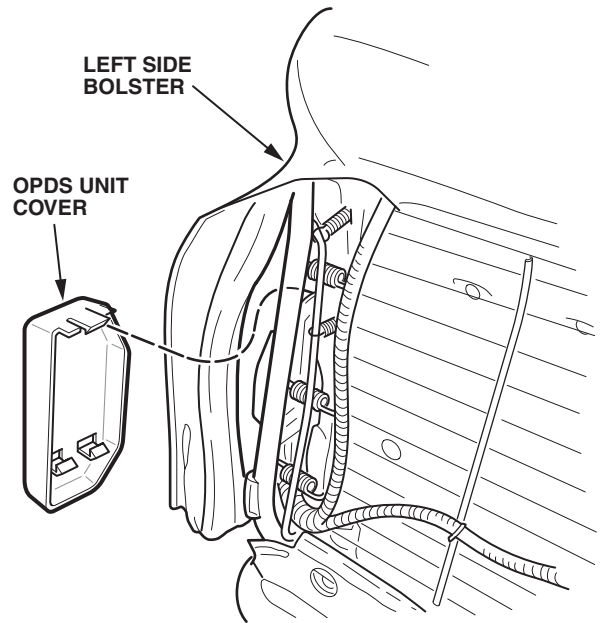

(3.2TL is shown.)

8. Recline the seat-back so you can access the OPDS unit mounting screws.
9. Remove the mounting screws from the OPDS unit, and gently pull out the unit.

*3.2CL models only:* To remove the mounting screws, remove the four mounting bolts for the front passenger's seat, and tilt back the seat far enough to clear the center console.

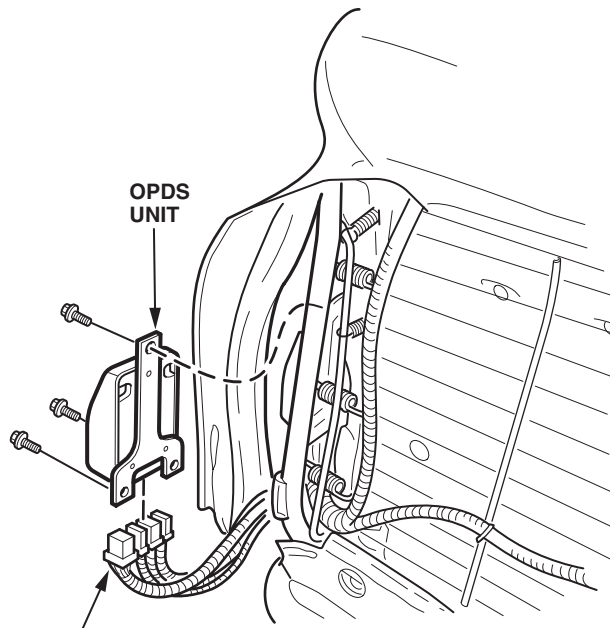

OPDS UNIT  
OPDS CONNECTORS  
(3.2TL is shown.)

10. Unplug the electrical connectors, then remove the unit.
11. Install the new OPDS unit, then snap the new cover in place.
12. *3.2CL models only:* Reinstall the front passenger seat mounting bolts. Torque the bolts to 34 N·m (25 lb-ft).
13. Slip the seat-back cover over the OPDS unit.
14. *3.2TL, 3.2CL, MDX models only:* Check the attachment bosses for the clips:
  - If the attachment bosses are deformed or broken, or were damaged when you removed the seat-back panel, do the repair procedure in S/B 02-006, *Seat-Back Panel Is Loose or Detached*, found under Body. Then go to step 15.
  - If the attachment bosses are OK, go to step 15.

15. *All models except RSX:* Install the new clips in the seat-back panel. Turn the clips so the retaining tabs on the clips are horizontal. This ensures that the clips fully set into the mounting holes in the seat.

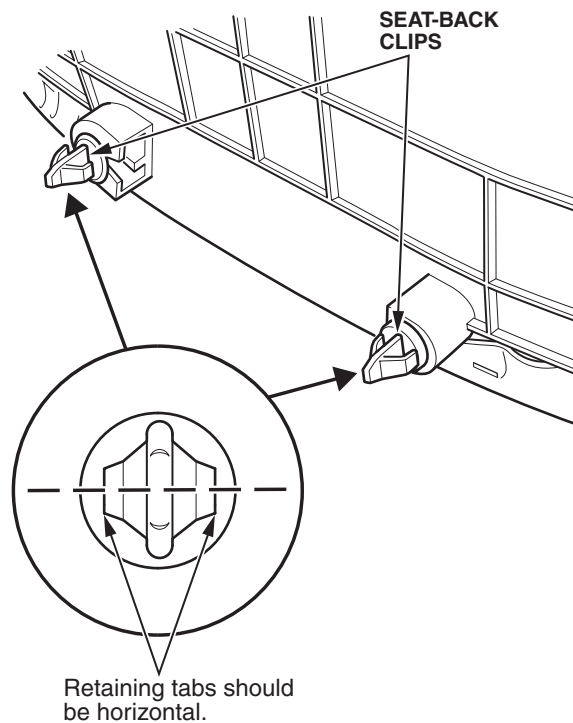

(3.2TL is shown.)

16. *All models except RSX:* Reinstall the seat-back panel.
17. *RSX models only:* Zip the seat-back cover closed.
18. Reconnect the negative battery cable, and turn the ignition switch to ON (II).
19. Use the PGM Tester to initialize the OPDS unit:
  - If you have an Autoprobe, go to **Initializing the OPDS With the PGM Tester and the Autoprobe.**
  - If you do *not* have an Autoprobe, go to **Initializing the OPDS With the PGM Tester and the SCS Service Connector.**

#### Initializing the OPDS With the PGM Tester and the Autoprobe

1. Adjust the front passenger's seat-back to a normal upright position, and remove anything that is on or near the seat.
2. Start the engine, and turn on the A/C. Close the doors and windows, and run the A/C in Recirculation mode for **30 minutes**. This will dry out any moisture that may be in the front passenger's seat.
3. Turn the ignition switch to LOCK (0).

- Connect the PGM Tester to the 16P data link connector (DLC).

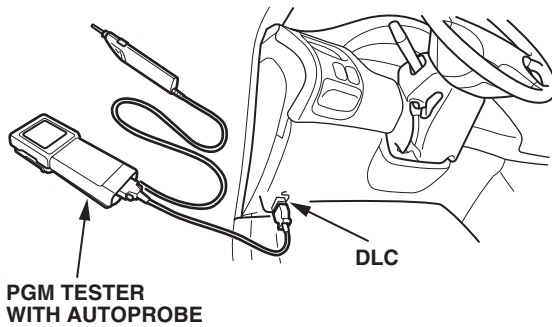

(*'02–03 3.2TL is shown.*)

- Turn the ignition switch to ON (II), and enter the VIN into the PGM Tester.
- Follow the screen prompts on the PGM Tester to get to the SYSTEM SELECT screen. From that screen, select SRS.
- From the SRS screen, select MISC TESTS.
- From the MISC TESTS screen, select OPD SYSTEM INIT.
- Follow the remaining screen prompts to complete the OPDS initialization. If the initialization fails, repeat the process two more times. If the initialization fails again, check for set SRS DTCs, and troubleshoot in accordance with the appropriate service manual.
- Do the idle learn procedure:
  - Make sure all electrical items (A/C, audio unit, defogger, lights, etc.) are turned off, then start the engine.
  - Let the engine reach its normal operating temperature (the cooling fan cycles twice).
  - Let the engine idle (throttle fully closed and with all electrical items off) for **10 minutes**.

- '02 3.5RL, '02–03 3.2TL, '03 3.2CL models:* Initialize the driver's window auto-up feature:
  - Turn the ignition switch to ON (II).
  - Make sure the driver's window is fully closed.
  - Push down and hold the window switch. Make sure the window goes all the way down.
  - Pull back and hold the window switch. Make sure the window goes all the way up, then hold the switch for at least **2 more seconds**.
- Enter the anti-theft code for the radio and for the navigation system (if equipped). Enter your customer's radio station presets. Set the clock.

#### Initializing the OPDS With the PGM Tester and the SCS Service Connector

- Adjust the front passenger's seat-back to a normal upright position, and remove anything that is on or near the seat.
- Start the engine, and turn on the A/C. Close the doors and windows, and run the A/C in Recirculation mode for **30 minutes**. This will dry out any moisture that may be in the front passenger's seat.
- Turn the ignition switch to LOCK (0).
- All models except 3.5RL:* Connect the PGM Tester to the 16P data link connector (DLC). Leave the ignition switch in LOCK (0). Follow the screen prompts in the "SCS" menu (see the Honda PGM Tester Operator's Manual).

NOTE: When you see the message "The SCS line in the 16P DLC has been grounded," do *not* press the **EXIT** or **YES** keys on the keypad. Doing so would take you out of the SCS mode, and stop OPDS initialization.

- 3.5RL models only:* Plug the SCS service connector into the 2P service check connector. Refer to page 24–88 of the 1996–01 3.5RL Service Manual for details.
- Plug the SCS service connector into the 2P memory erase signal (MES) connector, as shown. Do *not* use a jumper wire.

#### 3.5RL Models:

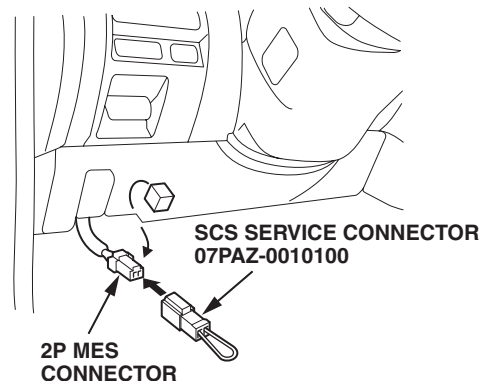

### 3.2TL, 3.2CL Models:

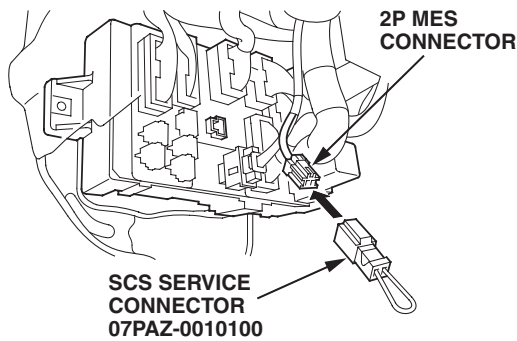

### RSX Models:

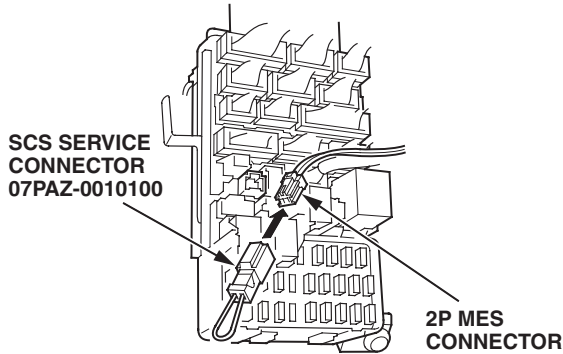

### MDX Models:

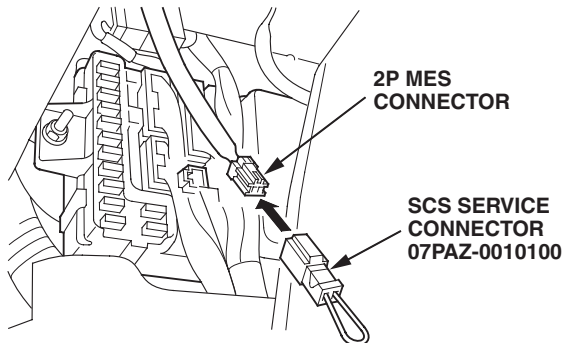

7. Turn the ignition switch to ON (II).
8. Watch the SRS indicator. It comes on for about **6 seconds** and goes off. Unplug the SCS service connector from the 2P MES connector within **4 seconds** after the indicator goes off.
9. When the SRS indicator comes on again, plug the SCS service connector into the 2P MES connector within **4 seconds** after the indicator comes on.
10. When the SRS indicator goes off, unplug the SCS service connector from the 2P MES connector within **4 seconds**.
11. Watch the SRS indicator:
  - If the indicator blinks twice and then goes off, the OPDS is initialized. Turn the ignition switch to LOCK (0), and disconnect the PGM Tester (all models except 3.5RL) or unplug the SCS service connector from the 2P service check connector (3.5RL models only). Go to step 20.

- If the indicator blinks twice and then stays on, the OPDS is initialized, but the SRS DTCs need to be cleared. Go to step 12.
  - If the indicator stays on without first blinking, the OPDS is *not* initialized. Repeat steps 3 thru 11.
12. Turn the ignition switch to LOCK (0), and disconnect the PGM Tester.
  13. Plug the SCS service connector into the 2P MES connector. Do *not* use a jumper wire.
  14. Turn the ignition switch to ON (II).
  15. Watch the SRS indicator. It comes on for about **6 seconds** and goes off. Unplug the SCS service connector from the 2P MES connector within **4 seconds** after the indicator goes off.
  16. When the SRS indicator comes on again, plug the SCS service connector into the 2P MES connector within **4 seconds** after the indicator comes on.
  17. When the SRS indicator goes off, unplug the SCS service connector from the 2P MES connector within **4 seconds**. The SRS indicator blinks twice to indicate that the memory has been cleared.
  18. Turn the ignition switch to LOCK (0), and wait for **10 seconds**.
  19. Turn the ignition switch to ON (II). The SRS is OK if the SRS indicator comes on for **6 seconds** and then goes off. If the initialization fails, repeat the process two more times. If the initialization fails again, check for set SRS DTCs, and troubleshoot in accordance with the appropriate service manual.
  20. Do the idle learn procedure:
    - Make sure all electrical items (A/C, audio unit, defogger, lights, etc.) are turned off, then start the engine.
    - Let the engine reach its normal operating temperature (the cooling fan cycles twice).
    - Let the engine idle (throttle fully closed and with all electrical items off) for **10 minutes**.
  21. '02 3.5RL, '02-03 3.2TL, '03 3.2CL models: Initialize the driver's window auto-up feature:
    - Turn the ignition switch to ON (II).
    - Make sure the driver's window is fully closed.
    - Push down and hold the window switch. Make sure the window goes all the way down.
    - Pull back and hold the window switch. Make sure the window goes all the way up, then hold the switch for at least **2 more seconds**.
  22. Enter the anti-theft code for the radio and for the navigation system (if equipped). Enter your customer's radio station presets. Set the clock.