

vtech[®]

User's Manual

Go! Go! Smart Wheels[®]
Playtime with miles of learning!

Train Station Playset

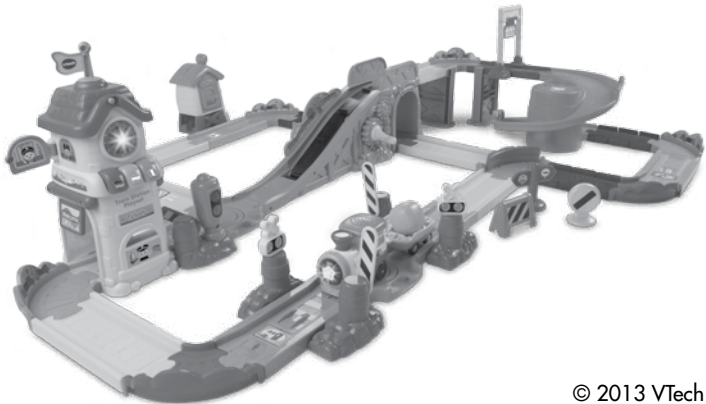

© 2013 VTech
Printed in China
91-002858-007[®]

Dear Parent,

Welcome to the world of **Go! Go! Smart Wheels**®! We're excited you've decided to ride along with us and explore all that **Go! Go! Smart Wheels**® has to offer. These toys have been designed to give your child a thrilling learning experience with hours and hours of fun as well.

Go! Go! Smart Wheels® features vehicles that interact with your child by lighting up, singing and talking, while teaching your child letters and vehicle names (each sold separately). There are other surprises in store, too! With our innovative **SmartPoint**™ technology, available exclusively on **Go! Go! Smart Wheels**® playsets (each sold separately), your child will smile as they hear **SmartPoint**™ vehicles respond to each unique **SmartPoint**™ location with singing, sound effects and fun phrases.

Our **Go! Go! Smart Wheels**® playsets also feature buttons, gears and other mechanical features to encourage the development of your child's fine motor skills. Many of the playsets also have tracks that can be arranged in endless ways, stimulating your child's creativity. In addition, many of the **Go! Go! Smart Wheels**® playsets connect to other playsets in the collection, so there's no end to what your child can do!

With **Go! Go! Smart Wheels**®, it's playtime with miles of learning!

Sincerely,
Your friends at **VTech**®

To learn more about **VTech**® toys, visit www.vtechkids.com

INTRODUCTION

Thank you for purchasing the **VTech® Go! Go! Smart Wheels® Train Station Playset** learning toy!

The **Go! Go! Smart Wheels® Train Station Playset™** by **VTech®** lets your child play like a real conductor! Spark your child's imagination as they combine 32 tracks into different configurations. Watch the motorized train engine and cargo car chug along the tracks and go into the station, under the bridge and through the tunnel. The train and other **Go! Go! Smart Wheels® SmartPoint™** vehicles (each sold separately) respond to 10 **SmartPoint™** locations that teach early language development skills. All aboard! It's playtime with miles of learning!

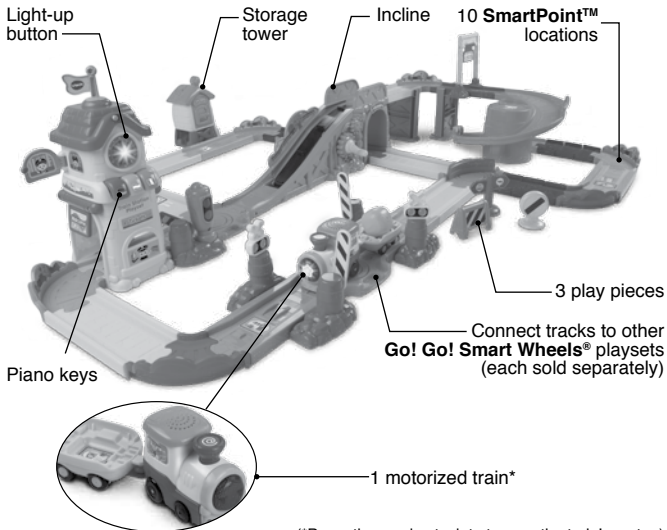

(*Press the smokestack to turn on the train's motor.)

INCLUDED IN THIS PACKAGE

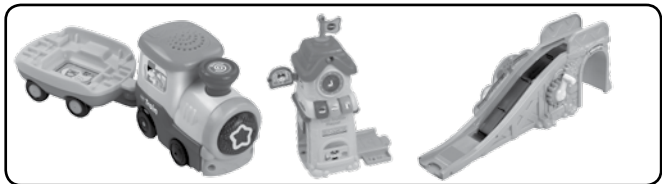

- One VTech® Go! Go! Smart Wheels® Motorized Train with SmartPoint™ cargo car
- One VTech® Go! Go! Smart Wheels® electronic train station with one SmartPoint™ track
- One incline



- One storage tower
- Two SmartPoint™ tracks with traffic lights
- One SmartPoint™ track with road sign
- Two bridge supports

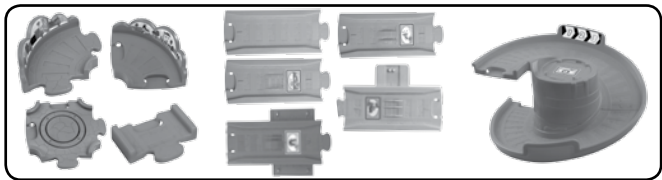

- Four 90-degree tracks, male
- Three 90-degree tracks, female
- Four cross tracks
- Eight short tracks
- Five straight tracks
- Two straight **SmartPoint™** tracks
- One **SmartPoint™** track for the storage tower
- One **SmartPoint™** tunnel track
- One spiral ramp with **SmartPoint™** location

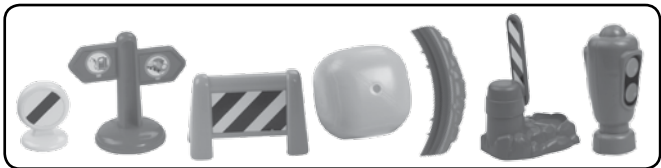

- One circle sign
- One destination board
- One road block
- One block for the storage tower
- One curved piece for the cross tracks (changes direction)
- One gate railing with base for station
- One traffic light
- One User's Manual

WARNING: All packing materials, such as tape, plastic sheets, packaging locks and tags are not part of this toy, and should be discarded for your child's safety.

ATTENTION : Pour la sécurité de votre enfant, débarrassez-vous de tous les produits d'emballage tels que rubans adhésifs, feuilles de plastique, attaches et étiquettes. Ils ne font pas partie du jouet.

NOTE: Please keep user's manual as it contains important information.

Unlock the packaging locks:

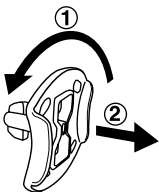

- ① Rotate the packaging lock counter-clockwise 90 degrees
- ② Pull out the packaging lock

ASSEMBLY INSTRUCTIONS

With the **VTech® Go! Go! Smart Wheels® Train Station Playset**, safety comes first. To ensure your child's safety, adult assembly is required.

ELECTRONIC STATION

1. Attach the gate railing base to the **SmartPoint™** track of the electronic station. You will hear a 'click' sound to indicate the track is secure.
2. Place the traffic light on the gate railing.

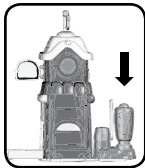
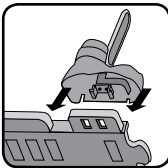

TUNNEL

1. Attach the incline to the **SmartPoint™** tunnel track. You will hear a 'click' sound to indicate the track is secure.

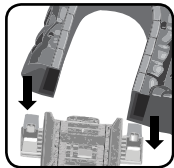

STORAGE TOWER

1. Attach the storage tower structure to its **SmartPoint™** track. You will hear a 'click' sound to indicate the structure is secure.

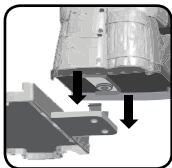

After the above steps, connect these pieces to the included track pieces. You can configure them into different arrangements.

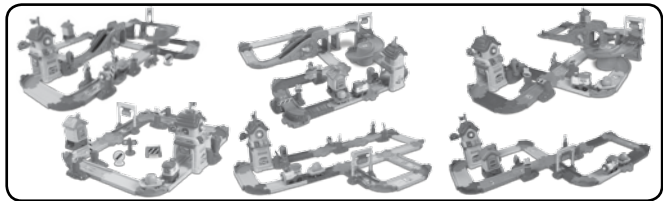

GETTING STARTED

BATTERY INSTALLATION - TRAIN

1. Make sure the unit is turned **OFF**.
2. Locate the battery cover on the bottom of the unit. Use a screwdriver to loosen the screw.
3. Install 3 new AAA (AM-4/LR03) batteries following the diagram inside the battery box. (The use of new alkaline batteries is recommended for maximum performance.)
4. Replace the battery cover and tighten the screw to secure.

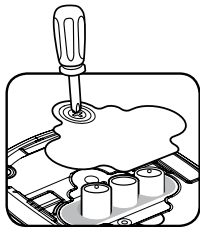

BATTERY INSTALLATION – STATION

1. Make sure the unit is turned **OFF**.
2. Locate the battery cover on the back of the station. Use a coin or a screwdriver to loosen the screw.
3. Install 2 new 'AAA' (AM-4/LR03) batteries following the diagram inside the battery box. (The use of new alkaline batteries is recommended for maximum performance.)
4. Replace the battery cover and tighten the screw to secure.

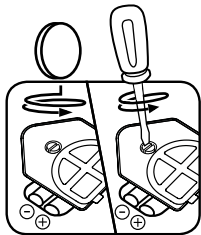



BATTERY NOTICE

- Use new alkaline batteries for maximum performance.
- Use only batteries of the same or equivalent type as recommended.
- Do not mix different types of batteries: alkaline, standard (carbon-zinc) or rechargeable (Ni-Cd, Ni-MH), or new and used batteries.
- Do not use damaged batteries.
- Insert batteries with the correct polarity.
- Do not short-circuit the battery terminals.
- Remove exhausted batteries from the toy.
- Remove batteries during long periods of non-use.
- Do not dispose of batteries in fire.
- Do not charge non-rechargeable batteries.
- Remove rechargeable batteries from the toy before charging (if removable).
- Rechargeable batteries are only to be charged under adult supervision.

PRODUCT FEATURES - TRAIN

1. ON/OFF SWITCH

To turn the unit **ON**, slide the **ON/OFF SWITCH** to the **ON** () position. To turn the unit **OFF**, slide the **ON/OFF SWITCH** to the **OFF** () position.

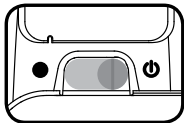

2. SMOKESTACK MOTOR BUTTON

Press the **SMOKESTACK MOTOR BUTTON** to activate the motor. Press the button again to stop the motor.



3. AUTOMATIC SHUT-OFF

To preserve battery life, the **VTech® Go! Go! Smart Wheels® Motorized Train** will automatically power-down after approximately 30 seconds without input while the motor is off. The unit can only be turned on again by pressing the light-up button or pushing the train quickly.

ACTIVITIES - TRAIN

1. Slide the **ON/OFF SWITCH** to the **ON** position to turn the unit **ON**. You will hear train sounds, a song and a phrase. The light will flash with the sounds.
2. Press the **SMOKESTACK MOTOR BUTTON** to start the motor. The train will move forward automatically, and you will hear train sounds. The light will flash with the sounds.
3. Press the **LIGHT-UP BUTTON** to hear train sounds, songs and phrases. Press and hold the **LIGHT-UP BUTTON** to stop the motor. The motor will restart after the button is released.

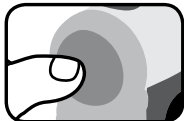
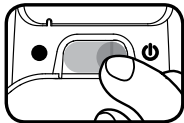

The light will flash with the sounds.

4. While the motor is off, push the train over the 10 **SmartPoint™** locations included in the playset to hear greetings, fun sounds, short tunes and sing-along songs. The light will flash with the sounds. The train also interacts with **SmartPoint™** locations on other **VTech® Go! Go! Smart Wheels®** playsets (each playset sold separately). The light will flash with sounds.
5. While the **SMOKESTACK MOTOR BUTTON** is pressed down, let the train run through the **SmartPoint™** locations to hear greetings, fun sounds, short tunes and sing-along songs. The light will flash with the sounds.

Sometimes the train will make stops along the track for added fun.

6. While the motor is off, if there is no input after approximately 8 seconds, you will hear an invitation and a sound effect. After another 8 seconds of no input, a song will play. If there is no input for an additional 8 seconds, the unit will play a short tune and then go into sleep mode. While the motor is running, you'll hear all of the above, then the train will enter sleep mode after 5 minutes of no input. The train can be re-activated by pressing the light-up button, pressing down the smokestack motor button or pushing the train quickly.

SING-ALONG SONG LYRICS

SONG 1

My train is ready,
Let's start our journey!
Choo, choo, toot, toot.
Chug along with me!

SONG 2

My train is so powerful.
Chugging along is wonderful!

SONG 3

Carrying cars short and long,

My train is really strong!

MELODY LIST:

1. I've Been Working on the Railroad
2. Jack & Jill
3. It's Raining, It's Pouring
4. Old King Cole
5. London Bridge
6. Hey Diddle Diddle
7. Polly Wolly Doodle
8. Humpty Dumpty
9. Here We Go 'Round the Mulberry Bush
10. The Glow Worm
11. This Old Man
12. Hickory Dickory Dock
13. Frère Jacques
14. Pop! Goes the Weasel
15. Hot Cross Buns
16. Pease Porridge Hot
17. Alouette

PRODUCT FEATURES – TRAIN STATION

1. OFF/VOLUME CONTROL SWITCH

To turn the unit **ON**, slide the **OFF/VOLUME CONTROL SWITCH** to the **Low** (🔊) or the **High** (🔊) Volume position. To turn the unit **OFF**, slide the **OFF/VOLUME CONTROL**

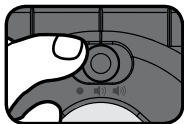

SWITCH to the **OFF** (●) position.

2. AUTOMATIC SHUT-OFF

To preserve battery life, the **VTech® Go! Go! Smart Wheels® Train Station Playset** will automatically power-down after approximately 30 seconds without input. The unit can be turned on again by any input.

ACTIVITIES

1. Slide the **OFF/VOLUME CONTROL SWITCH** to turn on the station. You will hear a song and a greeting. The light will flash with the sounds.
2. Press the **LIGHT-UP BUTTON** to hear clock sounds, songs, phrases and a short tune. The light will flash with sounds.
3. Press the **COLOR BUTTONS** to learn colors and hear phrases in English, German, Spanish and French with fun sounds, phrases and short tunes. The light will flash with sounds.
4. Push the train or let the train run through the station to activate the **FLIPPING BOARD**. You'll hear fun sounds and greetings in different languages. The light will flash with sounds.
5. If there is no input after approximately 10 seconds, you will hear a sound effect and a reminder that the train is coming. After another 10 seconds of no input, the unit will play a short tune and then go into

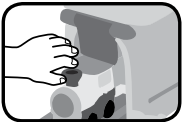
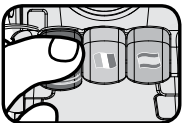
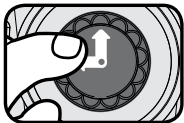
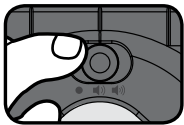

sleep mode. The unit can be re-activated by pressing any button.

SING-ALONG SONG LYRICS

SONG 1

Welcome to the station, here comes the train.

Rolling here, rolling there, rolling everywhere!

Toot-toot, chug-chug, hello, train!

SONG 2

Chug-chug, toot-toot,

The train is coming!

Hello, hello,

Have your tickets ready!

CARE & MAINTENANCE

1. Keep the unit clean by wiping it with a slightly damp cloth.
2. Keep the unit out of direct sunlight and away from any direct heat source.
3. Remove the batteries when the unit will not be in use for an extended period of time.
4. Do not drop the unit on hard surfaces and do not expose the unit to moisture or water.

TROUBLESHOOTING

If for some reason the program/activity stops working or malfunctions, please follow these steps:

1. Please turn the unit **OFF**.
2. Interrupt the power supply by removing the batteries.

3. Let the unit stand for a few minutes, then replace the batteries.
4. Turn the unit **ON**. The unit should now be ready to play again.
5. If the product still does not work, replace with a new set of batteries.

If the problem persists, please call our Consumer Services Department at 1-800-521-2010 in the U.S. or 1-877-352-8697 in Canada, and a service representative will be happy to help you.

For information on this product's warranty, please call **VTech**[®] at 1-800-521-2010 in the U.S. or 1-877-352-8697 in Canada.

IMPORTANT NOTE:

Creating and developing Infant Learning products is accompanied by a responsibility that we at **VTech**[®] take very seriously. We make every effort to ensure the accuracy of the information which forms the value of our products. However, errors sometimes can occur. It is important for you to know that we stand behind our products and encourage you to call our Consumer Services Department at 1-800-521-2010 in the U.S. or 1-877-352-8697 in Canada with any problems and/or suggestions that you might have. A service representative will be happy to help you.

NOTE:

This equipment has been tested and found to comply with the limits for a Class B digital device, pursuant to Part 15 of the FCC Rules. These limits are designed to provide reasonable protection against harmful interference in a residential installation. This equipment generates, uses and can radiate radio frequency energy and, if not installed and used in accordance with the instructions, may cause harmful interference to radio communications. However, there is no guarantee that interference will not occur in a particular installation. If this equipment does cause harmful interference to radio or television reception, which can be determined by turning the equipment off and on, the user is encouraged to try to correct the interference by one or more of the following measures:

- Reorient or relocate the receiving antenna.
- Increase the separation between the equipment and receiver.
- Connect the equipment into an outlet on a circuit different from that to which the receiver is connected.
- Consult the dealer or an experienced radio/TV technician for help.

Caution : changes or modifications not expressly approved by the party responsible for compliance could void the user's authority to operate the equipment.

