

**2018 NASPA  
Religious, Secular,  
& Spiritual  
Identities  
Conference**



**NASPA**<sup>®</sup>

Student Affairs Administrators  
in Higher Education

**December 9 - 11, 2018  
Hyatt Regency New Orleans  
New Orleans, LA**





## SUNDAY, DECEMBER 9

8:00 a.m. – 4:00 p.m.	Registration Open
9:00 a.m. – 12:00 p.m.	Half-day Morning Pre-Conference Workshops
1:00 p.m. – 2:30 p.m.	Opening Plenary
2:45 p.m. – 3:45 p.m.	General Interest Sessions I
4:00 p.m. – 5:00 p.m.	General Interest Sessions II
5:15 p.m. – 6:30 p.m.	Networking Reception

## MONDAY, DECEMBER 10

7:00 a.m. – 8:00 a.m.	Continental Breakfast
7:00 a.m. – 5:00 p.m.	Registration Open
8:30 a.m. – 9:30 a.m.	General Interest Sessions III
9:45 a.m. – 11:45 a.m.	Mini Institute Sessions
12:00 p.m. – 1:00 p.m.	Lunch on Your Own
1:00 p.m. – 2:30 p.m.	Plenary Session
2:45 p.m. – 3:45 p.m.	Roundtable Discussions & General Interest Sessions IV
4:00 p.m. – 5:00 p.m.	Exploration Sessions
5:00 p.m.	Dinner on Your Own

## TUESDAY, DECEMBER 11

7:00 a.m. – 8:00 a.m.	Continental Breakfast
7:00 a.m. – 11:00 a.m.	Registration Open
8:15 a.m. – 9:15 a.m.	General Interest Sessions V
9:30 a.m. – 10:45 a.m.	Plenary Session
11:00 a.m. – 12:00 p.m.	General Interest Sessions VI
12:00 p.m.	Conference Adjourns



# WELCOME

**NASPA WELCOMES YOU** to New Orleans and the 2018 Religious, Secular, and Spiritual Identities Conference. This conference is intended to spark thoughtful conversation, strategic action, and enhancement of professional practice towards creating more socially just and inclusive campus environments that support religious, secular, and spiritual exploration and practice.

The 2018 NASPA Religious, Secular, and Spiritual Identities Conference engages higher education faculty, administrators, students, campus ministers, chaplains, religious professionals, interfaith educators, as well as university affiliates and partners who work in and want to support religious, secular, and spiritual endeavors. We believe this conference creates a unique opportunity for critical conversations on ways we can all learn from each other, across faith and philosophy, as well as across our professional divisions. We invite you to think and engage deeply while you are here.

We are thankful to the Hyatt Regency New Orleans and the city of New Orleans for providing us with the perfect location to gather together for this conference. We hope you will take in the city's rich history, while also drawing upon it as inspiration for our pluralistic engagement with one another. Visit the registration table to learn more about local amenities and self-guided walking tours of historical New Orleans, or to sign up for the French Quarter walking tour.

This conference is an opportunity to explore your own identities as well as the complexity of the work that is needed to support students of all religious, secular, and spiritual identities. We encourage you to bring your questions, your experience, and your curiosity to the discussions, keynotes, panels, roundtables, exploration sessions, and workshops. We also highly encourage you to spend time eating and conversing together with those whom you are just meeting for the first time. We expect the 2018 NASPA Religious, Secular, and Spiritual Identities Conference to provide each of us with opportunities to expand and deepen our relationships. Welcome! We are so glad you joined us.

## A SPECIAL THANK YOU TO THE CONFERENCE PLANNING COMMITTEE

*NASPA is very thankful for the time, effort, and guidance of the conference planning committee.*

**KENZALIA BRYANT-SCOTT:** Coordinator Sr., Office of Student Engagement,  
Arizona State University West Campus

**ZACHARY COLE:** Program Manager, University Chaplaincy, Tufts University

**JOEL HARTER:** Associate University Chaplain, Elon University

**STEPHANIE KING:** Director of Civic Engagement and Knowledge Community Initiatives, NASPA

**CASEY PETERSON:** Associate Dean of Student, Brigham Young University

**MUSBAH SHAHEEN:** Assistant Residence Director, Department of Residential Life in the Arts and  
Creativity Learning Community, University of Vermont

**ROSS WANTLAND:** Director of Diversity & Social Justice Education,  
University of Illinois Urbana-Champaign

### THANK YOU TO OUR PARTNER:





# GENERAL INFORMATION

## REGISTRATION

Located in the Empire Foyer West, the RSSI Conference registration is open during the following hours:

**Saturday, December 8: 3:00 p.m. – 5:00 p.m.**

**Sunday, December 9: 8:00 a.m. – 4:00 p.m.**

**Monday, December 10: 7:00 a.m. – 5:00 p.m.**

**Tuesday, December 11: 7:00 a.m. – 11:00 a.m.**

## CONFERENCE LOCATION

All RSSI Conference activities will be held at the Hyatt Regency New Orleans and are open to conference participants only.

**Hyatt Regency New Orleans:** 601 Loyola Ave, New Orleans, LA 70113

**Phone:** 504.561.1234

## ALL GENDER RESTROOM

This restroom is safe for transgender, gender non-binary, genderqueer people, as well as people of all gender identities and expressions. NASPA provides this space as part of our shared commitment to inclusivity.

If you choose to use this restroom, please be aware that it is a safe space. Please refrain from gender policing (i.e. scrutinizing, judging, or categorizing another person's gender).

## ATTIRE

Attire for the RSSI Conference is business casual.

## ACCESSIBILITY/DIETARY NEEDS

If you have an accommodation request, dietary concerns, or questions, please speak with the meeting staff at the RSSI Conference registration desk.

## CELL PHONES

As a courtesy to presenters, speakers, panelists and attendees, please turn off cell phones during program sessions. Please leave the session room if you must take a call.

## HYATT REGENCY NEW ORLEANS MAPS

A map of the meeting space can be found at the back of the program book.

## EXHIBITORS

Please visit the meeting exhibitor tables during the conference during the same hours as registration. Exhibits will be open in the Ballroom Lobby. A complete listing of conference exhibitors is located in the back of the program book.

## EVALUATION

The 2018 RSSI Conference evaluation will be available online following the conclusion of the conference and will be sent via email to all participants.

## LOST AND FOUND

Lost and found articles should be turned into the RSSI Conference registration desk.

## MATERIALS

Session materials will be posted to the NASPA Professional Development Archive of the NASPA website. To view the program materials, log in using the credentials you used at the time of registration and select 2018 NASPA Religious, Secular, and Spiritual Identities Conference under Current National Events. You will then see a listing of program titles which are hyperlinked to uploaded materials. Presentations are available as they are uploaded from presenters. Presentation materials are also available in the mobile app.

## NASPA MOBILE APP

Welcome to the new My NASPA mobile app. Our new mobile app is a single download that gives you access to select NASPA events. Enhance your event experience by creating your own itinerary, reading up on speakers, sponsors, and exhibitors, connecting with event attendees through the interactive “Handshake” and “Wall” features, and navigating the event space with interactive maps. The new My NASPA mobile app is a one stop shop for all of your event needs! Download Instructions:

1. Visit the Apple App Store or Google Play Store and search “My NASPA”
2. Once the app is installed, select “Sign Up” and create your “Profile”
3. Search your event name in the search bar
4. Select “Join Now” and enter your event passphrase (#RSSIConference), if applicable

## NAME BADGES

Conference badges are required to participate in sessions and any meals provided throughout RSSI Conference. Your badge not only indicates that you are fully registered for the conference, but serves to build community among attendees.

## NURSING ROOMS

There is a nursing room available for participants to utilize. To access this room, please stop by registration for details.

## PUBLICATIONS

NASPA offers a variety of publications to support student affairs educators and community members in regarding to student learning and development. As an attendee of the NASPA Religious, Secular, and Spiritual Identities Conference you can use **promo code: RSSI18 to receive 20% off your total order**. This discount is available for use December 8, 2018 to January 31, 2019. To view the full list of NASPA publications visit: <https://www.naspa.org/publications>. \*Notes: Excludes shipping. Cannot be combined with other offers.

## SOCIAL MEDIA

Join in on the conversation via Twitter and Instagram! Participants should use **#RSSIConference** as the hashtag for the event. For all the latest tweets and photos, be sure to follow the official NASPA handles **@NASPAtweets** and **@NASPApics**.

## WI-FI

There will be free Wi-Fi in the meeting areas. The information to connect in the meeting space is **Network: @Hyatt\_Meeting Passcode: NASPA2018**

Note: The Wi-Fi doesn't carry over from your room to the meeting space. You will have to toggle between the two as you move about the hotel.

# PERSONALIZE YOUR EXPERIENCE

## PROFESSIONAL COMPETENCIES FOR STUDENT AFFAIRS PRACTITIONERS

In July 2015, the NASPA Board of Directors approved Professional Competency Areas for Student Affairs Practitioners. The set of professional competency areas is intended to define the broad professional knowledge, skills, and in some cases, the attitudes expected of student affairs professionals regardless of their area of specialization or positional role within the field. Within the conference program, sessions that fall into particular competency areas are marked with the icons as indicated below.



Advising and Supporting



Assessment, Evaluation, and Research



Law, Policy, and Governance



Leadership



Organizational and Human Resources



Personal and Ethical Foundations



Social Justice and Inclusion



Student Learning and Development



Technology



Values, Philosophy, and History

Follow us on Twitter  
**@NASPATweets, Instagram**  
**@NASPAPics** and tag  
**#RSSIConference!**





Check out this assortment of session types to create a holistic experience at the 2018 NASPA Religious, Secular, and Spiritual Identities Conference:

## **GENERAL INTEREST SESSION**

A 60-minute which might include programs or papers on scholarship, research, campus and/or community programs, partnerships, and background information.

## **MINI-INSTITUTE**

A 120-minute highly interactive session that teaches promising practices to enhance religious, secular, and spiritual identity development in the classroom, on campus, and/or in the community.

## **EXPLORATION SESSION**

A 60-minute presenter-facilitated exploration of religious, secular, and spiritual identities that might include prayer, ritual, tradition, meditation, or embodied experience session for participants to experience different practices of faiths, beliefs, and identities.

## **ROUNDTABLE REFLECTION**

A 60-minute presenter-facilitated discussion that allows participants to more deeply engage with an idea, program, research, or to reflect on their conference experience unencumbered by technology. Roundtable Reflection sessions will occur simultaneously in the plenary space.

**Abdullah Antepli****Chief Representative of Muslim Affairs and Adjunct Faculty of Islamic Studies, Duke University**

Imam Abdullah Antepli completed his basic training and education in his native Turkey. From 1996-2003 he worked on a variety of faith-based humanitarian and relief projects in Myanmar (Burma) and Malaysia with the Association of Social and Economic Solidarity with Pacific Countries. He is the founder and executive board member of the Association of College Muslim Chaplains (ACMC) and a board member of the Association for College and University Religious Affairs (ACURA). From 2003 to 2005 he served as the first Muslim chaplain at Wesleyan University. He then moved to Hartford Seminary in Connecticut, where he was the associate director of the Islamic Chaplaincy Program & Interfaith Relations, as well as an adjunct faculty member.

He previously served as Duke University first Muslim chaplain from July 2008 to 2014. In his current work at Duke, Antepli engages students, faculty, and staff across and beyond campus through seminars, panels, and other avenues to provide a Muslim voice and perspective to the discussions of faith, spirituality, social justice, and more. Imam Antepli also serves as a faculty member in the Duke Divinity School, teaching a variety of courses on Islam and Muslim cultures.

Read “Divine Intervention: The Miraculous Journey of Abdullah Antepli” from the Winter 2011 issue of DIVINITY Magazine.

**Jennifer Bailey****Founder and Executive Director, Faith Matters Network**

Named one of 15 Faith Leaders to Watch by the Center for American Progress, Rev. Jennifer Bailey is an ordained minister, public theologian, and emerging national leader in multi-faith movement for justice. She is the Founder and Executive Director of the Faith Matters Network, a Womanist-led organization equipping community organizers, faith leaders, and activists with resources for connection, spiritual sustainability, and accompaniment.. Jennifer comes to this work with nearly a decade of experience at nonprofits combatting intergenerational poverty. Rev. Bailey is an ordained itinerant elder in the African Methodist Episcopal Church.

An Ashoka Fellow, Nathan Cummings Foundation Fellow, On Being Fellow and Truman Scholar, Jennifer earned degrees from Tufts University and Vanderbilt University Divinity School where she was awarded the Wilbur F. Tillet Prize for accomplishments in the study of theology. She writes for a number of publications including On Being, Sojourners, and the Huffington Post. Rev. Bailey enjoys good food, dancing like no one is watching, and road trip adventures with her husband, psychotherapist and religious studies scholar Ira Helderman.

**Mary Ellen Geiss****Senior Director of Co-curricular Partnerships, Interfaith Youth Core**

Mary Ellen Geiss is senior director of co-curricular partnerships at Interfaith Youth Core, where she has served in a variety of programmatic and strategic roles over the past decade. She currently oversees IFYC’s strategy supporting campus educators committed to interfaith work, manages IFYC’s organizational evaluation strategy, and serves on the leadership team for IDEALS, a five-year longitudinal research project examining collegiate experiences of religious diversity. Mary Ellen’s past work with IFYC includes managing a multi-year partnership with the White House through the President’s Interfaith and Community Service Campus Challenge, conducting on-

campus consultations and trainings to support institutional interfaith efforts, and presenting and writing nationally on behalf of the organization.

## GEISS, CONT'D

Her forthcoming edited volume (co-edited with Kathleen M. Goodman and Eboo Patel), *Educating about Religious Diversity and Interfaith Engagement: A Handbook for Student Affairs*, will be released in January 2019. Mary Ellen earned her Master's in Religion and Government at Harvard Divinity School and her B.A. in Religious Studies at the University of North Carolina at Chapel Hill.



### **Monica Nixon**

#### **Assistant Vice President for Equity, Inclusion, and Social Justice, NASPA**

Monica Nixon serves as NASPA's Assistant Vice President for Equity, Inclusion, and Social Justice. Previously she served as Assistant Provost for Inclusion and Diversity/ Chief Diversity Officer at Saint Joseph's University; Assistant Vice President for Student Development and Director of Multicultural Affairs at Seattle University; Director of the ALANA Cultural Center and Assistant Director in the Center for Leadership and Student Engagement at Colgate University; as Associate Director for Student Services at the University of Puget Sound; and as Assistant to the Executive Vice President and Assistant Director of Orientation and New Student Programs at the University of Virginia.

Monica received her M.Ed. in Counselor Education in 1999 and B.A. in English 1995 from the University of Virginia. In 2013 she earned an Ed.D. in Educational Leadership and Policy Studies from the University of Washington, where her dissertation focused on the positionality and agency of women of color chief diversity officers in higher education institutions; an article about this research was published in 2016 in the *Journal of Diversity in Higher Education*. Monica also co-authored a chapter in the 2012 NASPA-published book *Asian Americans and Pacific Islanders in Higher Education* and has served actively with NASPA – Student Affairs Administrators in Higher Education, ACPA – College Student Educators International, and the National Association of Diversity Officers in Higher Education.



### **Czarina Ramsay**

#### **Assistant Dean of Ethnic & Intercultural Student Services (EIS), Loyola Marymount University**

Czarina Ramsay is the Assistant Dean of Ethnic & Intercultural Student Services (EIS) at Loyola Marymount University (LMU). As Assistant Dean, Czarina works with a team of directors and campus leaders to promote and inclusive learning environment for all students, particularly for those from underrepresented populations. Through the efforts of EIS, students receive resources to enhance their intercultural awareness and skills focused on identity development and civic leadership.

Czarina's professional experience cover twelve years within higher education. Previously, she has served as the director for the Office of Multicultural Affairs at Seattle University and the Office of Intercultural Engagement at the University of Puget Sound. Czarina also has a background in housing, serving as an Assistant Director for the Office of Multicultural Affairs and Resident Director for Xavier Hall at Seattle University. She is an alumna of the University of Puget Sound, where she received her B.A. in cultural anthropology and she earned a M.Ed. in Higher Education and Student Affairs Administration from The University of Vermont.

In addition to her campus roles, Czarina was a member of the NASPA Undergraduate Fellowship Program (NUFP) Board, a member of the NASPA Excellence Awards committee, the 2006-2007 NASPA Region V Outstanding New Professional recipient, and 2009 ACPA Annuity Coeptis Emerging Professional.

Czarina is originally from Panama City, Panama, and grew up in Anchorage, Alaska. Czarina can be found enjoying time with family and friends, reading, designing jewelry, and planning her next travel destination.

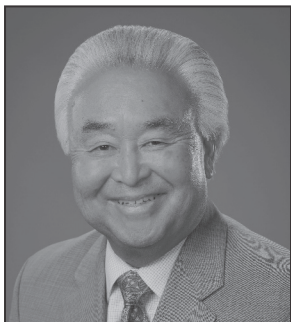

## **Mike Segawa**

### **Vice President for Student Affairs, Pitzer College**

Mike Segawa was appointed the Vice President for Student Affairs at Pitzer College in August. Prior to that he served as the interim dean of students at the University of Nevada, Reno. Previously, he was vice president for student affairs and dean of students from 2007 to 2017 at the University of Puget Sound. He also worked in student affairs at The Evergreen State College, University of Washington, and Central Missouri State University. In these roles he has supervised residence life/housing, counseling and health services, intercultural engagement services, spirituality and civic engagement, student activities, student center operations, Greek life, orientation, outdoor programs, student conduct, sexual assault prevention programs, intercollegiate and recreational sports, assessment, career services, and academic support services. Mike was a member of NASPA's national Board of Directors for 10 years and served as the association's president from 2009 to 2010. He co-chaired the 2007 Joint ACPA/NASPA Meeting, chaired the 2001 National Conference and served in numerous regional roles. He has been active in other student affairs professional organizations, including American College Personnel Association and the Association of College and University Housing Officers International. Mike holds a master's degree in education for college student personnel administration from Colorado State University and a bachelor's degree in political science from the University of California, Irvine.



## **Reverend Dave Wright**

### **Director for Spiritual Life and Civic Engagement, University Chaplain, University of Puget Sound**

Rev. Dave Wright (him/they) serves as the University Chaplain and Director for Spiritual Life and Civic Engagement at the University of Puget Sound in Tacoma, Washington. He is a former executive board member of the National Association of College and University Chaplains, and Past President of the Association of College and University Affairs. In 2018, the NASPA Spirituality and Religion in Higher Education Knowledge Community recognized Dave as their Outstanding Professional of the Year. As co-founder and co-director of Puget Sound's Center for Intercultural and Civic Engagement, Dave continues to work to engage interfaith work on campus both with other social identity related communities as well as political and social efforts rooted in identity, values, and liberation. Their folio at Puget Sound includes leading efforts on both interfaith and faith-specific programs and support, assisting in diversity/inclusion/equity efforts, coordinating the institution's suicide prevention efforts, and convening an ongoing work group related to support for undocumented students. Outside of campus, Dave is completing nine years of service on the board of Tacoma Community House, a non-profit service provider offering education, job placement, ELL, and other programs targeted towards immigrants, refugees, and asylum seekers. An ordained clergyperson in the United Methodist Church, they are currently the Peace with Justice Coordinator for the Pacific Northwest regional body of that denomination, and has worked regionally and nationally with a range of efforts to challenge the denomination to work towards inclusivity and liberation for all people.



*Empire Foyer West* | 8:00 a.m. – 4:00 p.m.

**Registration Open**

## **PRE-CONFERENCE WORKSHOPS** | 9:00 a.m. – 12:00 p.m.

*Strand 12A* | 9:00 a.m. – 12:00 p.m.

### **Embedding Interfaith Learning into Curricular and Co-curricular Spaces (Sponsored by IFYC; Registration required)**

PRESENTER: **Janett Cordovés**, co-curricular partnerships manager, Interfaith Youth Core

This pre-conference opportunity will focus on integrating interfaith components into curricular and co-curricular spaces. Through presentations from Interfaith Youth Core and campus leaders, the session will explore concrete tactics to guide collaborative curriculum development toward interfaith learning, prepare and support faculty and staff to teach, and lead and facilitate conversations around worldview diversity productively. Highlighting national research from IDEALS and promising pedagogical practices for the field, this session will provide participants with opportunities to consider their own pedagogy, course development strategies, programs, and goals for creating or revising curricular and co-curricular offerings. The session will address emerging trends and challenges from recently-created courses and programs to assist participants in working through their own institutional context and already-existing campus assets to facilitate a curriculum that prioritizes engaging worldview diversity and interfaith cooperation. Participants looking to improve existing programs or plan new initiatives are all welcome to join.



*Strand 11B* | 9:00 a.m. – 12:00 p.m.

### **Power, Privilege, and Oppression: Facing Christian Hegemony in Higher Education (Registration required)**

PRESENTERS: **Joseph Pritchett**, director, office of faith and meaning, Franklin and Marshall College  
**J.T. Snipes**, assistant professor, department of educational leadership, Southern Illinois University Edwardsville  
**Reverend J. Cody Nielsen**, founder and executive director, Convergence

This pre-conference opportunity will focus on the transformative moment in higher education for increasing the diversity of religious, secular, and spiritual identities. Created first by Christian denominations, and later heavily influenced by cultural norms in the public square, higher education has been molded and shaped by a single religious tradition – Christianity. From the dominance of Protestant chaplaincy to the university calendar, the lack of institutional policies and practices have reified the marginality of religiously minoritized identities, producing an increased strain on the field of higher education as the United States navigates a contentious yet possibly transformative moment for the diverse religious, secular, and spiritual identities.



# SUNDAY, DECEMBER 9

*Strand 11A* | 9:00 a.m. – 12:00 p.m.

## **Religion, Secularism and Spirituality in NASPA: Where We've Been, Where We Are, And Where We're Going (Registration required)**

PRESENTERS:           **Zachary Cole**, program manager, University Chaplaincy, Tufts University  
                              **Reverend Amy Fisher**, university chaplain and director, interfaith center, Suffolk University  
                              **Sable Manson**, assistant director, student leadership & development (Joint Educational Project), University of Southern California  
                              **Ross Wantland**, director of diversity & social justice education, University of Illinois at Urbana-Champaign

This pre-conference opportunity will focus on exploring the work of secularism, spirituality, and religious identities in NASPA's next 100 years. As NASPA celebrates its 100th anniversary, the Spiritually and Religion in Higher Education Knowledge Community is looking back at "Where We've Been" by examining the historical context of religious [and spirituality] movements in American history and on college campuses. Throughout this session, facilitators will explore with participants "Where We Are" by looking at interfaith assessment, social justice work, #DigitalFaith, and multifaith spaces at colleges and universities. Additionally, the presenters will look ahead with attendees at "Where We're Going" through a panel of nationally recognized leaders in religion, spirituality, and secular engagement.

## **LUNCH ON YOUR OWN | 12:00 p.m. – 1:15 p.m.**

*Empire D* | 1:15 p.m. – 2:30 p.m.

## **OPENING PLENARY | Bridging Difference in Divisive Times: Lessons from the People's Supper**

SPEAKER:               **Jennifer Bailey**, founder and executive director, Faith Matters Network

Hungry for change in your communities? For millennia, sharing a meal has stood as one of the few things that all of us—whoever we are and wherever we come from—have in common. At The People's Supper, we believe that to be welcome – to feel wholly at ease in our own skin, to be fully seen and heard and witnessed – is a basic right. Since January 2017, we have hosted over 1,200 suppers in 120 communities nationwide bridging across lines of political, generational, racial and identity differences. Along the way we have learned that the first step in cultivating these spaces is to embrace vulnerability, which requires deep courage. Join us to hear some key insights we have learned along the way and also walk away with a set of tools to take back to your community.



## GENERAL INTEREST SESSIONS I | 2:45 p.m. – 3:45 p.m.

*Strand 10B* | 2:45 p.m. – 3:45 p.m.

### **Connecting Students' Religious and Spiritual Identities to their Civic Identities**

COMPETENCY: **leadership**

AUDIENCE: **student affairs professionals**

PRESENTER: **Katherine Smanik**, chaplain and assistant dean of civic engagement, DePauw University

This workshop is designed to help participants think through the way the history of Christian evangelism/mission work created a disconnect between religious/spiritual identities and civic identity. After reviewing this history we will explore research on the link between religion/spirituality and service. Then together we will come up with new ways to help students reconnect their religious/spiritual identities with their civic identities so that they see religious/spiritual communities as sites of civic engagement.

*Strand 12A* | 2:45 p.m. – 3:45 p.m.

### **Creating Communities of Meaning and Practice for Non-religious Students**

COMPETENCY: **personal and ethical foundations**

AUDIENCE: **student affairs professionals**

PRESENTER: **Ryan Bell**, national organizing manager, Secular Student Alliance

One-third of college-aged people are non-religious and yet, most colleges and universities do not have resources to assist these students in their moral and ethical development because these engagements are still largely confined to a religious framework. Participants will understand the need for communities of meaning and practice that are distinct and separate from religious beliefs and dogma, learn how the Secular Student Alliance develops student leaders to create community, and understand the benefits to the overall campus climate.

*Strand 11B* | 2:45 p.m. – 3:45 p.m.

### **Cultivating Campus Partnerships to Foster Civic and Interfaith Engagement**

COMPETENCY: **social justice and inclusion**

AUDIENCE: **student affairs professionals**

PRESENTERS: **Michael Jones**, student engagement and service manager, Washington University in St. Louis  
**Purvi Patel**, assistant director, center for diversity & inclusion, Washington University in St. Louis

Religious and spiritual activity has increasingly played a role in nurturing aspects of purpose, identity, and meaning making within the realm of civic engagement among college students. Research shows when students are provided an avenue to engage in forms of service learning, they become more concerned with the world around them (Chickering, 2006). The presenters' objective is to promote a sustainable model of interfaith religious activity playing an active role in increasing civic engagement among college students, faculty, and staff alike.





# SUNDAY, DECEMBER 9

*Strand 11A* | 2:45 p.m. – 3:45 p.m.

## **Walking the Tight Rope: Title IX, Sexual Misconduct, and Faith**

COMPETENCY: **organizational and human resources**

AUDIENCE: **student affairs professionals**

PRESENTERS: **Jared Rasband**, deputy title IX coordinator for training and education, Brigham Young University  
**Tiffany Turley**, title IX coordinator, Brigham Young University  
**Marcus Williams**, deputy title IX coordinator for investigations, Brigham Young University

What are the primary challenges in building an equitable process and appropriate response to sexual violence in a Title IX Office at a faith-based university? Presenters from the Title IX Office at BYU will explore how they navigate the intricate path of effectively responding to sexual violence in a faith-based environment. Participants will gain an increased understanding of how to incorporate current best practices in prevention and response to sexual violence in a way that is consistent with community values.

## **GENERAL INTEREST SESSIONS II** | 4:00 p.m. – 5:00 p.m.

*Strand 10A* | 4:00 p.m. – 5:00 p.m.

## **A Higher (Education) Calling: Engaging Religion & Spirituality in a Public Institution**

COMPETENCY: **social justice and inclusion**

AUDIENCE: **student affairs professionals**

PRESENTER: **Ross Wantland**, director of diversity & social justice education, University of Illinois at Urbana-Champaign

Caught between “church” and state, many professionals lack preparation (and perhaps permission) to engage in dialogue and planning about spirituality, religion, and secularism on campus. This session will discuss strategies utilized at public institutions to deepen institutional leadership and bring student leaders, college personnel, and religious workers together to enhance interfaith collaboration and literacy — and carve new pathways for our practice.







*Strand 11B* | 4:00 p.m. – 5:00 p.m.

## **Mind, Body, Soul: Promoting Religious Diversity and Inclusion in Higher Learning Settings**

COMPETENCY: **student learning and development**

AUDIENCE: **graduate students**

PRESENTERS: **Jerry Clark**, chief student affairs officer, The University of Mississippi Medical Center  
**Richelle Jefferson**, student chaplain, The University of Mississippi Medical Center  
**Edgar Meyer**, graduate assistant, student body president, and faith forum coordinator, The University of Mississippi Medical Center  
**Juanyce Taylor**, chief diversity and inclusion officer, The University of Mississippi Medical Center  
**Doris Whitaker**, head chaplain and director of pastoral services, The University of Mississippi Medical Center

In the U.S., promotion of diversity and inclusion on college and university campuses is becoming increasingly important, especially for the celebration of the religious, secular, and spiritual identities of students, faculty, and staff. This program will feature student-led efforts conducted at the University of Mississippi Medical Center to educate faculty, staff, and students about various religious traditions and engagement among health professional students in the spiritual aspects of healthcare and to explain how such knowledge impacts intergroup and patient interactions.

*Strand 11A* | 4:00 p.m. – 5:00 p.m.

## **Religious Identity and its Connection to Cultural Identity Among Minority & International Students: Organization, Management, and Programming Response**

COMPETENCY: **student learning and development**

AUDIENCE: **student affairs professionals**

PRESENTER: **Kanika Magee**, reverend, Howard University

In a shifting national religious landscape, the differences between culture-based religious experience become more pronounced. The impact on ethnic and racial minorities and international students is substantive. Student affairs professionals will gain insight to equip them to understand the resource needs related to religious identity, its connections to culture among minority populations, and opportunities to build connections amidst this diversity while still affirming and supporting religious identity.

*Strand 12A* | 4:00 p.m. – 5:00 p.m.

## **The Spirituality Campus Climate for Diverse Learners**

COMPETENCY: **assessment, evaluation & research**

AUDIENCE: **student affairs professionals**

PRESENTER: **Kevin Fosnacht**, associate research scientist, Indiana University

This session will overview three research studies that analyzed the spirituality campus climate for a diverse, multi-institution sample of undergraduates. The first study examined how two aspects of the spirituality campus climate, students' comfort in expressing their spiritual beliefs and perceptions of the respect for their beliefs on campus, were related to perceptions of the overall campus climate. The second study investigated how students' religion and institution type were related to the spirituality campus climate. The final study examined the correlates of being the victim of an act of religious intolerance on campus. Student affairs professionals will learn how they can utilize the studies' findings to improve the spiritual campus climate on their campuses.





# SUNDAY, DECEMBER 9

*Strand 10B* | 4:00 p.m. – 5:00 p.m.

## **The Atheist Identity in the Higher Education Workplace**

COMPETENCY: **social justice and inclusion**

AUDIENCE: **student affairs professionals**

PRESENTER: **Carrie Reisner**, assistant vice chancellor for student engagement,  
Indiana University East

While a growing body of research has focused on the experiences of non-religious students in higher education, less attention has been paid to those who work in higher education and identify as atheists. This presentation will detail a dissertation study which examined how professional staff members who identify as atheists experience their identity in the higher education workplace. The phenomenological study included an exploration of stigma management and the presence of Christian privilege in the higher education environment.

*8 Block Kitchen & Bar* | 5:15 p.m. – 6:30 p.m.

## **NETWORKING RECEPTION**

Join attendees of the #RSSIConference for a happy-hour like reception where hors d'oeuvres will be served and a cash-bar will be available.

**DINNER ON YOUR OWN** | 6:30 p.m.



*Empire Foyer West* | 7:00 a.m. – 5:00 p.m.  
**Registration Open**

*Empire C* | 7:00 a.m. – 8:00 a.m.

## **CONTINENTAL BREAKFAST**

### **GENERAL INTEREST SESSIONS III | 8:30 a.m. – 9:30 a.m.**

*Strand 10B* | 8:30 a.m. – 9:30 a.m.

#### **CAFE (Conversation, Action, Faith, and Education): A Path to Creating Interfaith-inspired Civic Engagement on College Campuses**

COMPETENCY: **social justice and inclusion**

AUDIENCE: **student affairs professionals**

PRESENTERS: **Shelby Carpenter**, CAFE pre-orientation student coordinator, Tufts University  
**Zachary Cole**, program manager, university chaplaincy, Tufts University

This session outlines the CAFE Pre-Orientation program at Tufts University, which seeks to welcome, gather, equip, and network the leaders of each incoming class committed to mutual inspiration and to making positive change. The presenter will introduce the philosophical and scholarly foundations for CAFE, as well as share strategies for implementing interfaith-inspired civic engagement programs. The presenters will emphasize the belief that student affairs professionals can utilize aspects of this program on their own campuses to expand students' sense of belonging, identity development, and civic action.

*Strand 10A* | 8:30 a.m. – 9:30 a.m.

#### **Engaging the Spiritual but not Religious in Worldview Conversations**

COMPETENCY: **social justice and inclusion**

AUDIENCE: **student affairs professionals**

PRESENTERS: **Janett Cordovés**, co-curricular partnerships manager, Interfaith Youth Core  
**Vanessa Gomez Brake**, associate dean of religious life, University of Southern California

Over the past several years, college students self-identifying as spiritual, but not religious have been flooding our campuses. Despite this increase in numbers, professionals have exhibited an inability to find resources to assist them in engaging this very important element of identity. This conversation will discuss emerging research from the Interfaith Diversity Experiences & Attitudes Longitudinal Survey (IDEALS), a national study examining how undergraduate students from across the country engage with religious, non-religious, and spiritual diversity while in college. This presentation is an opportunity to increase one's confidence in discussing secular, seeker, and non-conforming worldviews; understanding how theo-normativity impacts the social engagement of non-religious students, build capacity to be of service and support to students of these diverse worldviews.





# MONDAY, DECEMBER 10

*Strand 12B* | 8:30 a.m. – 9:30 a.m.

## **Prayer Rugs, Steeples, and Trenches: Engaging with Religious and Spiritual Life Leadership in the 21st Century**

COMPETENCY: **leadership**

AUDIENCE: **student affairs professionals**

PRESENTERS: **Reverend Jackie Marquez**, associate university chaplain, Northwestern University  
**Reverend Deanna Shorb**, dean of religious life and chaplain, Grinnell College  
**Abdullah Antelpi**, chief representative of Muslim affairs and adjunct faculty of Islamic studies, Duke University  
**Ryan Bell**, national organizing manager, Secular Student Alliance  
**Reverend Joanne Sanders**, associate dean for religious life, Stanford University

Recognizing the influence of religion and spirituality within higher education, several institutions have assigned personnel to guide religious and spiritual affairs for the sake of their educational mission. This session includes four religious leaders, each assigned to nurture religious and spiritual life on their respective campuses, seeking to share their thoughts on how to best support pluralistic, inclusive approaches to claiming the role of religion, spirituality, and ethical identity as important parts of the intersecting identities of today's students.

*Strand 11A* | 8:30 a.m. – 9:30 a.m.

## **Ripple Interfaith Conference: Developing and Empowering College Students as Interfaith Leaders**

COMPETENCY: **leadership**

AUDIENCE: **student affairs professionals**

PRESENTERS: **Carolina Seigler**, multifaith coordinator, Elon University  
**Joel Harter**, associate university chaplain, Elon University

Ripple is a student-led interfaith conference hosted by Elon University that grew from 50 participants in 2016 to 150 participants in 2018 from 20 colleges and universities, representing diverse religious, spiritual, and secular identities. The goal of Ripple is to empower and develop student interfaith leaders with breakout sessions, religious and spiritual practices, community groups, and a service project led almost entirely by students. This session will share learning outcomes with practical training on how to develop similar programs that empower student interfaith leadership.

*Strand 12A* | 8:30 a.m. – 9:30 a.m.

## **Sabbath Practices in College: An Opportunity to Challenge an Economy of Scarcity**

COMPETENCY: **student learning and development**

AUDIENCE: **student affairs professionals**

PRESENTER: **Emmy Edwards**, graduate assistant program director of the honors residential college, Baylor University

Sabbath practices, the Jewish and Christian discipline of weekly rest in reflection of the rhythms of the Creation story, can open college students' eyes to healthy life tempos and to resistance of a demanding economy of scarcity. This program will explore the developmental potential and accessibility of Sabbath practices





for university students. Student affairs professionals can explore the theoretical support for the benefit to students and explore the challenges in campus cultures, demonstrated in Baylor's Honors Residential College's student leadership's Sabbath programming.



*Strand 11B* | 8:30 a.m. – 9:30 a.m.

## **Separation of Church and State and Student Affairs**

COMPETENCY: **law, policy, and governance**

AUDIENCE: **student affairs professionals**

PRESENTER: **Gordon Maples**, graduate assistant, office of the university chaplain & religious life, Vanderbilt University

The line of separation between church and state is often blurry and the laws around it hard to understand. In this session, participants will learn how to effectively engage in programs and services for college students of all secular, spiritual, and religious identities on their campuses, without worrying about stumbling over the often confusing boundary between church and state. Examples of successful past campus programs, as well as those that have crossed into violations, will be explored and discussed.

## **MINI-INSTITUTE SESSIONS** | 9:45 a.m. – 11:45 a.m.



*Strand 11B* | 9:45 a.m. – 11:45 a.m.

## **Case Study: Navigating Tensions Between Religious, Spiritual, and Secular Identities**

COMPETENCY: **social justice and inclusion**

AUDIENCE: **student affairs professionals**

PRESENTERS: **Mary Ellen Giess**, senior director of co-curricular partnerships, Interfaith Youth Core  
**Rebecca Russo**, director of campus stewardship, Interfaith Youth Core

How should educators navigate circumstances where competing truth claims or values come into conflict? In a time of deep societal division, navigating the complexities of religious, spiritual, and secular identities takes on particular challenge and often requires relational strategies that uphold campus values while empowering all involved. Using case study methodology, we will explore how professionals can use principles of religious pluralism to navigate challenging situations where different religious, spiritual, and secular identities come into direct tension with one another.



*Strand 10A* | 9:45 a.m. – 11:45 a.m.

## **Inviting Student Leaders to Dream**

COMPETENCY: **advising and supporting**

AUDIENCE: **university chaplains, campus ministers, and religious professionals**

PRESENTER: **Jimmy Walters**, director of residence ministry and catholic scholars program, St. John's University



# MONDAY, DECEMBER 10



This interactive session introduces techniques inspired by Appreciative Inquiry and Appreciative Advising that invites the participants into re-imagining their vocation. Focusing on the “Dream” step in the organizational model, participants will recapture their vocational call while learning strategies to use with their students to support their discernment, student leadership, and faith experiences.

**Strand 10B | 9:45 a.m. – 11:45 a.m.**

## **Muslim College Students at the Intersection of Laws, Politics, and Religion**

COMPETENCY: **social justice and inclusion**

AUDIENCE: **student affairs professionals**

PRESENTERS: **Shafiqah Ahmadi**, associate professor of clinical education, University of Southern California  
**Darnell Cole**, associate professor, University of Southern California

In the current political climate, with the issuance of the Travel Ban (Muslim Ban) by the Trump Administration and the Supreme Court affirming parts of the Muslim Ban, it is evident that the intersection of law, politics, and religion are inextricably intertwined. This institute will give an overview of Islamophobia and how it is institutionalized by laws and policies on college campuses. It will examine negative effects of Islamophobia on Muslim students’ experiences and provide recommendations.



**Strand 11A | 9:45 a.m. – 11:45 a.m.**

## **‘Walking the Tightrope While Holding the End’: Creating Spaces for Religious, Spiritual, and Secular Convergence from the Periphery**

COMPETENCY: **social justice and inclusion**

AUDIENCE: **student affairs professionals**

PRESENTERS: **Simran Kaur**, graduate assistant, office of diversity affairs, Miami University  
**Suzanne Klatt**, director, mindfulness and contemplative inquiry center, Miami University  
**Hannah Stohry**, graduate assistant, mindfulness and contemplative inquiry center, Miami University  
**Sara Williams**, associate director of community-engaged learning, Miami University

Many higher education professionals creating programming across religious, spiritual, and secular difference find themselves at the peripheries of power structures. In this interactive session, presenters will share their experience developing spaces of engagement across worldview difference from the peripheries. Through interactive activities, participants are invited to reflect on their own balancing act in the context of institutional power structures and to engage with concrete strategies for working effectively from the periphery to create a climate of inclusion on their campuses.

**LUNCH ON YOUR OWN | 11:45 a.m. – 1:00 p.m.**



*Empire D* | 1:15 p.m. – 2:30 p.m.

## **PLENARY | Mapping Our Engagement: Community Exploration of Religious, Secular, and Spiritual Identities in Higher Education**

**SPEAKERS:** **Mary Ellen Geiss**, senior director of co-curricular partnerships, Interfaith Youth Core  
**Monica Nixon**, assistant vice president for equity, inclusion, and social justice, NASPA, founder and executive director, Faith Matters Network

Exploration of self is a critical component of developing self-efficacy and agency, which is instrumental in how we show up in professional roles and in our communities. As associations that primarily focus on higher education institutions, NASPA and Interfaith Youth Core (IFYC) understand that there is an opportunity to assist individuals in such explorations. By acting as conduits, we can facilitate conversations among persons who have like-minded and differing opinions, highlight current research and gaps in study, and provide promising practices and programs related to various components of the collegiate experience. To further understand and support individuals and institutions in the topics and identities of religious, secular, and spiritual persons, NASPA and IFYC staff will guide attendees through an exercise of exploration in seeking to understand differing viewpoints and needs of the #RSSIConference constituents.

## **GENERAL INTEREST SESSIONS IV | 2:45 p.m. – 3:45 p.m.**

*Strand 12A* | 2:45 p.m. – 3:45 p.m.

### **A Balancing Act: Addressing Intersectionality of Religious and Cultural Identities in the 'Postcolonial' Native American Community**

**COMPETENCY:** social justice and inclusion  
**AUDIENCE:** student affairs professionals  
**PRESENTER:** **Alexandra Sullivan**, graduate religious diversity educator, New York University

The presenter of this session will show examples of a religious/spiritual identity that has been undeniably influenced by a cultural one and how the two intertwine in living, breathing ways. The presenter will focus on Native American cultural practices, Christian religious identity, and finding meaning within each while in a 'postcolonial' world. This session will explore the research question: "How (and where) do culture and religion intersect in modern Native American individuals, and is there any tension between these identities?"

*Strand 10A* | 2:45 p.m. – 3:45 p.m.

### **Remixed and Reimagined - Innovations in Religion, Spirituality, and (Inter)Faith in Higher Education**

**COMPETENCY:** social justice and inclusion  
**AUDIENCE:** faculty members or researchers  
**PRESENTERS:** **Sable Manson**, assistant director of student leadership & development (Joint Educational Project), University of Southern California  
**J.T. Snipes**, assistant professor, department of educational leadership, Southern Illinois University Edwardsville





# MONDAY, DECEMBER 10

Although higher education has given increasing attention to students' religious, secular, and spiritual identity (RSSI) development, much of the scholarship continues to take a unidimensional approach with few texts examining religion, spirituality, and interfaith through an intersectional lens. Presenters will look beyond traditional Christian narratives by highlighting innovative scholarship on intersectionality and emerging RSSI perspectives. Participants will be invited to contribute through an engaging group discussion and Q&A.

*Strand 12B* | 2:45 p.m. – 3:45 p.m.

## **The Lived Experiences of “Pioneer” Women in Cabinet-Level Leadership at Faith-based Institutions**

COMPETENCY: **leadership**

AUDIENCE: **faculty members or researchers**

PRESENTERS: **Karen Longman**, program director, department of higher education, Azusa Pacific University

**Cibele Webb**, assistant professor, Saint Mary's University

**Caitlyn Zang**, assistant director of student engagement, Arizona State University

This session presents findings from a research study exploring the lived experiences of 17 women serving in cabinet-level leadership positions at faith-based colleges or universities. The women interviewed “broke the glass ceiling” and pioneered the way at their institutions by being the “first” or the “only” woman in senior-level leadership. This study drew from the literature on women in leadership, gender roles, tokenism, and oneliness. Future implications for women seeking to serve in formal positions of leadership are discussed.

*Strand 10B* | 2:45 p.m. – 3:45 p.m.

## **White Christian Privilege and Intersectionality**

COMPETENCY: **social justice and inclusion**

AUDIENCE: **student affairs professionals**

PRESENTER: **James Puglisi**, associate director of campus ministry, St. Edward's University

What is the relationship white Christian privilege and intersectionality? Christianity has been viewed and used as a tool of oppression and of resistance. Can both be held in the same space, given individuals' experiences? Is white Christian privilege unique to the United States? This session will try to frame this discussion by looking at personal experience, language, history, developmental stages, and other elements, providing a framework of understanding and direction on how to approach Christian traditions in equity work.

*Strand 11B* | 2:45 p.m. – 3:45 p.m.

## **Who's Learning About Religion? First-Year Student Curricular Choices Concerning Religion and Spirituality**

COMPETENCY: **assessment, evaluation and research**

AUDIENCE: **student affairs professionals**

PRESENTERS: **Robert Foster**, lecturer in religion, University of Georgia

**Joshua Patterson**, research fellow, American Academy of Religion

Campus spiritual and religious climates are an issue of growing concern on contemporary college campuses and the focus of numerous efforts to improve dialogue across differences. One of the sites of this dialogue







is the formal curriculum; however, little is known about what factors affect students' decision to engage this way. In this session, participants will explore the question of "Who's learning about religion?" through the new Interfaith Diversity Experiences and Attitudes Longitudinal Survey (IDEALS) administered by Interfaith Youth Core.

## **ROUNDTABLE REFLECTIONS | 2:45 p.m. – 3:45 p.m.**

Roundtable reflections will be presented concurrently with other roundtable presentations in Empire D.

### **Balancing Principles and Perspectives in the Wake of Campus Crises**

COMPETENCY: **advising and supporting**

AUDIENCE: **student affairs professionals**

PRESENTER: **Jonathan O'Brien**, assistant professor, California State University, Long Beach

Participants will explore the principles and individual qualities needed to restore confidence in community in the wake of high-profile campus crises. In a crisis, professionals intervene to support the survivors. These tragic incidents also affect community members who rightly question the competency of campus leaders and the institutional principles they espouse. As professionals, we help communities move through pain and facilitate environments where all can flourish; yet, we may exacerbate the problem by prioritizing principles over diverse perspectives.

### **Connecting Religious Life, Chaplaincy, and Student Affairs**

COMPETENCY: **social justice and inclusion**

AUDIENCE: **student affairs professionals**

PRESENTERS: **Kiah Glenn**, assistant director for center for race, ethnicity, and diversity education, Elon University

**Joel Harter**, associate university chaplain, Elon University

**Carolyn Rauch**, graduate assistant, North Carolina State University

This roundtable will discuss ways that religious affairs and student affairs can best partner and work together in supporting student learning, development, and inclusion. Increasingly, religious affairs is partnered with and often under student affairs, and yet professional training is often very different. How can professionals from these areas best partner to support students? What are the challenges and opportunities in these collaborations? What can student affairs learn from religious affairs, and what can religious affairs learn from student affairs?

### **Helping Christians Think About Christian Privilege**

COMPETENCY: **social justice and inclusion**

AUDIENCE: **student affairs professionals**

PRESENTER: **Christy Moran Craft**, associate professor, Kansas State University

As we strive for equity and inclusion in higher education, many have written about the topic of Christian privilege. Others are incorporating that topic into training and professional development sessions for students and staff. For obvious reasons, such discussions can be challenging for those who identify as Christian. The purpose of this session is to provide suggestions for helping Christian students, faculty, and staff think about the issue of Christian privilege in higher education.





## Preparing for a Career in Interfaith Chaplaincy: An Open Discussion

COMPETENCY: **social justice and inclusion**  
 AUDIENCE: **student affairs professionals**  
 PRESENTER: **Bonnie Glass-Coffin**, professor, Utah State University

A new field of interfaith studies is emerging on public and private campuses around the country. What does this mean for students who want to enter interfaith chaplaincy? How can students make the most of this emerging discipline to prepare for seminary? Are there interreligious competencies, aspects of spiritual formation, and preparation for care of multifaith communities that should be included in these programs? What's missing from the conversation? This roundtable discussion will explore these questions and suggest possible responses.



## Purpose, Belonging, Identity

COMPETENCY: **student learning and development**  
 AUDIENCE: **university chaplains, campus ministers, and religious professionals**  
 PRESENTER: **Linda Morgan-Clement**, dean of spiritual and religious life, Lawrence University

Recent research has shown that purpose, belonging, and identity are key developmental factors for traditional age, sophomore students. These factors are also often core in spiritual and religious life programming. With an increasing number of schools creating programs directed towards sophomore development, this conversation is an invitation to consider ways that resources from spiritual and religious traditions can contribute to our sophomores' ability to persist and thrive. The conversation will be facilitated by the dean for spiritual and religious life at Lawrence University. Lawrence University's office of spiritual and religious life is in the process of designing a program for sophomores that will live in the intersection of questions about identity, purpose, and belonging and spiritual development.



## Vocation or Self-Authorship? What Student Affairs, Chaplains, and Campus Ministers Can Learn From One Another

COMPETENCY: **advising and supporting**  
 AUDIENCE: **university chaplains, campus ministers, and religious professionals**  
 PRESENTERS: **Katherine Smanik**, chaplain and assistant dean of civic engagement, DePauw University  
**Ross Wantland**, director of diversity & social justice education, University of Illinois Urbana-Champaign

On the college campus, three groups may be engaged in spiritual, religious, or secular engagement: student affairs professionals, chaplains, and campus ministers. Each of these may serve distinct and overlapping roles, but each may feel as though they are in competition or conflict with each other. Facilitated by a campus chaplain and a student affairs professional, this roundtable seeks to open up dialogue across these groups to help us identify opportunities for deeper synergy and understanding across these professions.



## EXPLORATION SESSIONS | 4:00 p.m. – 5:00 p.m.

*Strand 12A* | 4:00 p.m. – 5:00 p.m.

### **Building Community and Compassion through Inner Exploration: The USU Shamanism Experiment**

COMPETENCY: **student learning and development**  
 AUDIENCE: **student affairs professionals**  
 PRESENTER: **Bonnie Glass-Coffin**, professor, Utah State University

This session will provide teaching faculty with both a brief history and an experiential introduction to a cross-cultural shamanism class offered at Utah State University. First offered in 2012, this class offers students practical tools for inner exploration while serving as an important mechanism for cultivating deeper, more meaningful relationships to self, others, and the world regardless of student religious/non-religious worldview. While part of the Interfaith Leadership Certificate Program, the class can also be adapted to meet extra-curricular campus needs.

*Strand 10B* | 4:00 p.m. – 5:00 p.m.

### **Contemplative Spirituality and Interfaith Exploration**

COMPETENCY: **student learning and development**  
 AUDIENCE: **student affairs professionals**  
 PRESENTERS: **Shane Atkinson**, muslim life coordinator, Elon University  
**Joel Harter**, associate university chaplain, Elon University

This session invites participants to experience contemplative practices from three different traditions — Christianity, Buddhism, and Islam — and to reflect together on the similarities and differences in these practices. Participants will explore together, and the session will model a facilitated use of contemplative practices to engage students and others in interfaith sharing and exploration. Participants will be provided with a list of resources for future learning and suggested best practices for integrating contemplative spirituality into interfaith work with college students.

*Strand 11A* | 4:00 p.m. – 5:00 p.m.

### **Exploring Christian Contemplative Practices**

COMPETENCY: **personal and ethical foundations**  
 AUDIENCE: **student affairs professionals**  
 PRESENTER: **Joseph Pritchett**, director, office of faith and meaning, Franklin & Marshall College

Sitting in stillness, the practice of meditation and cultivating awareness is oftentimes associated with religious traditions like Buddhism or even secular mindfulness practices. However, there also exists a deep tradition of Christian contemplation that is grounded in these practices. This session will briefly explore the history and purpose behind Christian contemplation and recognize its connections to other contemplative traditions. The majority of the session will allow participants to engage in a meditation practice grounded in the Christian contemplative tradition.





# MONDAY, DECEMBER 10

**Strand 10A | 4:00 p.m. – 5:00 p.m.**

## **Striving for Vocational Integrity: Applying Biblical Principles to Higher Education Work**

COMPETENCY: **personal and ethical foundations**

AUDIENCE: **student affairs professionals**

PRESENTER: **Christy Moran Craft**, associate professor, Kansas State University

Christians who believe that the Bible is the inspired Word of God frequently study the Bible in order to grow closer to God and to learn more about God's will for their lives. The purpose of this session is to demonstrate how the Bible can be studied with a focus on applying biblical principles to various aspects of our work in higher education to help lead us in our quest to live with vocational integrity.

**Strand 12B | 4:00 p.m. – 5:00 p.m.**

## **Using Meditative Practice for Stress Management Relief for Online Students**

COMPETENCY: **student learning and development**

AUDIENCE: **student affairs professionals**

PRESENTERS: **Melanie Berte-Hickey**, assistant professor of social work, Briar Cliff University  
**Frances Hlavacek**, student, Briar Cliff University

The purpose of this presentation is to introduce students to the positive benefits of meditation or prayer practice as one way to manage stress in online learning. Both physical and spiritual advantages can be gained by maintaining a prayerful practice. This exercise is developed for online students and presented over the course of four weekly sessions. It is non-denominational, yet spiritually focused.

**SAVE THE DATE!** JUNE 5-8, 2019  
FORT LAUDERDALE, FLORIDA

2019 CIVIC LEARNING AND DEMOCRATIC ENGAGEMENT MEETING #CLDE19

**NASPA**  
Student Affairs Administrators  
in Higher Education

**ADP**  
Association of Developmental Professionals

[bit.ly/2019CLDE](http://bit.ly/2019CLDE)



## GENERAL INTEREST SESSIONS V | 8:15 a.m. – 9:15 a.m.

*Strand 10A* | 8:15 a.m. – 9:15 a.m.

### **First Impressions: Exploring the Interfaith Perspective of First-Year Students**

COMPETENCY: **assessment, evaluation and research**

AUDIENCE: **student affairs professionals**

PRESENTER: **Mary Ellen Giess**, senior director of co-curricular partnerships, Interfaith Youth Core

This session explores the latest findings from the Interfaith Diversity Experiences & Attitudes Longitudinal Survey (IDEALS), a national study of students' attitudes, experiences, and expectations about worldview diversity. Drawing from longitudinal data collected from over 7,000 first-year students at 122 U.S. institutions, the presenters will offer insight into the interfaith diversity attitudes of students across their first year of college, as well as implications for practice.

*Strand 10B* | 8:15 a.m. – 9:15 a.m.

### **Integrating Spiritual Identify with Student Affairs Practices: A Franciscan Case Study Utilizing an Inductive Framework**

COMPETENCY: **values, philosophy, and history**

AUDIENCE: **student affairs professionals**

PRESENTERS: **Matthew Goodwin**, dean of campus life, Saint Joseph's College  
**Sean Lansing**, chief mission officer, Cardinal Stritch University

This presentation will provide attendees with an overview of the relevant research on spirituality and student affairs, as well as an observation of current environments on college campuses through research conducted at Franciscan institutions. The resulting inductive framework will help practitioners of all institutions as they address spirituality and college identity in student affairs. This presentation will present the relevant scholarship related to student success and collegiate spiritual identity and provide practitioners with recommendations for their work with students.

*Strand 11A* | 8:15 a.m. – 9:15 a.m.

### **Making the Invisible Visible: Highlighting Experiences of Black Muslim Students**

COMPETENCY: **social justice and inclusion**

AUDIENCE: **student affairs professionals**

PRESENTER: **Kiah Glenn**, assistant director, center of race, ethnicity, and diversity education, Elon University

Participants are invited to take part in this session that addresses the erasure of Black Muslims on higher education campuses. The presenter will explore with participants how political rhetoric has silenced Black Muslims and how this is mirrored in our academic spaces.





*Strand 12A* | 8:15 a.m. – 9:15 a.m.

## **Vocational Discernment: Negotiating Spiritual and Personal Identity for Student Support and Well-being on a Multifaith College Campus**

COMPETENCY: **student learning and development**

AUDIENCE: **student affairs professionals**

PRESENTERS: **Donavan McCargo**, assistant vice president & dean of students, Kutztown University  
**Dawn Singleton**, senior director, ASCEND program, Rowan University

Campuses are overwhelmed by the pervasive number of students in need of mental health services. As administrators, we find ourselves negotiating our own spiritual and professional identities to develop critical services to complement traditional mental health services. Although higher education has given increasing attention to students' religious, secular, and spiritual identity development, few texts examine the intersection of mental health wellness and spirituality from a multifaith perspective. The goals of this presentation are to explore and challenge the boundaries of familiar religious narratives, to identify sustainable and practical approaches, that can support students in identity development, sense-making, as well as the development of coping strategies as it relates to mental health well-being and stability.

*Empire D* | 9:20 a.m. – 10:30 a.m.

## **PLENARY | Where Do We Go? Moving Forward in the Complicated Matrix of RSSI Engagement**

CONVENER: **Reverend Dave Wright**, University Chaplain and Director for Spiritual Life and Civic Engagement, University of Puget Sound

CONVERSANTS: **J. Michael Segawa**, vice president for student affairs, Pitzer College  
**Imam Abdullah Antepi**, chief representative of Muslim affairs and adjunct faculty of Islamic studies, Duke University  
**Czarina Ramsay**, assistant dean for ethnic and intercultural services, Loyola Marymount University

There is no single structure or format that defines how institutions of higher education engage with RSSI identities. In a discipline that is relatively undefined, that is dramatically shaped by not only institutional type but by staffing structures, limited and often absent resources for training new professionals, Constitutional concerns for some contexts, cultural trends showing increased bias and hate crimes targeting certain RSSI populations, and more...how do we even ask the question "Where are we going?"

This plenary conversation seeks to build off of NASPA's recent work to strengthen this critical but often unaddressed need. Professionals working in or near these topics are increasingly better able to identify the needs, complexities, and opportunities emerging at the nexus of religious, spiritual, and secular identities on college campuses.

Following a brief introductory framing of this context, a panel of discussants (representing various critical locations in the matrix of ways campuses engage with RSSI needs) will hold a series of short thematic conversations about crucial issues in RSSI-related work, followed by time for dialogue with the audience and a closing reflection by the convener.





## **GENERAL INTEREST SESSIONS VI | 10:45 a.m. – 11:45 a.m.**

*Strand 11A | 10:45 a.m. – 11:45 a.m.*

### **Confronting the Unacceptable: An Interfaith Engagement with the Civil Rights Movement**

COMPETENCY: **social justice and inclusion**

AUDIENCE: **university chaplains, campus ministers, and religious professionals**

PRESENTERS: **Tracey Cameron**, assistant dean of intercultural education and director of Harambee House, Wellesley College  
**Emily Jendzejec**, catholic chaplain, Wellesley College

The past two years, Wellesley College's Office of Religious and Spiritual Life, Harambee House, and Career Education have co-sponsored an alternative spring break trip: Confronting the Unacceptable: An Interfaith Engagement with the Civil Rights Movement. Using assessment data and student and staff narratives, this workshop will present how this program was a successful partnership between student affairs and religious and spiritual life on campus and provided a meaningful and impactful experience for student participants.

*Strand 10A | 10:45 a.m. – 11:45 a.m.*

### **Deconstructing the Struggles of the Campus Muslim Students Association**

COMPETENCY: **social justice and inclusion**

AUDIENCE: **student affairs professionals**

PRESENTER: **Ross Wantland**, director, diversity & social justice education, University of Illinois at Urbana-Champaign

The purpose of a Muslim Students Association (MSA) is to help Muslims foster a sense of identity and community on campus while also working to educate the campus-at-large about Islam. Quite a hefty task, huh? This session will highlight some of the specific challenges MSAs and their leaders may face and how to best support and advise them.





**Strand 10B | 10:45 a.m. – 11:45 a.m.**

## **Holy Yearnings, Holy Listening, Holy Partnerships: A Peer-to-Peer Young Adult Ministry Initiative**

- COMPETENCY: **social justice and inclusion**
- AUDIENCE: **university chaplains, campus ministers, and religious professionals**
- PRESENTERS: **Alexa Eisenbarth**, student, Garrett-Evangelical Theological Seminary  
**Jennifer Moe**, assistant director, young adult initiative, Garrett-Evangelical Theological Seminary  
**Brianna Crumbley**, student, Garrett-Evangelical Theological Seminary

The *Holy Yearnings, Holy Listening, Holy Partnerships* program, sponsored by Garrett-Evangelical Theological Seminary and Lilly Endowment, Inc., presents research findings of the first phase of an initiative that aims to help congregations support young adults' flourishing. Listening to the spiritual and religious yearnings of young adults lies at the center of the project. This research was conducted specifically within congregations, though what was learned about young adults is valuable to all audiences that are interested in their flourishing.

**Strand 11B | 10:45 a.m. – 11:45 a.m.**

## **Inclusive Ablution Areas: Creating and Sustaining an Interfaith Center**

- COMPETENCY: **assessment, evaluation & research**
- AUDIENCE: **university chaplains, campus ministers, and religious professionals**
- PRESENTER: **Reverend Amy Fisher**, university chaplain and director, interfaith center, Suffolk University

How does religious life exist and coexist on your campus? This session will describe a model of cooperation via an Interfaith Center. Attention will be paid to the creation and sustenance of a place adaptable to students, staff, and faculty of any or no religion. Discussion will include providing authentic religious practice, suggested partnerships on campus, supporting immigrants/displaced persons on campus, cooperating with academic departments, utilizing local places of worship/meeting, and inclusivity with regard to daily ablution areas.







Strand 12A | 10:45 a.m. – 11:45 a.m.

## Secret's Out: Navigating a Religious Institution when You Don't Share the Same Faith

COMPETENCY: **social justice and inclusion**

AUDIENCE: **student affairs professionals**

PRESENTERS: **Chantel Batton-Utley**, residence director, St. Edward's University  
**Kaitlin Burke**, residence director, St. Edward's University  
**Vaughn Love**, assistant director of student transitions and family engagement, St. Edward's University

The presenters in this session will address the ways in which professionals navigate a religious institution different from their own faith tradition. Pulling from the experiences of three professionals from diverse faith backgrounds, the presenters will share the freedoms and constraints of living outside of the religious culture at a small, Catholic institution in Austin, Texas. Participants will learn how to thrive in their campus culture without sacrificing their authentic selves.

## MEETING OFFICIALLY ADJOURNS | Noon



2019 NASPA  
CONFERENCES ON  
**STUDENT SUCCESS  
IN HIGHER EDUCATION**

Join colleagues from  
across higher ed as  
we work towards  
dismantling barriers to  
success for all students

JUNE 16 – 18, 2019 | ORLANDO, FLORIDA

[bit.ly/SSHE\\_19](https://bit.ly/SSHE_19)

 **NASPA**  
Student Affairs Administrators  
in Higher Education

---

---

---

---

---

---

---

---

---

---

---

---

---

---

---

---

---

---

---

---

---

---

---

---

---

---

---

---

---

---

---

---

---

---

---

---

---

---

---

---

---

---

---

---

---

---

---

---

---

---

---

---

---

---

✍️ NOTES

---

---

---

---

---

---

---

---

---

---

---

---

---

---

---

---

---

---

---

---

---

---

---

---

---

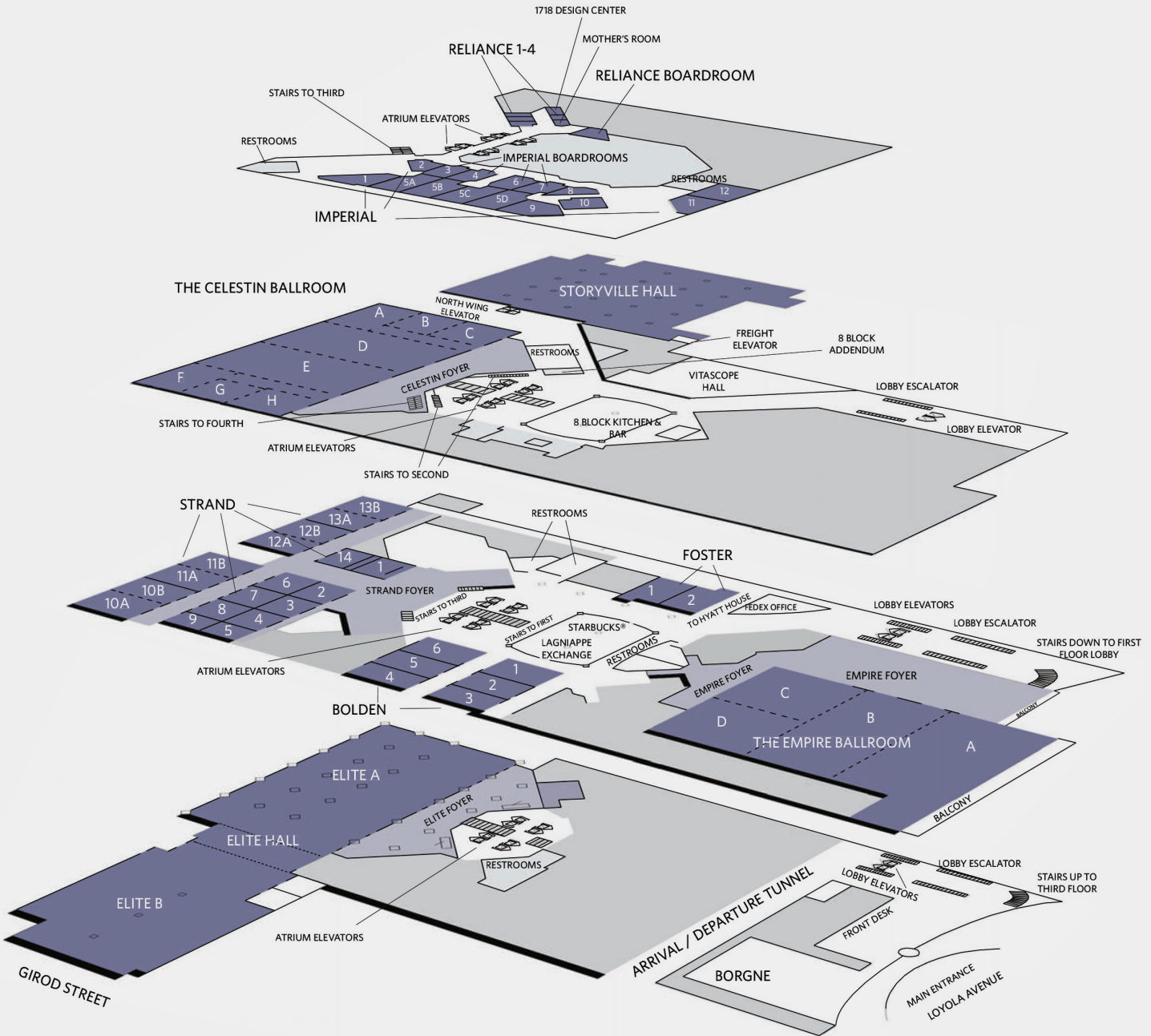

# VENUE MAP (level two)

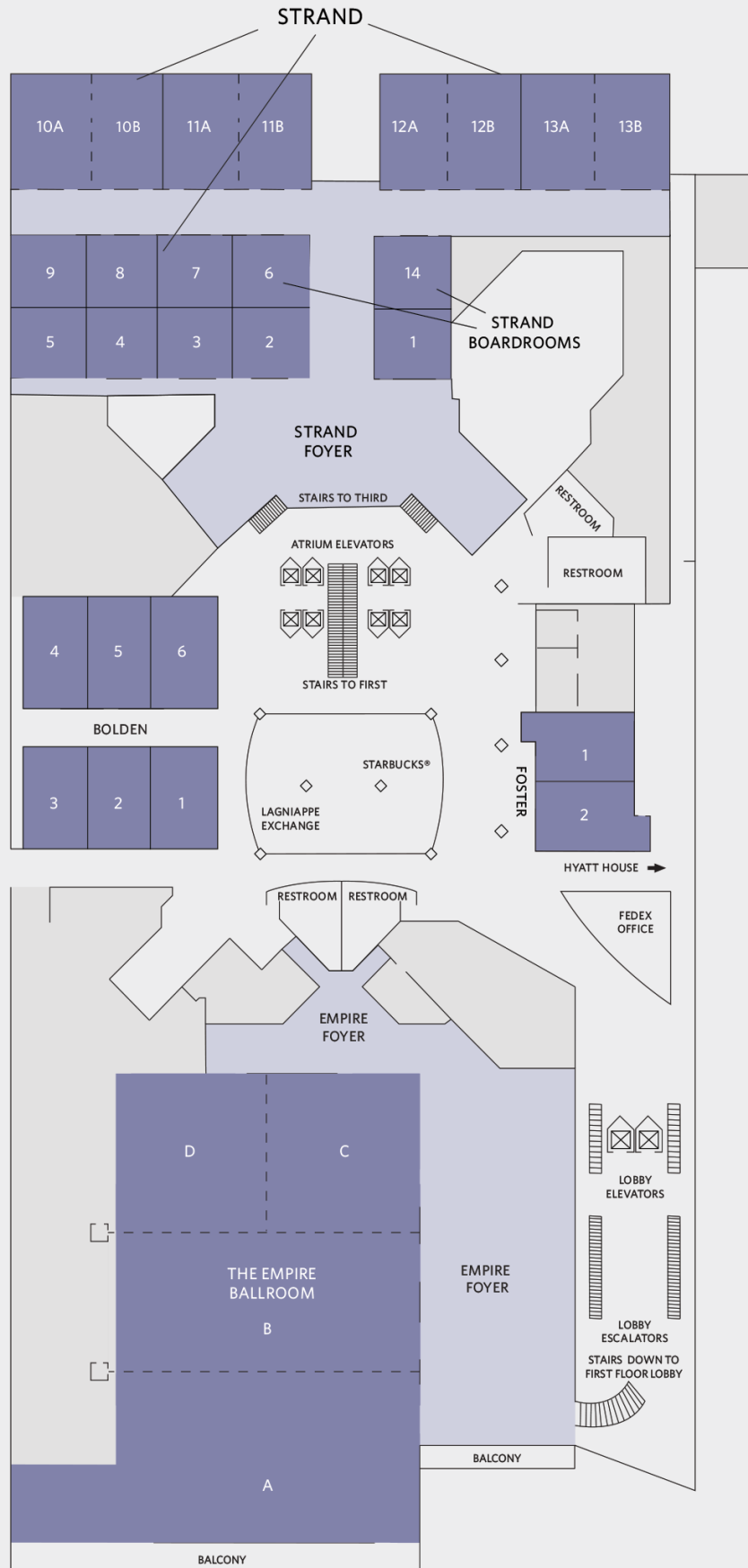

# VENUE MAP (level three)

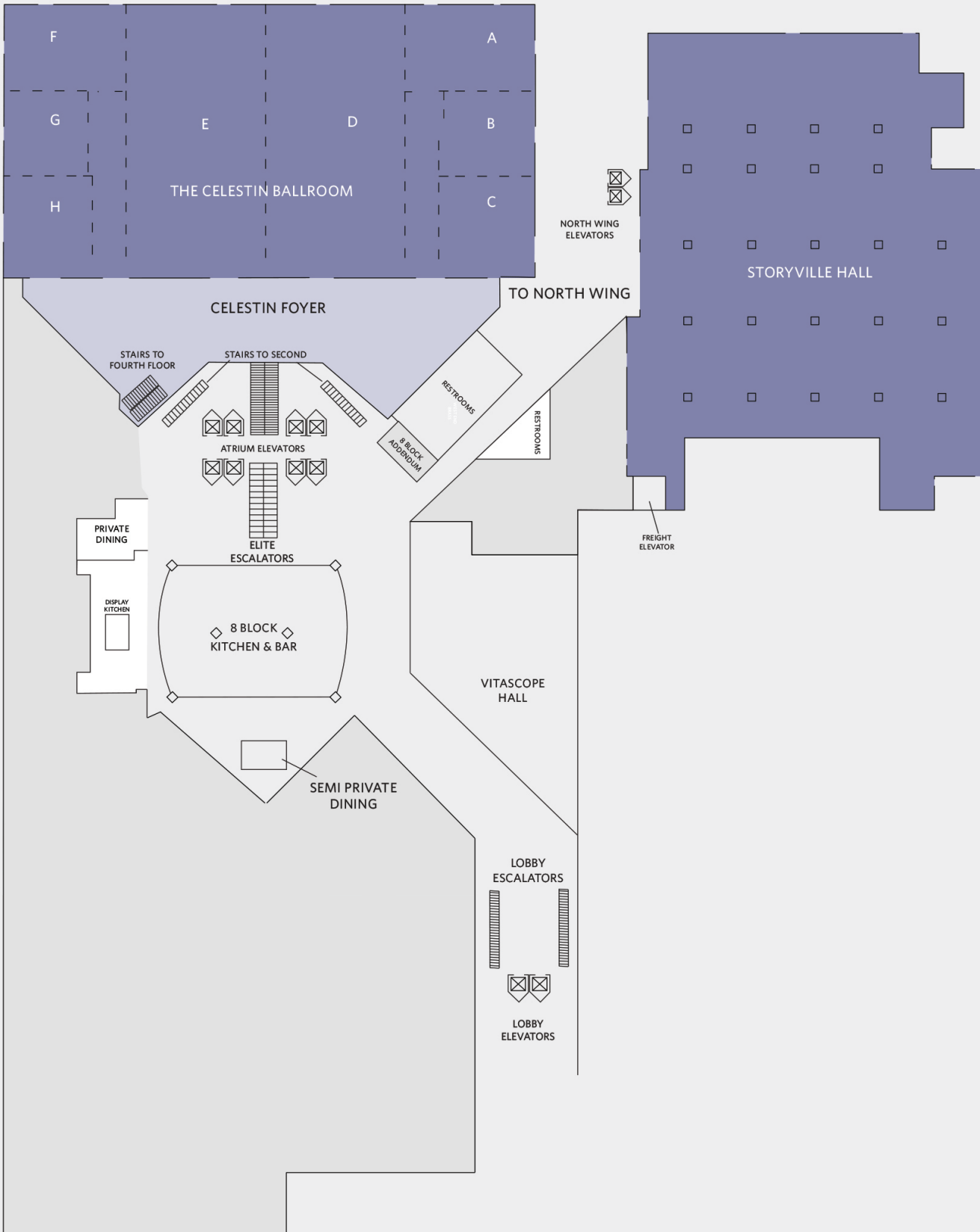

Join us for the unforgettable conclusion  
of our 100th Anniversary Celebration!

2019 NASPA

*Annual Conference*

MARCH 9-13, 2019 ★ LOS ANGELES, CA

&

the placement  
exchange

MARCH 6-10, 2019

[conference2019.naspa.org](http://conference2019.naspa.org)