

Disclaimer for use of the Property Ownership Maps
 This Property Ownership Map and Data is created for ad valorem tax purposes on an annual basis by the Crook County Assessor's Office. The user of this data agrees not to reproduce these documents for resale purposes. Any user accepts the map and data "as is" and "with all faults." Any user of this data agrees to hold Crook County harmless from any liability arising from its use. This document does not constitute legal ownership or survey of the real property. The user should research the latest ownership of record in the Crook County Clerk's Office.

Crook County Wyoming T51N R63W Ownership 1" = 2000'

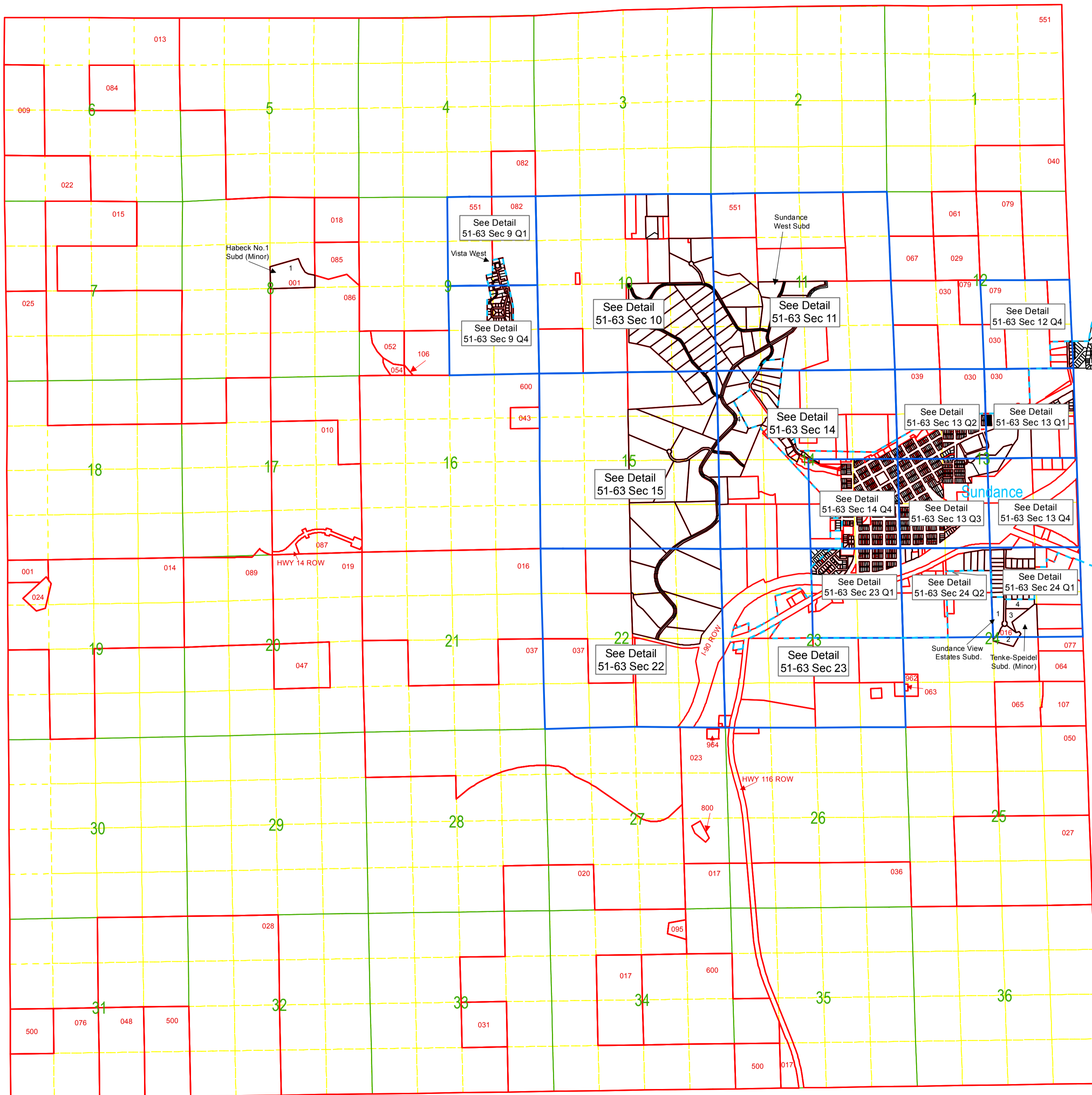

NUMBER	TAXPAYER/NAME	
001	FROLANDER MICHAEL R	5163 19 2 00 001.00
009	HUGHES TALEEN E	5163 06 2 00 009.00
010	LAMBERT PAGE	5163 17 1 00 010.00
013	HABECK NAOMI TRUST 3/4	
014	HABECK LEE TRUST 1/4	5163 05 3 00 013.00
015	FROLANDER ROBERT J & PATRICIA SCHLOREDT LEROY F TRUST B	5163 19 1 00 014.00
016	FIRST INTERSTATE BANK TRUSTEE SCHLOREDT RANCH INC	5163 07 1 00 015.00
017	ATTN JUDY HUTCHINSON	5163 09 3 00 016.00
018	SCHLELDORF RANCHES INC	5163 26 3 00 017.00
019	MIGNERY EDWARD & BARBARA	5163 08 1 00 018.00
020	MEDICINE LAKE RANCH CORP	5163 19 3 00 019.00
022	LAMB DONNA D REVOCABLE TRUST	5163 27 3 00 020.00
023	MARSHALL LANCE	5163 06 3 00 022.00
024	CRAWFORD WARREN L & GRETA S	5163 22 4 00 023.00
025	HUGHES REBECCA R & HOBY D	5163 19 2 00 024.00
026	CHATFIELD RANCH LLC 1/2 & CHATFIELD CHARLES E & MARGERY G TRUSTS	5163 07 3 00 025.00
027	SUNDANCE MOUNTAIN RESORT INC	
028	ATTN CUNDY HENRY	5163 23 4 00 026.00
029	STUART RANCH LMTD PARTNERSHIP	5163 25 3 00 027.00
030	PETERSON DONALD AND SUZANNE MAUCH STEVEN JR 1/2	5163 31 1 00 028.00
031	JOHNSON ANGEL MAUCH 1/2	5163 12 2 00 029.00
033	MAUCH REX M & BRUCKER SUSAN K	5163 12 3 00 030.00
036	LAMB DONNA D REVOCABLE TRUST	5163 33 4 00 031.00
037	HAM BONE RANCH LMTD PARTNSHP	5163 26 3 00 036.00
039	CUNDY BRUCE & CORT M	5163 21 3 00 037.00
040	COLEMAN LARRY G & EILEEN J	5163 12 3 00 039.00
043	WYATT GLEN L REVOCABLE TRUST & WYATT JEANNE L REVOCABLE TRUST	5163 01 4 00 040.00
047	VISTA WEST HOMEOWNERS ASSOC	5163 16 1 00 043.00
048	SEELEY TODD T & ROBIN J	5163 20 4 00 047.00
050	TRUNK DANIEL J	5163 31 4 00 048.00
052	4P CATTLE CO	5163 25 1 00 050.00
054	TONAK DAVID A ET AL	5163 09 3 00 052.00
061	LAMBERT JOSEPH MARK	5163 09 3 00 054.00
063	BULLOCK CHERYL A	
064	F/K/A LITTKE CHERYL A	5163 12 2 00 061.00
065	SUNDANCE TV ASSN INC	
067	ATTN BROOKS PAUL	5163 24 3 00 063.00
076	KASKI HOMES INC	5163 24 4 00 064.00
077	KASKI HOMES INC	5163 24 4 00 065.00
079	MAUCH STEVEN SR	5163 12 2 00 067.00
082	CASEY PAUL J & CYNTHIA M	
084	JTWROS	5163 31 3 00 076.00
085	TENKE JAY VICTOR	
086	EMRICK HELEN M	5163 24 1 00 077.00
087	ACKERMAN VICKI L REV LVG TRUST	
088	GREENWOOD DAVID& JUDY & ACKERMAN FAM TRU	5163 12 1 00 079.00
089	HASSE GERALD G & KAREN A	5163 04 4 00 082.00
095	HABECK FAMILY PARTNERSHIP	5163 06 1 00 084.00
106	MIGNERY EDWARD A & BARBARA R	5163 08 1 00 085.00
107	LAMBERT JOSEPH MARK	5163 08 1 00 086.00
500	RYAN FAMILY TRUST	
551	RYAN BRUCE L & GAYLE S TRUSTEE	5163 17 4 00 087.00
600	RUDDLE ROBERT E	5163 17 3 00 089.00
962	LAMB REESE & WENDY	5163 34 1 00 095.00
964	LAMBERT J MARK & LAMBERT PAGE	5163 09 3 00 106.00
001	SEDGWICK BRUCE A	5163 24 4 00 107.00
001	BUREAU OF LAND MANAGEMENT	5163 31 3 00 500.00
001	U S FOREST SERVICE	5163 01 1 00 551.00
001	STATE OF WYOMING	5163 16 1 00 600.00
001	CITY OF SUNDANCE	5163 14 3 00 800.00
001	TRI-COUNTY ELECTRIC ASSOC INC	5163 23 4 00 962.00
001	TRI-COUNTY ELECTRIC ASSOC INC	5163 27 1 00 964.00
001	HABECK NO. 1 SUBDIVISION	
001	SMITH JEFFERY & DEBRA	
001	DBA SEVEN J OUTFITTERS	5163 08 1 01 001.00
001	SUNDANCE VIEW ESTATES LOTS 1-4 BLOCK 5	
016	MCFARLAND GERALD B & MANDI R	5163 24 1 03 016.00