

2003 3.2TL - Front Door Panel Removal/Installation

Special Tool Required

- Trim pad remover, Snap-on A177A or equivalent, commercially available.
1. Remove the mirror mount cover. Take care not to scratch the door panel.
 2. Remove the inner handle (A). Take care not to scratch the door panel.
 - 1 Pry out the cap (B), and remove the screw.
 - 2 Pull the inner handle forward and out half-way.

Fastener Location

▶ : Screw, 1



Without driving position memory switch
(driver's side on '99-01 models, and passenger's side:)

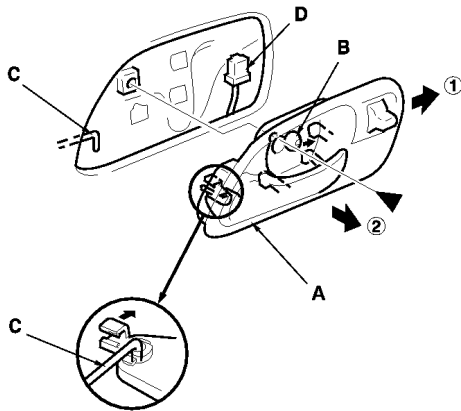

**With driving position memory switch
(driver's side on '02-03 models) :**

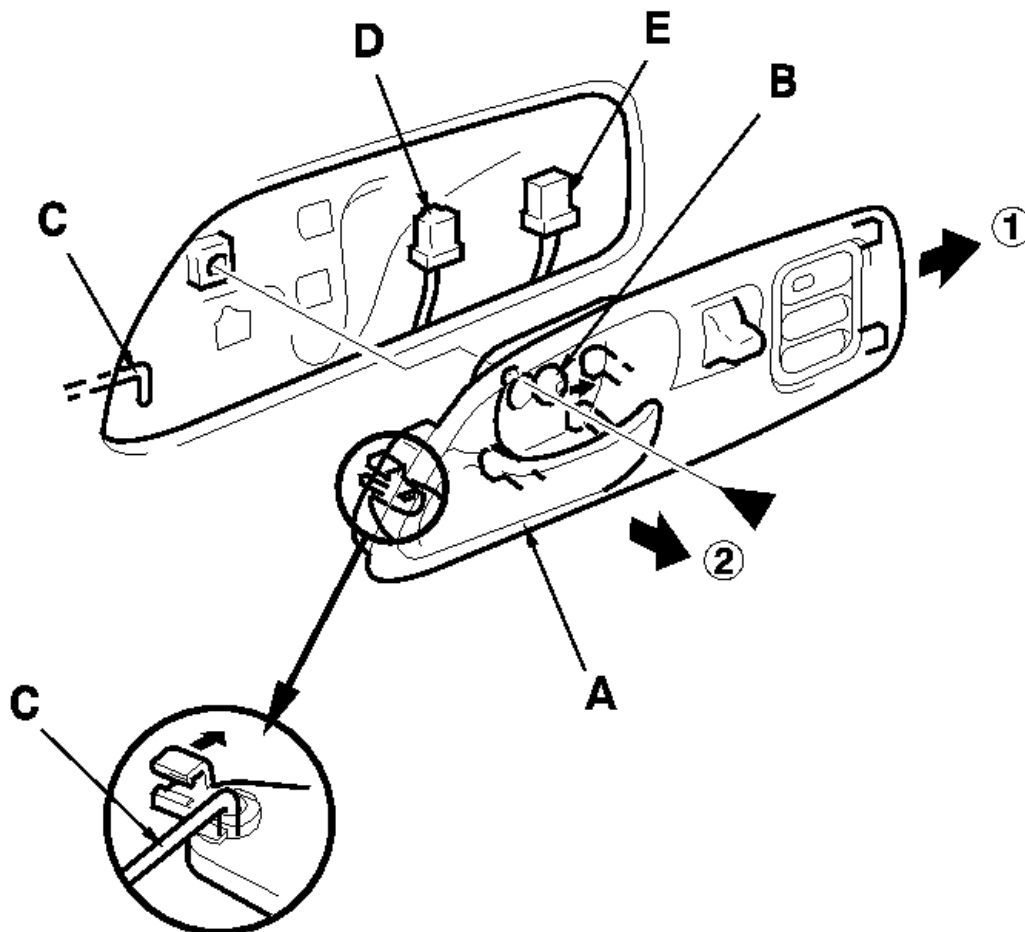

3. Remove the screw from the armrest portion of the door panel. Release the clips that hold the door panel (A) with a commercially available trim pad remover (B), then remove the door panel by pulling it upward. Remove the door panel with as little bending as possible to avoid creasing or breaking it.

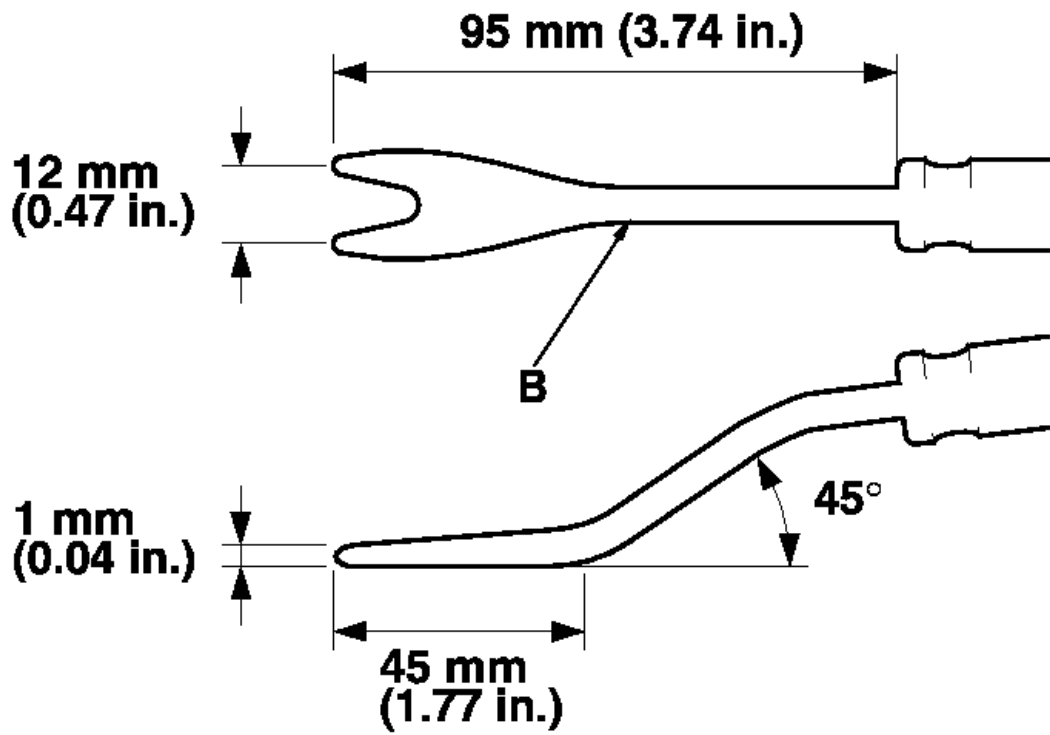

Fastener Locations

▶ : Screw, 1

▷ : Clip, 9
'99-01 models: 9
'02-03 models: 8

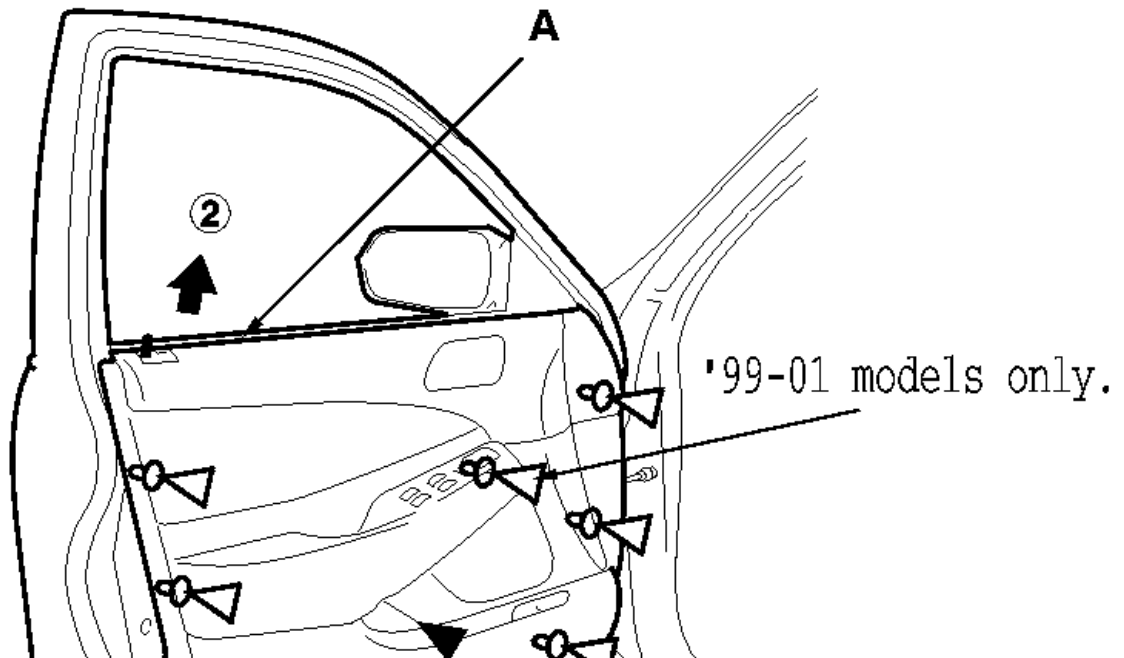
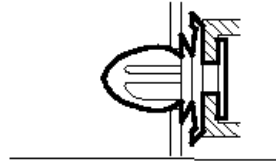
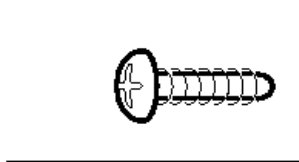

4.

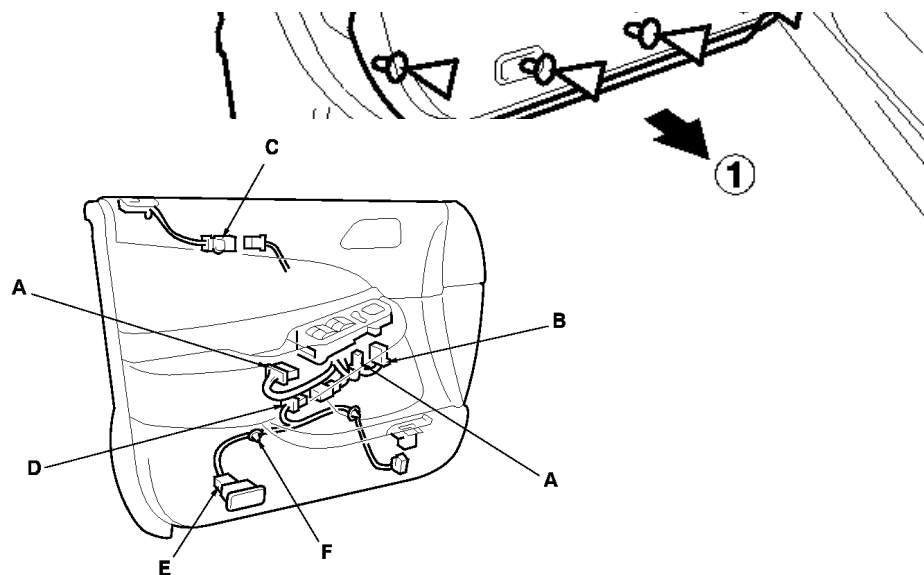

5. Install the panel in the reverse order of removal, and note these items:

- Replace any damaged clips.
- Make sure the connectors and courtesy light bulb socket are plugged in properly, and the rod is connected properly.
- Check the window and power door lock operation.

2003 3.2TL - Power Mirror Actuator Replacement

1. Remove the power mirror from the door, and disconnect the 6P ('99-01 models) or 13P ('02-03 models) connector.
2. Cut the wire harness with wire cutters.

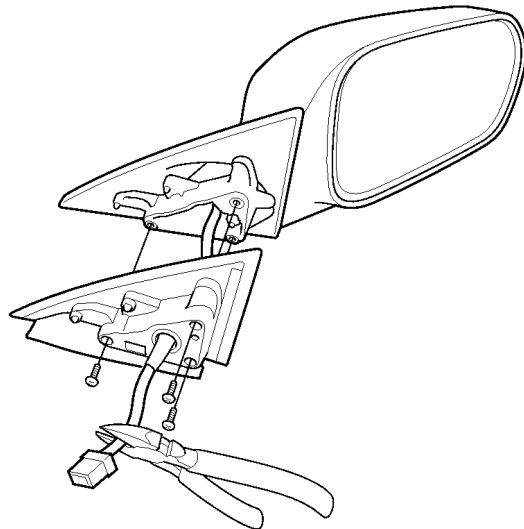

3. Record the terminal locations and wire colors.
4. Remove the mirror holder.
5. Remove the three screws (A) and the actuator (B).

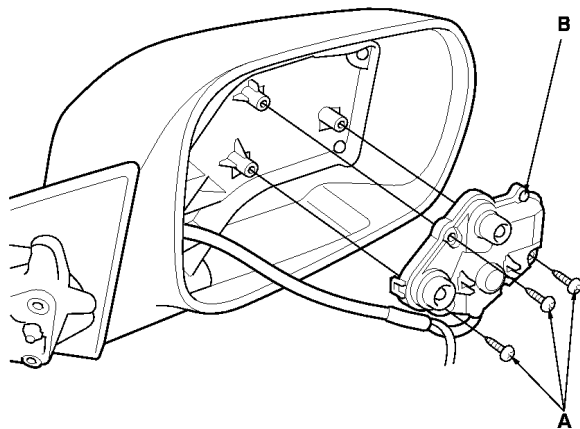

6. Route the wire harness (A) of the new actuator through the hole in the bracket (B).

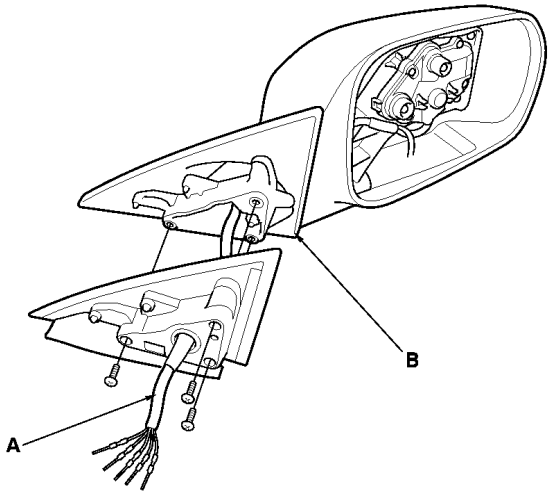

7. Insert the terminals into the connector as shown below.
8. Apply tape to seal the intersection of the wire harness.
9. Reassemble in the reverse order of disassembly. Be careful not to break the mirror when reinstalling it to the actuator.
10. Reinstall the mirror assembly to the door.
11. Operate the power mirror to ensure smooth operation.

'99-01 models:

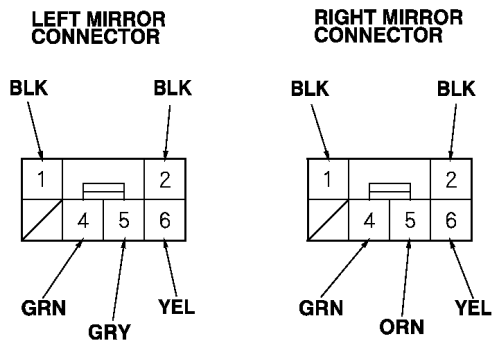

Terminal side of male terminals

'02-03 models:

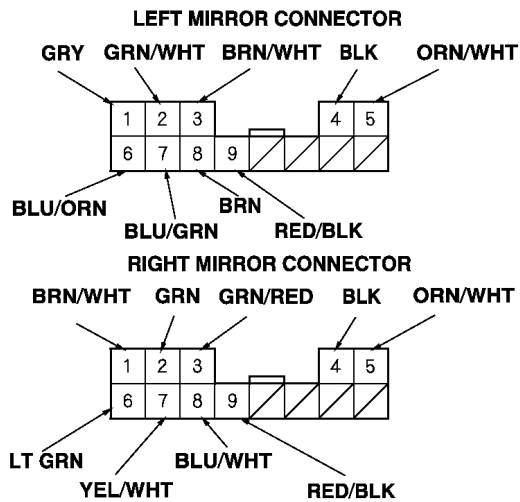

2003 3.2TL - Mirror Holder Replacement

1. Pry the mirror holder (A) out from the bottom until you can see the pivot (B) of the actuator, then detach the pivot using a flat-tip screwdriver wrapped with a shop towel. Take care not to scratch the mirror (C).

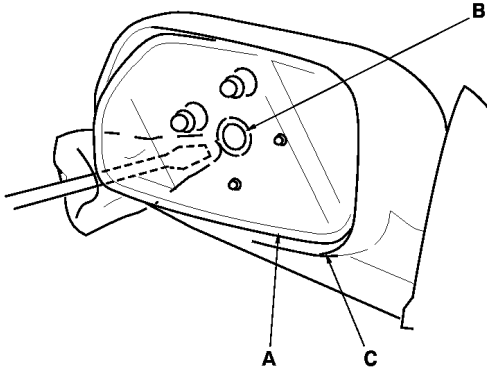

2. Pull out the actuator shafts (A), release the hooks (B) from the actuator (C), and remove the mirror holder (D). Disconnect the mirror defogger terminals (E).

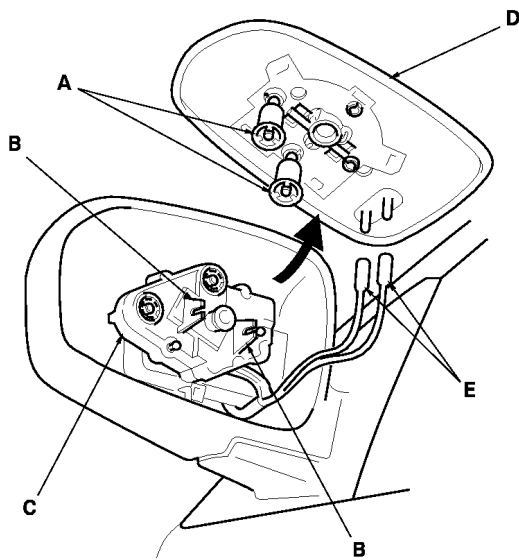

3. Remove the actuator shafts (A) and rubber boots (B) from the old mirror holder (C). Check the actuator shaft and rubber boot for damage or deterioration, and replace them if necessary.

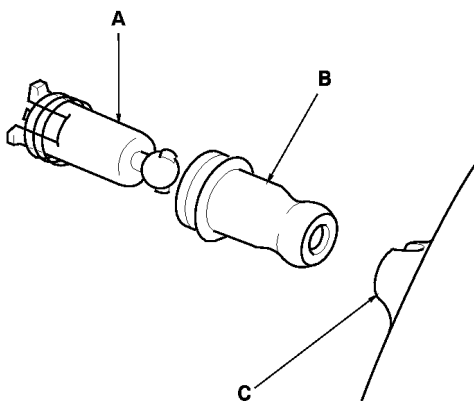

4. Install the holder in the reverse order of removal, and note these items:

- Before installing the mirror holder, install the actuator shafts and boots on the mirror holder.
- Make sure the mirror defogger terminals are plugged in properly.
- Grease the pivot (A), actuator shafts (B), and if equipped, mirror position sensor pins (C).
- Reattach the mirror holder (D) to the pivot (A) and actuator shafts (B) to the actuator, then carefully push on the pivot and actuator shaft portions of the holder until it locks into place.
- To ease installation of the mirror holder, it may be necessary to heat the pivot and actuator shaft joint portions of the mirror holder.
- Make sure the actuator shaft boots are installed into the actuator. If necessary, use a small screwdriver to reinstall them. Take care not to scratch the mirror.
- Check the operation of the actuator.

