

**Disclaimer for use of the Property Ownership Maps**

This Property Ownership Map and Data is created for ad valorem tax purposes on an annual basis by the Crook County Assessor's Office. The user of this data agrees not to reproduce these documents for resale purposes. Any user accepts the map and data "as is" and "with all faults." Any user of this data agrees to hold Crook County harmless from any liability arising from its use. This document does not constitute legal ownership or survey of the real property. The user should research the latest ownership of record in the Crook County Clerk's Office.

# Crook County Wyoming T51N R64W Ownership 1" = 2000'

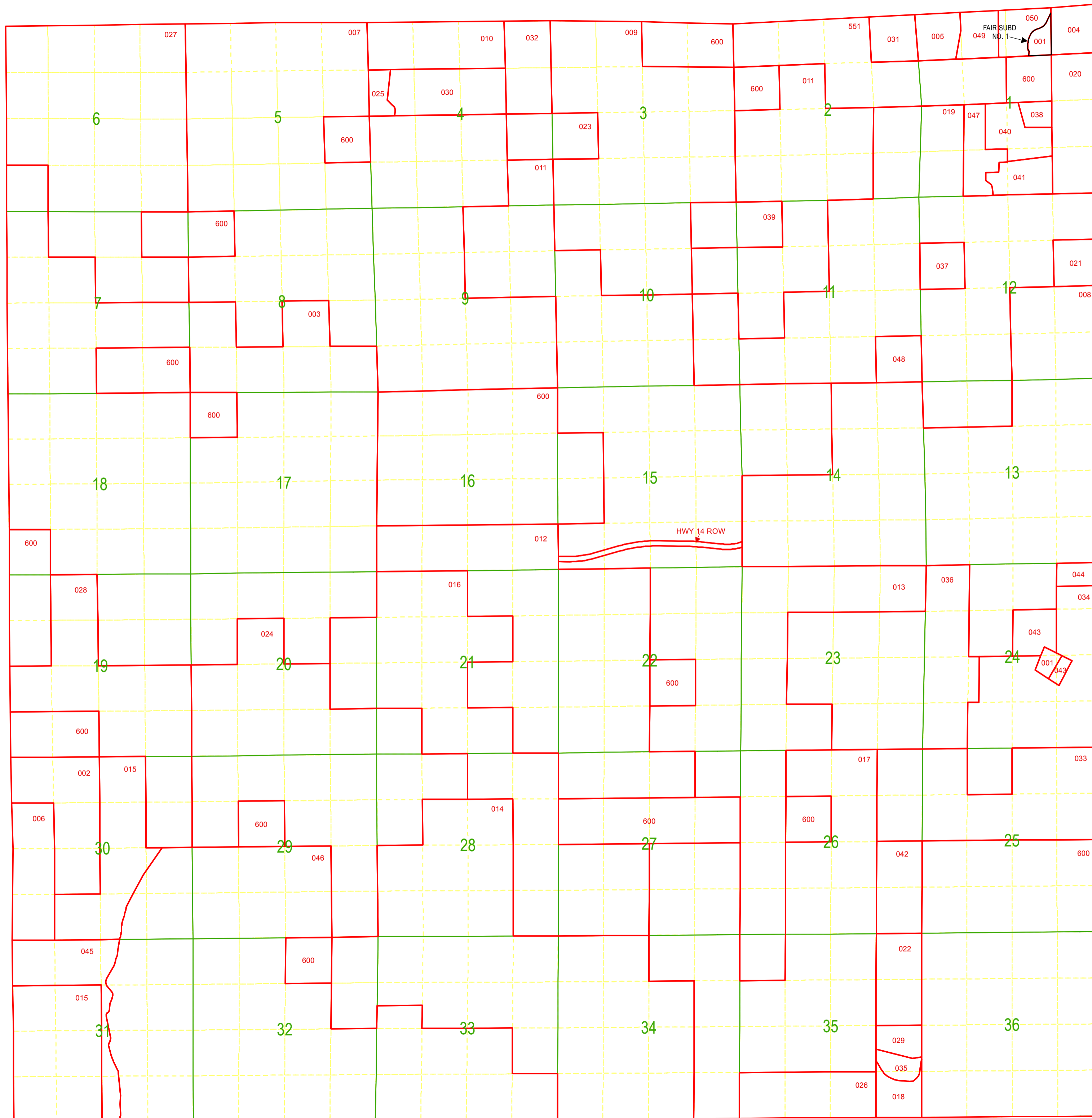

NUMBER	TAXPAYER/NAME	ACREAGE
001	BASEMAN SHANNON & LARRY	5164 24 1 00 001.00
002	STEEDLEY RICHARD G & NANCY A	5164 30 2 00 002.00
003	TAYLOR HAROLD FAMILY TRUST	
	TAYLOR ARLENE J REVOCABLE TRUST	5164 06 3 00 003.00
004	HABECK NAOMI TRUST ¾	
	HABECK LEE TRUST ¼	5164 01 1 00 004.00
005	FLYING C RANCH LLC	5164 01 2 00 005.00
006	STEEDLEY NANCY A	5164 30 2 00 006.00
007	CRUMP LAND & LIVESTOCK LLC	5164 04 3 00 007.00
008	CHATFIELD RANCH LLC 1/2 & CHATFIELD CHARLES E & MARGERY G TRUSTS	5164 11 4 00 008.00
009	SCHLOEDT F LEROY TRUST B	
	FIRST INTERSTATE BANK TRUSTEE	5164 03 1 00 009.00
010	BOX ELDER TRUST	5164 04 1 00 010.00
011	CHATFIELD RANCH LLC 1/2 & CHATFIELD CHARLES E & MARGERY G TRUSTS	5164 02 2 00 011.00
012	AYER JOHN D & MARGARET J	5164 16 3 00 012.00
013	SLEEP RICHARD D	5164 15 3 00 013.00
014	SCHLOEDT F LEROY TRUST B	
	FIRST INTERSTATE BANK TRUSTEE	5164 28 1 00 014.00
015	GOSE ROBERT O & VIVIENNE E JOINT TRUST	5164 29 3 00 015.00
016	TAYLOR ARLENE J REVOCABLE TRUST DANIEL E TAYLOR	5164 20 1 00 016.00
017	PERALA REVOCABLE LIVING TRUST PERALA ROBERT & BERNITA TRUSTEES	5164 26 1 00 017.00
018	PATTERSON LARRY D & KAREN M	5164 35 4 00 018.00
019	SWENSON JOHN D & VERDA L	5164 01 3 00 019.00
020	HUGHES TALEEN E	5164 01 1 00 020.00
021	MARSHALL LANCE	5164 12 1 00 021.00
022	MARCHANT BRIAN & JERLYN L	5164 35 1 00 022.00
023	COBURN WILLIAM M & CAROL J	5164 03 3 00 023.00
024	GRUBB RANCH FRANCIS GRUBB	5164 20 2 00 024.00
025	STEPHENSON THOMAS L & NORMA C	5164 04 2 00 025.00
026	RICHARDS DONNA G	5164 35 3 00 026.00
027	CRUMP LAND & LIVESTOCK LLC	5164 06 1 00 027.00
028	GOSE ROBERT O & VIVIENNE E JOINT TRUST	5164 19 2 00 028.00
029	PAINTNER WAYNE W & ROBERTA A	5164 35 4 00 029.00
030	GENNINGS THOMAS L & LAURA K	5164 04 1 00 030.00
031	FAIR MICHAEL R & JACQUELINE R	5164 01 1 00 031.00
032	FAIR MICHAEL R & JACQUELINE R	5164 04 1 00 032.00
033	MEDICINE LAKE RANCH CORP	5164 25 1 00 033.00
034	FROLANDER ROBERT J & PATRICIA	5164 24 1 00 034.00
035	VILKAITIS JOHN P & FOSTER JANET M	5164 35 4 00 035.00
036	SMITH ROBERT J & LINDA S	5164 23 1 00 036.00
037	SWENSON JOHN D & VERDA L	5164 12 2 00 037.00
038	MDS INCORPORATED	5164 01 4 00 038.00
039	CHATFIELD EDDIE R	5164 10 1 00 039.00
040	DOUBLE LOCK LLC	5164 01 3 00 040.00
041	ECKHOFF THOMAS J & PATRICIA N	5164 01 3 00 041.00
042	MEADOWS DAN & RITA	5164 26 4 00 042.00
043	BASEMAN SHANNON M & LARRY	5164 24 1 00 043.00
044	FROLANDER MICHAEL R	5164 24 1 00 044.00
045	GOSE ROBERT O & VIVIENNE E JOINT TRUST	5164 31 1 00 045.00
046	BLACK HILLS PROPERTIES LLLP	5164 29 3 00 046.00
047	DAIGLE MICHELLE M REVOCABLE TRUST	
	DAIGLE MICHELLE M & DAVID W TRUSTEES	5164 01 3 00 047.00
048	CHATFIELD CHARLES E REV TRUST 1/2 & CHATFIELD RANCH LLC ½	5164 11 4 00 048.00
049	CUDNEY JOHN W & CUDNEY DORA A LIVING TRUST	5164 01 2 00 049.00
050	FLETCHER BRITT & LISA FAMILY REV TRST	5164 01 1 00 050.00
551	U S FOREST SERVICE	5164 01 2 00 551.00
600	STATE OF WYOMING	5164 01 1 00 600.00
	<b>FAIR SUBDIVISION NO. 1</b>	
001	FAIR MICHAEL R & JACQUELINE R	5164 01 1 01 001.00