



TV Bundle Installation Guide

TV | CABLE INTERNET | HOME PHONE

PACKAGE CONTENTS

INTERNET CABLE CONTENTS



INTERNET MODEM
(HITRON CGNM-3550)



ETHERNET CABLE



POWER ADAPTER

Items may not be exactly as shown

TV CONTENTS



COMWAVETV SET-TOP BOX
(ABOX M30)



REMOTE
(BATTERIES INCL.)



HDMI CABLE



POWER ADAPTER



POWERLINE ADAPTERS
(OPTIONAL)



ETHERNET CABLE x2

Items may not be exactly as shown

HOME PHONE CONTENTS



HOME PHONE ADAPTER
(GRANDSTREAM HT801)



ETHERNET CABLE



POWER ADAPTER

Items may not be exactly as shown



For assistance
please call 1-866-211-6451

INSTALLATION OVERVIEW

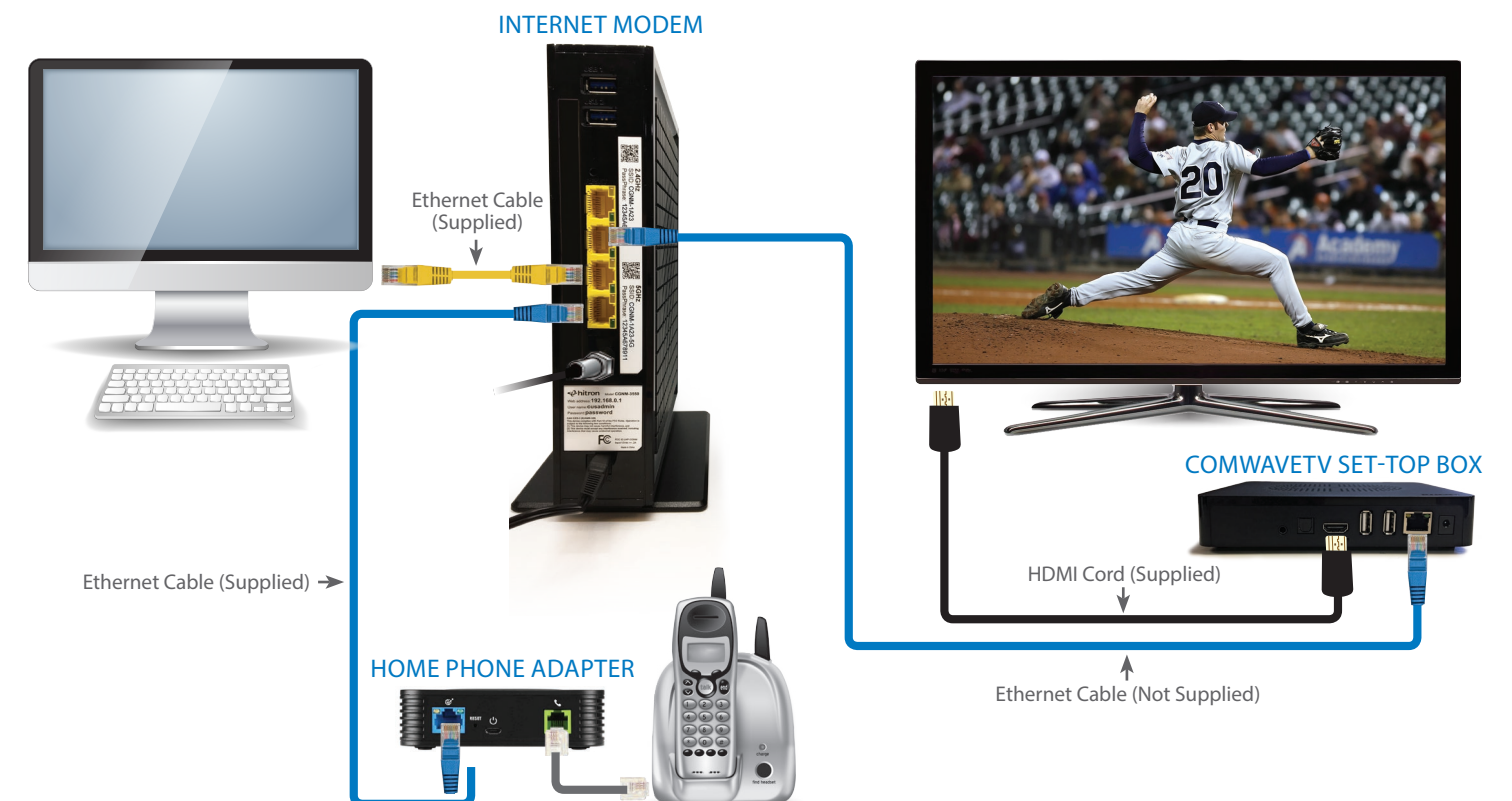

STEP A - INTERNET

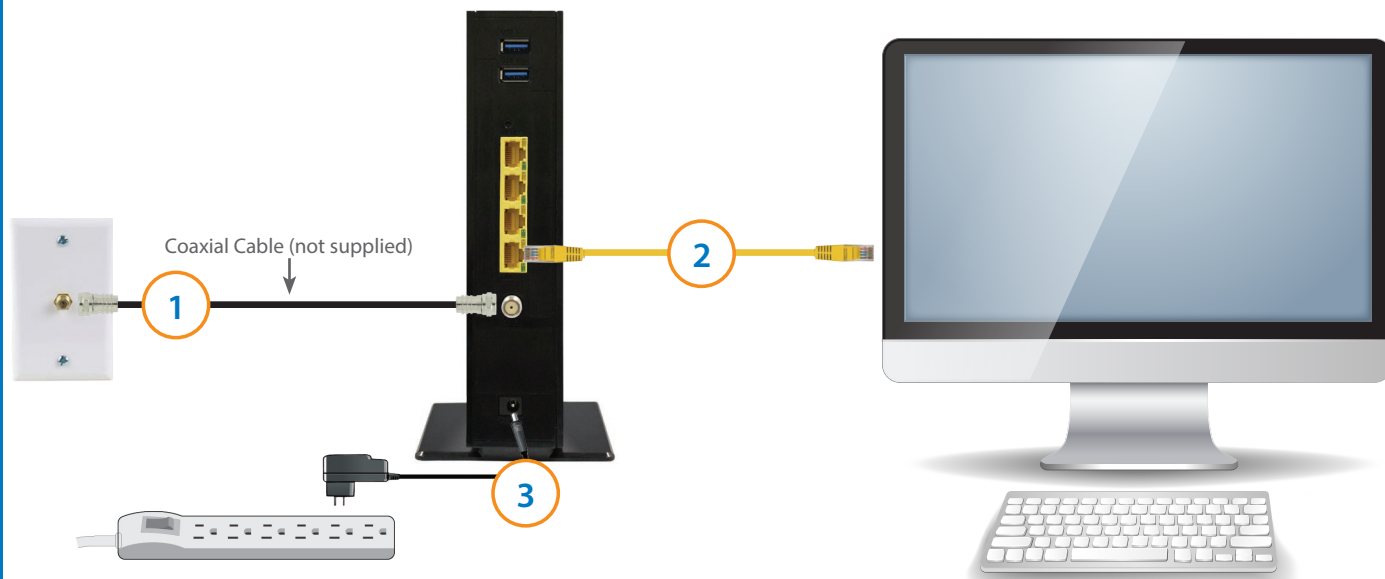

- 1 Connect the Comwave Internet Modem using a coaxial cable outlet in your home.
- 2 Connect one end of the supplied Ethernet Cable to the Internet Modem and the other end to your computer. For Wi-Fi instructions see below.
- 3 Connect the Internet modem to power using the supplied power adapter. **Note: Wait until the @ (Online) LED light indicator on your Internet Modem is steady green and operational. This may take up to 5 minutes.**

Start your computer. You should be able to browse the internet instantly.

SETTING UP YOUR WI-FI

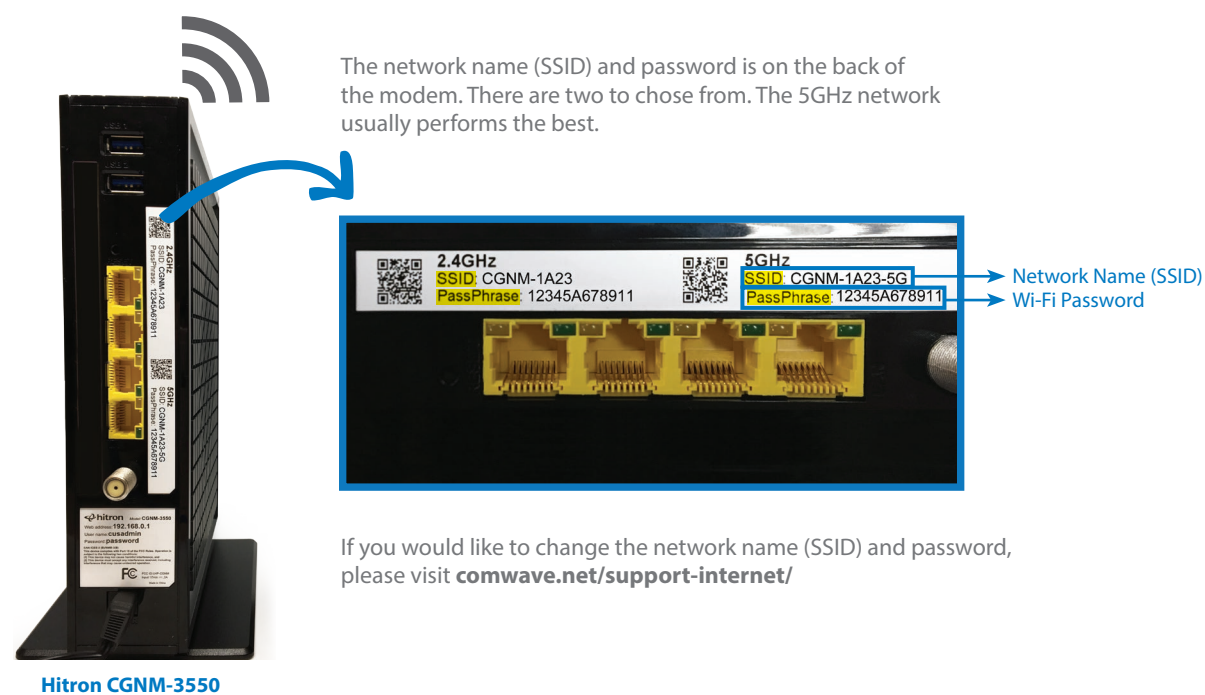

STEP B - TV

NOTE: FOR THE BEST TV EXPERIENCE, WE RECOMMEND THE INTERNET MODEM TO BE AS CLOSE AS POSSIBLE TO YOUR MAIN TV. Once steps are completed, turn on your TV and select the correct HDMI input. Follow the on-screen instructions to connect ComwaveTV to your network.

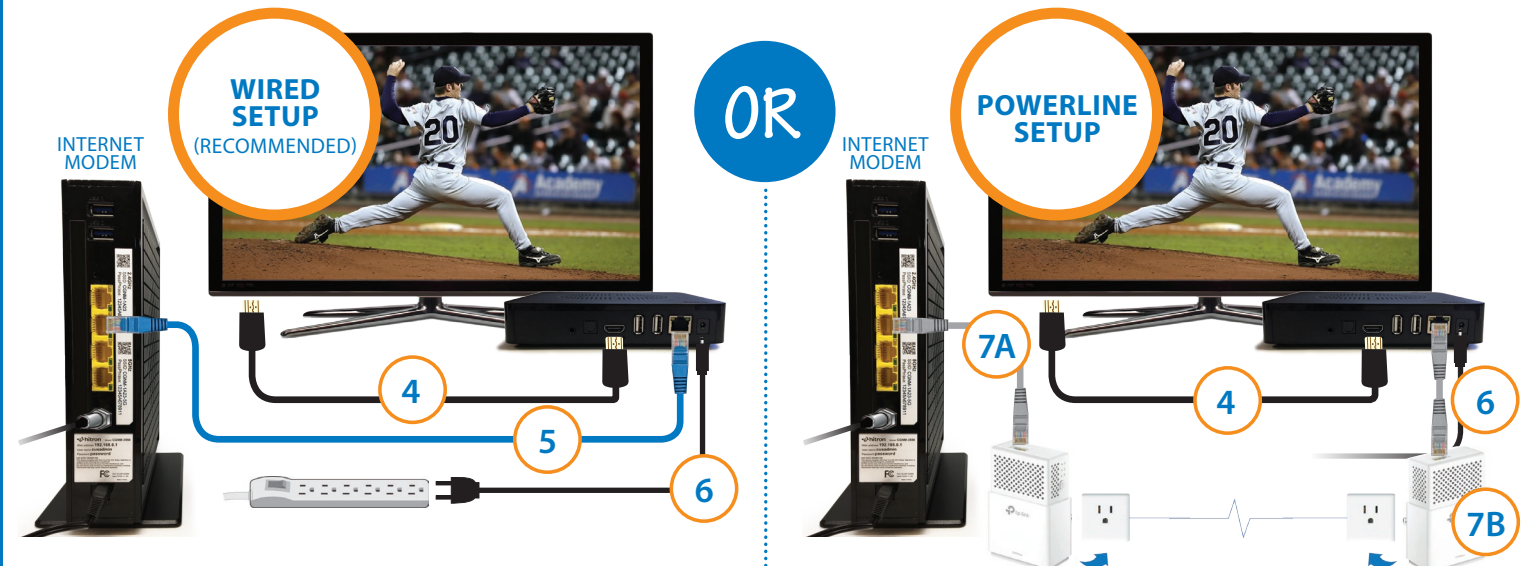

- 4 Using the supplied HDMI cable, connect one end to an **HDMI** port on your TV and the other end to the ComwaveTV set-top box. **Note: Remember which HDMI port you used on your TV.**
- 5 (*Wired Network - Recommended*) Connect an Ethernet cable from one end of the ComwaveTV set-top box to any LAN port on the Modem.
- 6 Connect the ComwaveTV set-top box to power using the supplied power adapter.
- 7 (*Powerline Setup*) A. Connect one of the Powerline Adapters to a LAN port on the Internet Modem using the Ethernet cable and plug the Powerline Adapter into a wall outlet. B. Plug the other Powerline Adapter into a wall outlet and connect to your TV set-top box using an Ethernet cable.

STEP C - PHONE

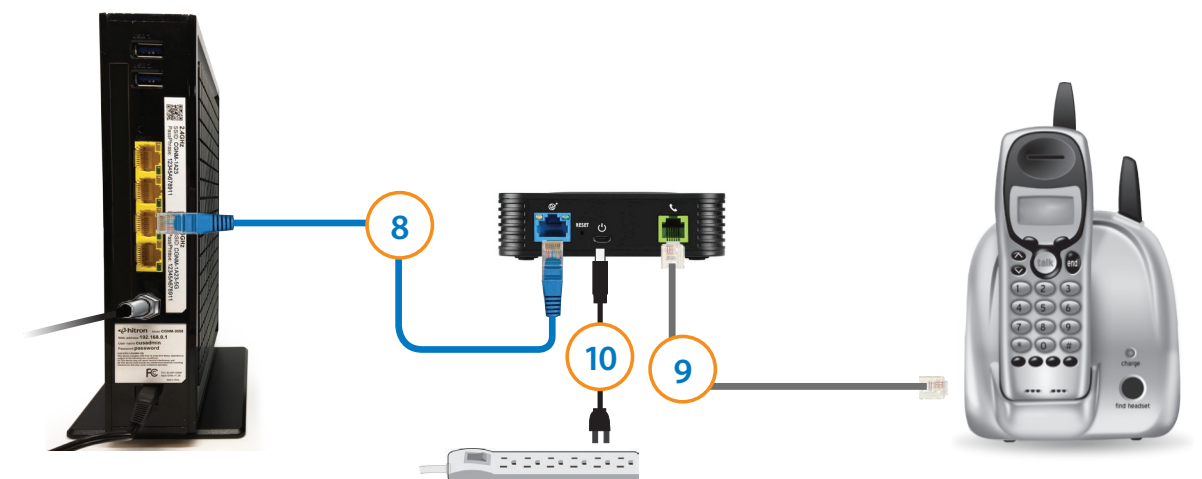

- 8 Connect one end of the supplied Ethernet Cable to the **WAN** port of the Home Phone Adapter and the other to any LAN port on the modem.
- 9 Connect your telephone to the **PHONE** port of the Home Phone Adapter.
- 10 Connect the Home Phone Adapter to power using the supplied power adapter. **Note: Wait 5 minutes and do not disconnect power as you could cause damage to the Home Phone Adapter.**
- 11 To test your phone line, pick up the phone receiver and listen for a dial tone. If you have no dial tone, please call Comwave support (phone number is on the back).

You have now completed all the installation steps. Thank you for choosing Comwave.

Enjoy your services!