



Furnishing Imagination

2019 Introductions

Bath Collection

Table of Contents... *by Alphabetical Order*

2019 NEW INTRODUCTIONS

Contemporary

Ambassador - Burnt Chocolate (1542)	(PATENT PENDING)	pg. 2
Ambassador - Antique Grey (1543)	(PATENT PENDING)	pg. 3
Revival - Glossy Medium Gray (1546)	(PATENT PENDING)	pg. 6
Revival - Glossy White (1547)	(PATENT PENDING)	pg. 7
M4 - Smoke (1545)	PAT. US# D771.415	pg. 10

Lifestyle

River View - Toasted Almond (1515)		pg. 12
River View - Coffee Bean (1516)		pg. 13
Shaker Americana - Light Gray (1514)		pg. 16

Classic

Charlottesville w/Brass - Polar White (1509)		pg. 18
Charlottesville w/Brass - Vintage Black (1539)		pg. 19

Storage:

Drawer Organizer		pg. 21
------------------	--	--------

Tops:

fdSTONE™		pg. 22
Quartz		pg. 23



Ambassador (1542)

Finish: Burnt Chocolate

Shown above:

1542-V6021D 60" Double Bowl Vanity

TQ-S6022DSG8 2" - 60" Double Bowl Spectre Gray Quartz Top (8" spread)

S-200WH Rectangular - White Ceramic Sink (2 shown)

1542-M24 24" Mirror (2 shown)

PATENT PENDING



Ambassador (1543)

Finish: Antique Grey

Shown above:

1543-V6021D 60" Double Bowl Vanity

T3-S6022DWC 3cm (1¼") 60" Double Bowl White Carrera Marble Top (8" spread)

S-200WH Rectangular - White Ceramic Undermount Sink (2 shown)

1543-M24 24" Mirror (2 shown)

PATENT PENDING

Ambassador (1542 / 1543)

PATENT PENDING

Materials: White Oak Solids / White Oak Veneers
Hinges: Fully Concealed, Soft Closing
Drawer Glides: Soft Closing, Undermount
Drawer Box: 1/2" Solids, 4-sided English Dovetail
Hardware: Brass Trim
Leg: Brass tone (anodized stainless steel)
Finish: 1542-Burnt Chocolate / 1543-Antique Grey



1542-V24 / 1543-V24
24" Vanity
w24" x d21 1/2" x h34 1/2"
Drawer: 3
Top drawer: U-shape with two removable dividers on each side



1542-V48 / 1543-V48
48" Vanity
w48" x d22" x h34 1/2"
Door: 2
Drawer: 6
Shelf: 1 (adjustable)
Top two drawers: complete with three removable dividers each
Shelf includes: built-in power station with 2 AC outlets, 2 USB ports, power switch



1542-V30 / 1543-V30
30" Vanity
w30" x d21 1/2" x h34 1/2"
Drawer: 3
Top drawer: U-shape with two removable dividers on each side



1542-V6021D / 1543-V6021D
60" Double Bowl Vanity
w60" x d22" x h34 1/2"
Door: 4
Drawer: 3
Shelf: 2 (adjustable)
Top drawer: complete with three removable dividers
Shelf includes: built-in power station with 2 AC outlets, 2 USB ports, power switch



1542-V36 / 1543-V36
36" Vanity
w36" x d21 1/2" x h34 1/2"
Drawer: 3
Top drawer: U-shape with three removable dividers on each side



1542-M24 / 1543-M24
24" Mirror
w24" x d1¼" x h36"



1542-M28 / 1543-M28
28" Mirror
w28" x d1¼" x h36"



Built-in power station
shelf mounted on
Ambassador 48" & 60" vanities



Removable drawer dividers as
shown on the 48"
*other vanity size may feature
a different configuration



Revival (1546)

Finish: Glossy Medium Gray

Shown above:

1546-V42 42" Vanity

TQ2-S43225G8 2cm (3/4") 43" Spectre Gray Quartz Top (8" spread)

S-200WH Rectangular - White Ceramic Sink

1546-M28 28" Mirror

PATENT PENDING



Revival (1547)

Finish: Glossy White

Shown above:

1547-V42 42" Vanity

T3-S4222WC 3cm (1¼") 42" White Carrera Marble Top (8" spread)

S-200WH Rectangular - White Ceramic Sink

1547-M28 28" Mirror

PATENT PENDING

Revival (1546 / 1547)

PATENT PENDING

- Materials:** Poplar Solids / MDF
- Hinges:** Fully Concealed, Soft Closing
- Drawer Glides:** Soft Closing, Undermount
- Drawer Box:** 1/2" Solids, 4-sided English Dovetail
- Hardware:** Brushed Nickel (3 3/4" / 97mm - c-c),
- Leg:** Brushed Stainless Steele
- Finish:** 1546-Glossy Medium Gray / 1547-Glossy White



1546-V24 / 1547-V24
24" Vanity
 w24" x d22" x h34 1/2"
Drawer: 1 (concealed)
Shelf: 1 (fixed)
Shelf includes: built-in power station with 2 AC outlets, 2 USB ports, power switch



1546-V42 / 1547-V42
42" Vanity
 w42" x d22" x h34 1/2"
Door: 1 (hinge-right)
Drawer: 6
Shelf: 1 (adjustable)
Top two drawers: complete with three removable dividers each
Shelf includes: built-in power station with 2 AC outlets, 2 USB ports, power switch



1546-V30 / 1547-V30
30" Vanity
 w30" x d22" x h34 1/2"
Door: 2
Drawer: 1 (concealed)
Shelf: 1 (fixed)
Shelf includes: built-in power station with 2 AC outlets, 2 USB ports, power switch



1542-V48 / 1543-V48
48" Vanity
 w48" x d22" x h34 1/2"
Door: 2
Drawer: 6
Shelf: 1 (adjustable)
Top two drawers: complete with three removable dividers each
Shelf includes: built-in power station with 2 AC outlets, 2 USB ports, power switch



1546-V36R / 1547-V36R
36" Vanity Drawer-right
 w36" x d22" x h34 1/2"
Door: 2
Drawer: 3
Shelf: 1 (adjustable)
Top drawer: complete with three removable dividers
Shelf includes: built-in power station with 2 AC outlets, 2 USB ports, power switch



1546-V6021D / 1547-V6021D
 60" Double Bowl Vanity
 w60" x d22" x h34½"
 Door: 4
 Drawer: 3
 Shelf: 2 (adjustable)
 Top drawer: complete with three
 removable dividers
 One Shelf includes: built-in power
 station with 2 AC outlets, 2 USB
 ports, power switch

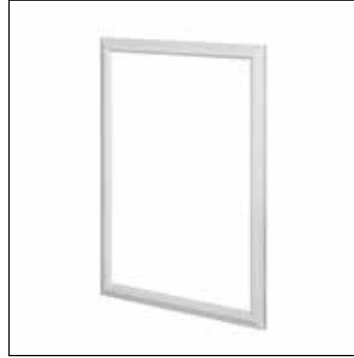

1546-M24 / 1547-M24
 24" Mirror
 w24" x d1¼" x h36"



1546-V7221D / 1547-V7221D
 72" Double Bowl Vanity
 w72" x d22" x h34½"
 Door: 4
 Drawer: 3
 Shelf: 2 (adjustable)
 Top drawer: complete with three
 removable dividers
 One Shelf includes: built-in power
 station with 2 AC outlets, 2 USB
 ports, power switch



1546-M28 / 1547-M28
 28" Mirror
 w28" x d1¼" x h36"



Built-in power station
 shelf mounted on
 all Revival vanities



1546-MCP20R / 1546-MCP20L
 1547-MCP20R / 1547-MCP20L
 20" Medicine Cabinet-Right/Left
 w20" x d5¾" x h30"
 Door: 1
 Shelf: 2 (glass-adjustable)
 1 (fixed-wood)
 Wood shelf: includes built-in power
 station with 2 AC outlets, 2 USB ports,
 power switch
 1" dia. Interior light automatically
 illuminates when door opened



M4. (1545)

Finish: Smoke

Shown above:

1545-V48 48" Vanity

TS4-S4922MW8 4cm (1½") 49" Matte White fdSTONE™ Top (8" spread)

1545-M24 24" Mirror

PAT. US# D771.415

M4. (1545)

Materials: Hackberry Solids, Fumed Red Gum Veneers
Hinges: Fully Concealed, Soft Closing
Drawer Glides: Soft Closing, Undermount
Drawer Box: 1/2" Solids, 4-sided English Dovetail
Metal Trim/Leg: 1 1/4" metal plate/1" square tube, Powder-coated Gunmetal Gray
Finish: 1545-Smoke



1545-V24 | 24" Vanity
 w24" x d21 1/2" x h34 1/2"
Drawer: 1 (push-open)
Shelf: 1 (open-fixed),
 1 (concealed-fixed)



1545-V36 | 36" Vanity
 w36" x d21 1/2" x h34 1/2"
Drawer: 1 (push-open)
 1 (concealed, pull-open)
Shelf: 1 (open-fixed)



1545-V30 | 30" Vanity
 w30" x d21 1/2" x h34 1/2"
Drawer: 1 (push-open)
Shelf: 1 (open-fixed),
 1 (concealed-fixed)



1545-V48 | 48" Vanity
 w48" x d21 1/2" x h34 1/2"
Drawer: 3 (push-open)
 2 (concealed, pull-open)
Shelf: 1 (open-fixed)



1545-WV24 | 24" Wall Mount Vanity
 w24" x d21 1/2" x h17 1/2"
Drawer: 1 (push-open)
Shelf: 1 (concealed-fixed)



1545-WV36 | 36" Wall Mount Vanity
 w36" x d21 1/2" x h17 1/2"
Drawer: 1 (push-open)
 1 (concealed, pull-open)



1545-WV30 | 30" Wall Mount Vanity
 w30" x d21 1/2" x h17 1/2"
Drawer: 1 (push-open)
Shelf: 1 (concealed-fixed)



1545-M24 | 24" Mirror
 w24" x d1" x h34"



River View (1515)

Finish: Toasted Almond

Shown above:

1515-V6021D 60" Double Bowl Vanity

TQ2-V6022DCQ1 2cm (3/4") 60" Double Bowl Carrera Quartz Vessel Top

S-11021W1 22x18" White Ceramic Sink (single hole) (2 shown)

1515-M25 25" Mirror (2 shown)



River View (1516)

Finish: Coffee Bean

Shown above:

1516-V42 42" Vanity

TS4-S4322MW8 4cm (1½") 43" Matte White fdSTONETM Top (8" spread)

1516-M30 30" Mirror

River View (1515 / 1516)

Materials: Solid Pine
Hinges: Fully Concealed, Soft Closing
Drawer Glides: Soft Closing, Undermount
Drawer Box: ½" Solids, 4-sided English Dovetail
Hardware: Matte Black
Finish: 1515-Toasted Almond
 1516-Coffee Bean



1515-V24 / 1516-V24 | 24" Vanity
 w24" x d21½" x h34½"
 Door: 2
 Shelf: 1 (adjustable)



1515-V42 / 1516-V42 | 42" Vanity
 w42" x d21½" x h34½"
 Door: 1 (hinge-right)
 Shelf: 1 (adjustable)
 Drawer: 6



1515-V30 / 1516-V30 | 30" Vanity
 w30" x d21½" x h34½"
 Door: 2
 Drawer: 1 (concealed)



1515-V48 / 1516-V48 | 48" Vanity
 w48" x d21½" x h34½"
 Door: 2
 Shelf: 1 (adjustable)
 Drawer: 6



1515-V36 / 1516-V36 | 36" Vanity
 w36" x d21½" x h34½"
 Door: 2
 Drawer: 1 (concealed)



1515-V6021D / 1516-V6021D | 60"
 Double Bowl Vanity
 w60" x d21½" x h34½"
 Door: 4
 Shelf: 2 (adjustable)
 Drawer: 3



1515-V7221D / 1516-V7221D | 72"
 Double Bowl Vanity
 w72" x d21½" x h34½"
 Door: 4
 Shelf: 2 (adjustable)
 Drawer: 3



1515-M25 / 1516-M25 | 25" Mirror
 w25" x d1½" x h36"



1515-FV36A / 1516-FV36A | 36"
 Farmhouse Vanity
 w36" x d22" x h34½"
 Door: 2
 Drawer: 1 (concealed)



1515-M30 / 1516-M30 | 30" Mirror
 w30" x d1½" x h36"



1515-FV48A / 1516-FV48A | 48"
 Farmhouse Vanity
 w48" x d22" x h34½"
 Door: 2
 Drawer: 6



1515-HT2009 / 1516-HT2009 |
 20x9" Hutch
 w20" x d9" x h34¼"
 Shelf: 2

-Use with
 1515 / 1516-B2116 to make linen tower
 (sold separately)
 *can be wall mounted



Linen Tower
 w21" x d16½" x h70"



1515-B2116 / 1516-B2116 | 21x16"
 Linen Base
 w21" x d16½" x h35½"
 Drawer: 3

-Use with
 1515 / 1516-HT2009 to make linen tower
 (sold separately)



Shaker Americana (1514)

Finish: Light Gray

Shown above:

1514-VH48 48" Open Shelf Vanity

TQ-S4822BZ8 2inch - 48" Blizzard Quartz Top (8" spread)

S-200WH Rectangular - White Ceramic Undermount Sink

1514-M28 28" Mirror

Shaker Americana (1514)

Materials: Poplar solids, Hardwood Veneers
Hinges: Fully Concealed, Soft Closing
Drawer Glides: Soft Closing, Undermount
Drawer Box: ½" Solids, 4-sided English Dovetail
Hardware: Brushed Nickel
Finish: 1514-Light Gray



1514-VH24 | 24" Open Shelf Vanity
w24" x d21½" x h34½"
Door: 2



1514-VH48 | 48" Open Shelf Vanity
w48" x d21½" x h34½"
Door: 2
Drawer: 4



1514-VH30 | 30" Open Shelf Vanity
w30" x d21½" x h34½"
Door: 2



1514-VH6021D | 60" Double Bowl
Open Shelf Vanity
w60" x d21½" x h34½"
Door: 4



1514-VH36 | 36" Open Shelf Vanity
w36" x d21½" x h34½"
Door: 2



1514-M24 | 24" Mirror
w24" x d2" x h34"
1514-M28 | 28" Mirror
w28" x d2" x h34"



Charlottesville w/Brass (1509)

Finish: Polar White

Shown above:

1509-V48A 48" Vanity - Door

T3-S4822WC 3cm (1¼") 48" White Carrera Marble Top (8" spread)

S-200WH Rectangular - White Ceramic Undermount Sink

1509-M28 28" Mirror



Charlottesville w/Brass (1539)

Finish: Vintage Black

Shown above:

1539-V48A 48" Vanity

T3-S4822WC 3cm (1¼") 48" White Carrera Marble Top (8" spread)

S-200WH Rectangular - White Ceramic Undermount Sink

1511-M28 28" Mirror

Charlottesville w/Brass (1509 / 1539)

Materials: Hackberry Solids, White Oak Veneers
Hinges: Fully Concealed, Soft Closing
Drawer Glides: Soft Closing, Undermount
Drawer Box: ½" Solids, 4-sided English Dovetail
Hardware: Brass
Finish: 1509-Polar White
 1539-Vintage Black



1509-V24 / 1539-V24 | 24" Vanity
 w24" x d21½" x h34½"
 Drawer: 2



1509-V42 / 1539-V42 | 42" Vanity
 w42" x d21½" x h34½"
 Drawer: 3



1509-V30 / 1539-V30 | 30" Vanity
 w30" x d21½" x h34½"
 Drawer: 2



1509-V48A / 1539-V48A | 48"
 Vanity - Door
 w48" x d21½" x h34½"
 Door: 2
 Shelf: 1 (adjustable)
 Drawer: 6



1509-V36 / 1539-V36 | 36" Vanity
 w36" x d21½" x h34½"
 Drawer: 3



1509-M24 / 1511-M24 | 24" Mirror
 w24" x d11/6" x h36"
 1509-M28 / 1511-M28 | 28" Mirror
 w28" x d11/6" x h36"

Drawer Organizer

Materials: Drawer Organizer

*fits most Fairmont Designs drawers

*confirm drawer sizing before ordering



ADO-6x12 | 6x12" Drawer Organizer
w6" x d12½" x h3"



ADO-8x14 | 8x14" Drawer Organizer
w8" x d14½" x h3"

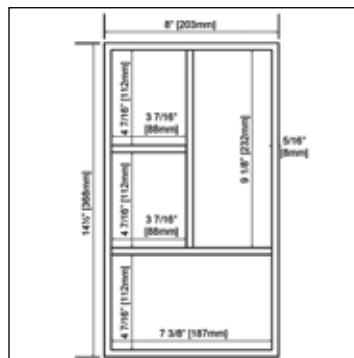
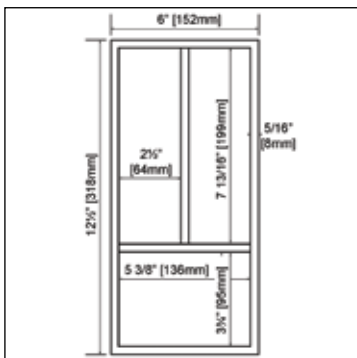

Natural Stone Tops



2cm ¾", Ogee Edge

White Carrera (WC) - Marble

25", 31", 37", 43", 49", 61" (single and double bowl)
73" (double bowl) - 8" widespread



3cm (1¼") Ease Edge

White Carrera (WC) - Marble

30", 36", 42", 48", 60" (double bowl) - 8" widespread



Black Absolute (BA) - Granite

25", 31", 37", 49" - 8" widespread



Black Absolute (BA) - Granite

30", 36", 48" - 8" widespread

Features:

- Back splash included, side splashes NOT available
- All Natural Stone Tops are pre-sealed at factory, but we highly recommend a sealer is applied after installation and repeated every three months.

4cm (1½") fdSTONE™



Matte White (MW1), single hole

25" 31", 37"



Matte White (MW8), 8" spread

25", 31", 37", 43", 49", 61" (double bowl)

Features:

- 4cm (1½") thick, Ease Edge with overflow
- Integral rectangular bowl
- Back splash NOT available, side splashes NOT available
- Pure acrylic

Engineered 2" Quartz Tops



Blizzard (BZ)
30", 36", 42", 48", 60" (double bowl)
72" (double bowl) - 8" widespread
24", 30", 36", 48", 60" (double bowl) - single hole



Eggshell (EG)
30", 36", 48", 60" (double bowl)
72" (double bowl) - 8" widespread



Carrera Quartz (CQ)
30", 36", 42", 48", 60" (double bowl)
72" (double bowl) - 8" widespread
24", 30" - single hole

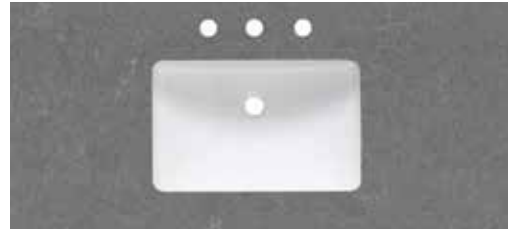

Spectre Gray (SG)
30", 36", 42", 48", 60" (double bowl)
72" (double bowl) - 8" widespread
24", 30" - single hole

Features:

2" profile, Ease Edge

- Sink cutout pre-cut (17 7/8x11") to fit rectangular undermount sink (S-200)
- Back splash included, optional Quartz side splash available (sold separately)

Engineered 2cm ¾" Quartz Tops - Oval



Carrera Quartz (CQ)
25", 31", 37", 43", 49", 61" (single and double bowl)
73" (double bowl)



Eggshell (EG)
25", 31", 37", 43", 49", 61" (single and double bowl)
73" (double bowl)



Crema (CM)
25", 31", 37", 43", 49", 61" (single and double bowl)

Features:

¾", Ogee Edge, pre-drilled for 8" widespread faucet

- Sink cutout pre-cut 16½x13½" to fit oval undermount sink (S-100)
- Back splash included, optional Quartz side splashes available (sold separately)

Engineered 2cm ¾" Quartz Tops - Rectangular



Carrera Quartz (CQ)
25", 31", 37", 43", 49", 61" (single and double bowl)
73" (double bowl) - 8" widespread
25", 31", 37", 49", 61", 73" (double bowl) - single hole



Spectre Gray (SG)
25", 31", 37", 43", 49", 61" (single and double bowl)
73" (double bowl) - 8" widespread
25", 31", 37" - single hole



Crema (CM)
25", 31", 37", 43", 49", 61" (double bowl),
73" (double bowl) - 8" widespread

Features:

¾", Ease Edge

- Sink cutout pre-cut (17 7/8x11") to fit rectangular undermount sink (S-200)
- Back splash included, optional Quartz side splashes available (sold separately)

Engineered 2cm $\frac{3}{4}$ " Quartz Tops - Rectangular - Offset Sink



Carrera Quartz (CQ)
37" - 8" widespread

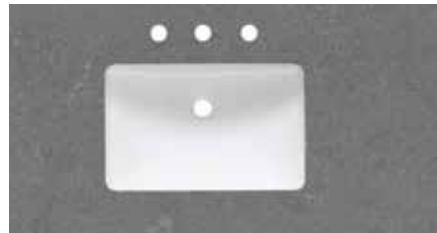

Spectre Gray (SG)
37" - 8" widespread



Crema (CM)
37" - 8" widespread

Features:

$\frac{3}{4}$ ", Ease Edge, pre-drilled for 8" widespread faucet

- Sink cutout pre-cut (17 $\frac{7}{8}$ x11") to fit rectangular undermount sink (S-200)
- Back splash included, optional Quartz side splashes available (sold separately)

Engineered 2cm ($\frac{3}{4}$ ") Quartz Tops - Vessel



Carrera Quartz (CQ)
36", 48", 60" (double bowl) - 8" widespread

Features:

$\frac{3}{4}$ ", Ease Edge, pre-drilled for 8" widespread faucet

- Sink cutout pre-cut to fit drop-in 22x18" sink (S-11021W1)
- Back splash included, optional Quartz side splashes available (sold separately)

11/16" Ceramic Tops



White (W8), 8" spread
25", 31", 37", 43", 49"



White (W1), single hole
25", 31", 37", 43", 49"

Features:

11/16" thick, Ease Edge

- Overall depth: 7"
- Water depth: 4" (102mm)
- Drain hole: 1¾" (45mm)
- Integral rectangular bowl
- Back splash NOT available, side splashes NOT available
- Individually packed in molded Styrofoam carton

3cm (1¼") Ceramic Tops



White (W8), 8" spread
25", 31", 37", 43", 49"



White (W1), single hole
25", 31", 37", 43", 49"

Features:

3cm (1¼") thick, Ease Edge

- Overall depth: 7"
- Water depth: 4" (102mm)
- Drain hole: 1¾" (45mm)
- Integral rectangular bowl
- Back splash NOT available, side splashes NOT available
- Individually packed in molded Styrofoam carton

Sinks - Specialty

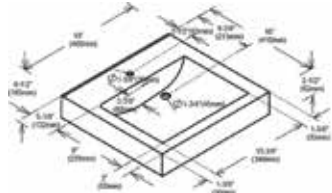

S-11018W1 | 18x16" Ceramic Sink

w18" x d16" x h2½" / with overflow

Pre-drilled: W1 / single hole

Fits 18x16 (V1816 or WV1816): Charlottesville w/Nickel, Shaker Americana, Studio One

Overall depth: 6½" / Water depth: 31/8" / Drain hole: 1¾" (45mm)

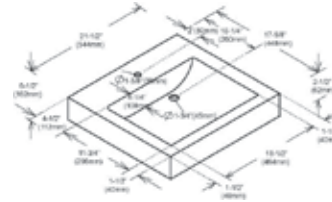

S-11021W1 | 22x18" Ceramic Sink

w22" x d18" x h2½" / with overflow

Pre-drilled: W1 / single hole

Fits 21x18 (V2118 or WV 2118): Charlottesville w/Nickel, Framingham, M4, Oasis, Shaker Americana, Smithfield, Studio One

Overall depth: 6½" / Water depth: 31/8" / Drain hole: 1¾" (45mm)

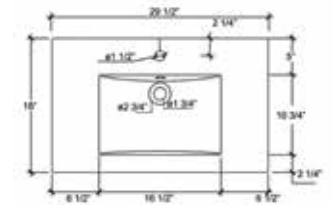

S-11030W1 | 30x18" Ceramic Sink

w29½" x d18" x h3" / with overflow

Pre-drilled: W1 / single hole

Fits 30x18 (V3018 or WV 3018): Charlottesville w/Nickel, M4, Oasis, Shaker Americana, Studio One

Overall depth: 6½" / Water depth: 4" / Drain hole: 1¾" (45mm)

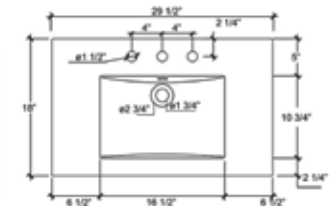

S-11030W8 | 30x18" Ceramic Sink

w29½" x d18" x h3" / with overflow

Pre-drilled: W8 / 8" widespread

Fits 30x18 (V3018 or WV3018): Charlottesville w/Nickel, M4, Oasis, Shaker Americana, Studio One

Overall depth: 6½" / Water depth: 4" / Drain hole: 1¾" (45mm)

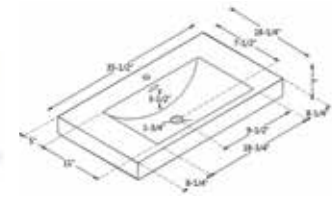

S-11036W1 | 36x18" Ceramic Sink

w35½" x d18¼" x h3¼" / with overflow

Pre-drilled: W1 / single hole

Fits 36x18 (V3618 or WV3618): Charlottesville w/Nickel, M4, Oasis, Shaker Americana, Studio One

Overall depth: 7" / Water depth: 3¼" / Drain hole: 1¾" (45mm)

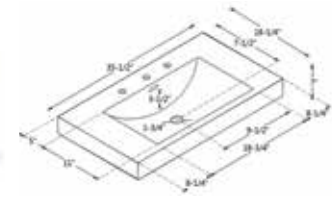

S-11036W8 | 36x18" Ceramic Sink

w35½" x d18¼" x h3¼" / with overflow

Pre-drilled: W8 / 8" widespread

Fits 36x18 (V3618 or WV3618): Charlottesville w/Nickel, M4, Oasis, Shaker Americana, Studio One

Overall depth: 7" / Water depth: 3¼" / Drain hole: 1¾" (45mm)

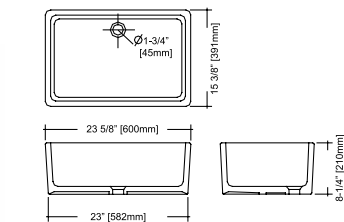

S-F2416WH | 24x16" Apron Sink - Fireclay

w23-5/8" x h15-3/8" x d8¼"

Drain sold separately

No overflow

Fits Farmhouse Vanity: Crosswinds, Homestead, Napa, Rustic Chic

Overall depth: 8½", Drain hole: 1¾" (45mm)



6950 Noritsu Ave.
Buena Park, CA 90620
www.fairmontdesigns.com
bath@fairmontdesigns.com

BATH-190201

©2018 Fairmont Designs. All Rights Reserved.

