



Where spectacular design meets stellar service.



- | | | | |
|--------------------|-----------------------------|------------------|-------------|
| WIRELESS | IN-ROOM COFFEE | HAIR DRYER | EXERCISE |
| MEETING FACILITIES | IN-ROOM SAFE | AIR CONDITIONING | POOL |
| BUSINESS CENTER | EXECUTIVE FLOOR | IRON | SPA |
| CAR PARKING | HIGH-SPEED INTERNET | RESTAURANT | WHIRLPOOL |
| NO SMOKING ROOMS | ACCESSIBLE ROOMS/FACILITIES | IN-ROOM DINING | LIVING WELL |

Hilton Americas-Houston
1600 Lamar Street
Houston, Texas 77010
713.739.8000 Fax: 713.577.6140
houcv.ds@hilton.com

americashouston.hilton.com



High-tech. High-touch. Cutting-edge.
Designed BY meeting planners FOR meeting planners

HOTEL FEATURES

- Prime downtown location near key attractions
- 1200 luxury guest rooms with 31 suites, including four Presidential
- Four Executive Level floors with exclusive access to R24 Executive Rooftop Lounge
- 92,000 sq. ft. of flexible function space on three floors
- Connected on two floors by skywalks to the 1M sq. ft. George R. Brown Convention Center
- Two ballrooms, 30 breakout rooms
- High Speed Wi-Fi throughout
- Collection of dining options to meet every need
- Skyline Spa & Health Club
- Valet and self-parking in attached 1450-car garage

GUEST ROOM FEATURES

- 490 King guest rooms
- 679 Queen Queen guest rooms
- 5 Standard Suites; 21 Deluxe Suites; Lamar Suite
- 4 Presidential Suites
- Mini refrigerator
- Wi-Fi and High Speed Internet access
- Two dual-line phones with voice mail
- Waldorf Astoria Serta Perfect Sleeper® pillow-top mattress
- High-definition flat screen TV features the DIRECTV Residential Experience
- Hilton Cuisinart coffeemaker with coffee and teas
- Personal safe, hair dryer, iron and ironing board
- In-room dining available
- Allergy-free PURE Rooms available

MEETING FACILITIES & SERVICES

- 92,000 sq. ft. of technologically advanced function space grouped into three floors
- Connected by skywalks on two floors to the George R. Brown Convention Center
- 40,000 sq. ft. Lanier Grand Ballroom and 26,000 sq. ft. Ballroom of the Americas feature elegant pre-function areas with a view, floor pockets with Ethernet connections, rigging points and theatrical light and sound
- 30 breakout rooms, including three boardrooms
- High Speed Wi-Fi throughout
- Full-service FedEx Office® Print & Ship Center located adjacent to meeting rooms, with 24-hour access to computer rental, copying, printing and faxing
- Online tools to manage group meetings, reservations and events
- Award-winning teams of meeting, catering, culinary and banquet professionals

DELECTABLY DIVERSE DINING

- The Lobby Bar features light fare and beer, wine and specialty cocktails
- All day dining at 1600 Bar+Grille, which features local, seasonal produce plus Certified Angus Beef and Gulf Coast Seafood
- Pappasito's Cantina features sizzling fajitas, Tex-Mex favorites, ceviche and crudos
- Pappasito's Bar features handcrafted margaritas, fine tequilas, beer, wine and cocktails
- Starbucks, located lobby level, offers the full menu customers know and love as well as Starbucks Reserve® limited availability coffees roasted at Starbucks Reserve Roastery and Tasting Room in Seattle

- In-room dining serving restaurant menu favorites for Breakfast, All-Day Dining and Late Night, plus hors d'oeuvres and spirits for entertaining

RECREATION & RELAXATION

- The state-of-the-art Skyline Spa & Health Club features free weights and award-winning Precor® fitness equipment
- Luxurious Skyline Spa provides professional facial and body treatments for men and women
- 75-foot indoor infinity edge lap pool and whirlpool with skyline view
- Adjacent Skyline Terrace for sun, shade or soaking up the dazzling view

SURROUNDING ATTRACTIONS

- Only steps to Avenida Houston, the newest place to sip, stroll and savor in downtown Houston. Named for the boulevard fronting both Hilton Americas-Houston and the George R. Brown Convention Center, the entertainment district features 10 new restaurants, pedestrian plaza, unique art installations, nightlife and events
- Minutes to major sports, theaters, museums, shopping, dining and entertainment
- Overlooking Discovery Green Park and two blocks from GreenStreet, a multi-purpose entertainment complex
- Two blocks from Minute Maid Park (Houston Astros); one block to Toyota Center (Houston Rockets)

Level Two

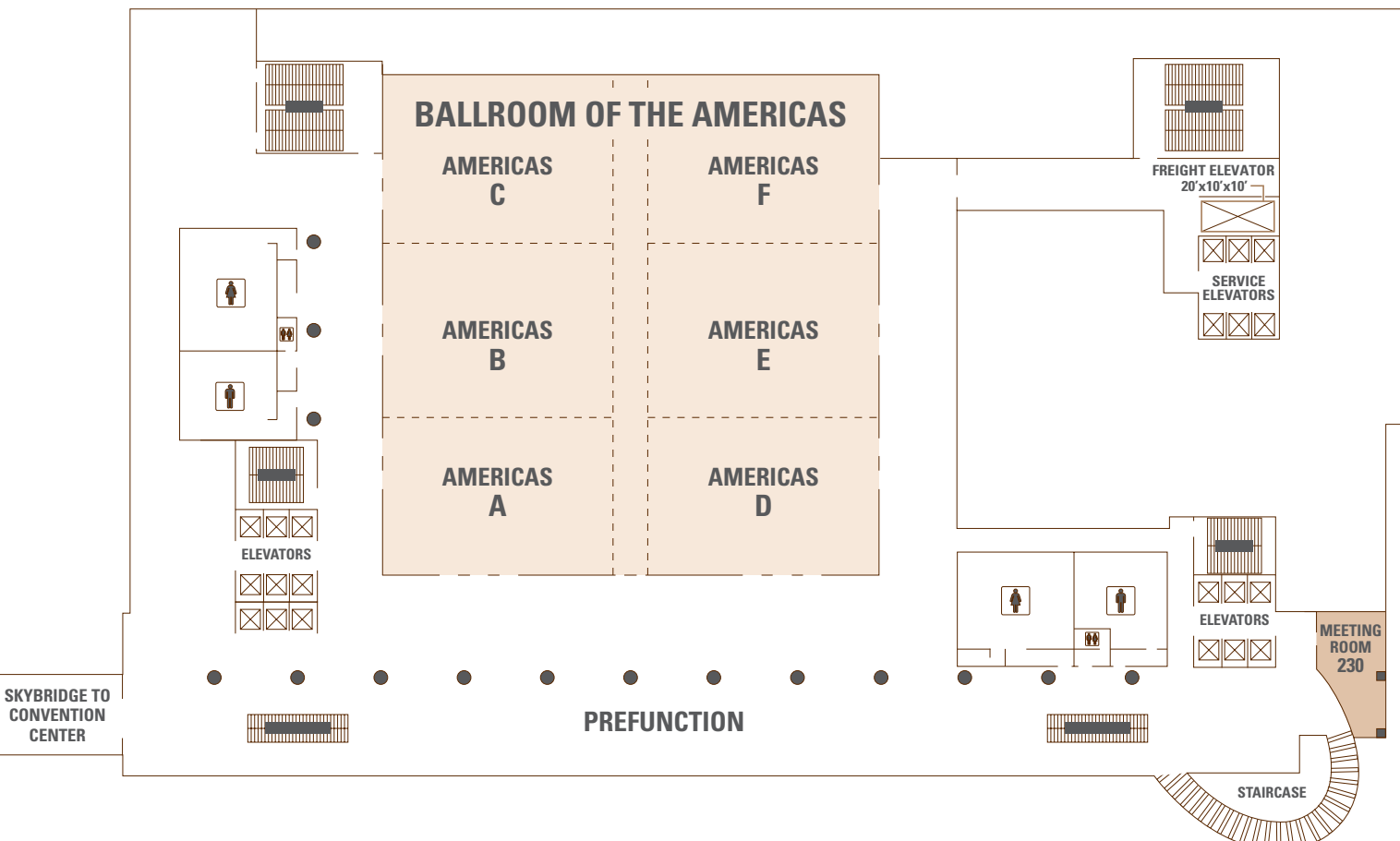

LEVEL TWO

	Dimensions	Square Feet	Classroom	Theatre	Conference	Banquet	U-Shape	Reception	Hollow Square	Exhibit 8x10	Exhibit 10x10
Meeting Room 230	21'-9" x 38'-7" x 10'	694	24	58	24	30	18	69	24	—	—
Ballroom of the Americas	155'-9" x 165'-2" x 23'	25,895	1,438	2,354	—	2,070	—	2,589	—	180	140
Americas A	48'-7" x 76'-4" x 23'	3,775	194	343	44	270	50	375	64	—	—
Americas B	54'-5" x 76'-4" x 23'	4,202	215	382	48	320	54	420	70	—	—
Americas C	52' x 76'-4" x 23'	4,034	207	367	48	290	52	400	64	—	—
Americas D	48'-7" x 76'-4" x 23'	3,775	194	343	44	270	50	375	64	—	—
Americas E	54'-5" x 76'-6" x 23'	4,202	215	382	48	320	54	420	70	—	—
Americas F	52' x 76'-6" x 23'	4,036	207	367	48	290	52	400	64	—	—
Americas AB	103'-4" x 76'-4" x 23'	7,887	409	725	—	590	94	790	120	—	—
Americas BC	106'-10" x 76'-4" x 23'	8,238	422	748	—	610	94	820	120	—	—
Americas DE	103'-4" x 76'-4" x 23'	7,887	409	725	—	590	94	790	120	—	—
Americas EF	106'-10" x 76'-4" x 23'	8,238	422	748	—	610	94	820	120	—	—
Prefunction	196' x 50' x 23'	10,248	—	—	—	500	—	1,025	—	—	—



Level Three

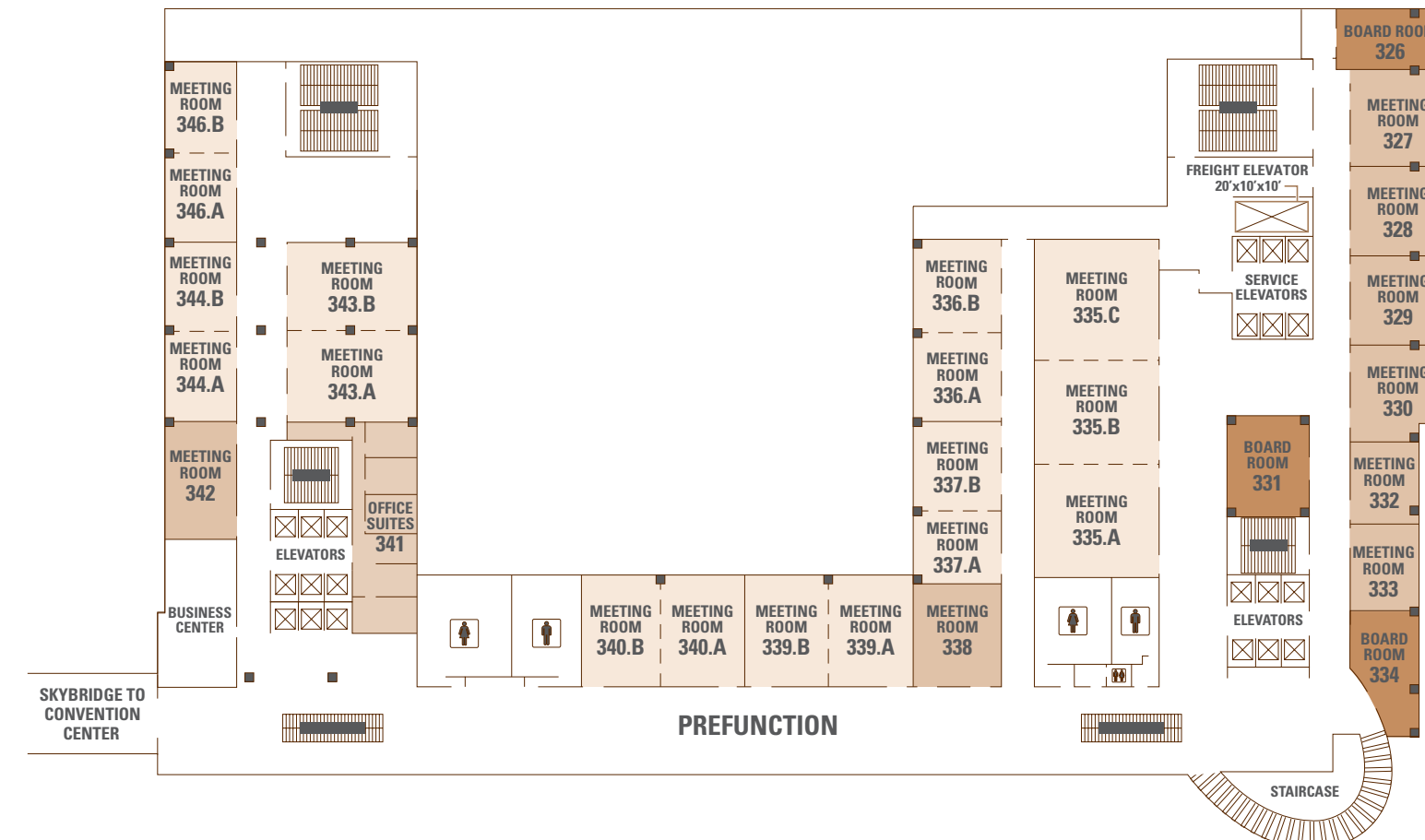

LEVEL THREE

	Dimensions	Square Feet	Classroom	Theatre	Conference	Banquet	U-Shape	Reception	Hollow Square
Boardroom 326	28'-5" x 27'-7" x 10'	763	—	—	14	—	—	—	—
Meeting Room 327	25'-8" x 27'-6" x 10'	752	34	63	18	30	20	75	24
Meeting Room 328	27'-8" x 27'-6" x 10'	798	36	67	18	30	20	75	28
Meeting Room 329	27'-8" x 27'-6" x 10'	808	37	67	18	30	20	80	28
Meeting Room 330	28'-3" x 27'-3" x 10'	832	38	69	18	30	20	80	28
Boardroom 331	18' x 35'-4" x 10'	781	—	—	14	—	—	—	—
Meeting Room 332	25'-11" x 21'-10" x 10'	548	24	46	18	30	20	54	22
Meeting Room 333	28'-1" x 21'-10" x 10'	588	27	50	18	30	20	58	22
Boardroom 334	38' x 21'-10" x 10'	658	—	—	12	—	—	—	—
Meeting Room 335	105'-8" x 39'-1" x 10'	4,079	209	340	60	220	60	400	60
Meeting Room 335A	35' x 39'-1" x 10'	1,400	72	127	24	70	27	140	30
Meeting Room 335B	32' x 39'-1" x 10'	1,175	60	98	24	70	27	110	30
Meeting Room 335C	37'-10" x 39'-1" x 10'	1,504	77	130	24	70	27	150	30
Meeting Room 335AB	67'-5" x 39'-1" x 10'	2,575	132	215	40	130	45	250	50
Meeting Room 335BC	70'-3" x 39'-1" x 10'	2,679	137	223	40	130	45	260	50
Meeting Room 336	56'-11" x 26'-8" x 10'	1,625	73	135	36	80	28	160	36
Meeting Room 336A	27'-7" x 26'-8" x 10'	793	36	66	18	40	20	75	22
Meeting Room 336B	28'-11" x 26'-8" x 10'	832	37	69	18	40	20	80	22
Meeting Room 337	51'-8" x 26'-8" x 10'	1,453	66	121	30	80	28	140	36
Meeting Room 337A	23'-8" x 26'-8" x 10'	660	30	55	18	40	20	65	22
Meeting Room 337B	27'-7" x 26'-8" x 10'	793	36	66	18	40	20	79	22
Meeting Room 338	30'-3" x 29' x 10'	830	38	69	18	40	20	80	22
Meeting Room 339	29'-8" x 54' x 10'	1,593	72	133	24	80	28	150	36
Meeting Room 339A	29'-8" x 27'-8" x 10'	785	36	65	18	40	20	75	22
Meeting Room 339B	29'-8" x 25'-11" x 10'	808	37	67	18	40	20	80	22
Meeting Room 340	29'-8" x 52'-4" x 10'	1,636	74	136	24	80	28	160	36
Meeting Room 340A	29'-8" x 25'-11" x 10'	828	38	75	18	40	20	80	22
Meeting Room 340B	29'-8" x 25'-11" x 10'	808	37	73	18	40	20	80	22
Office Suites 341	55' x 26'-7" x 10'	1,468	—	—	—	—	—	—	—
Meeting Room 342	36'-7" x 19'-6" x 10'	785	36	65	18	40	20	75	22
Meeting Room 343	55'-7" x 37'-4" x 10'	2,095	95	176	32	120	—	200	—
Meeting Room 343A	28'-1" x 37'-4" x 10'	1,062	48	90	18	60	20	100	28
Meeting Room 343B	27'-1" x 37'-4" x 10'	1,033	47	90	18	60	20	100	28
Meeting Room 344	19'-6" x 55'-7" x 10'	1,134	52	95	30	60	32	110	36
Meeting Room 344A	27'-7" x 19'-6" x 10'	584	27	47	18	30	20	58	22
Meeting Room 344B	27'-7" x 19'-6" x 10'	550	25	44	18	30	20	55	22
Meeting Room 346	56'-8" x 19'-6" x 10'	1,196	54	99	36	60	32	110	36
Meeting Room 346A	27'-7" x 19'-6" x 10'	622	28	47	18	30	20	62	22
Meeting Room 346B	28'-8" x 19'-6" x 10'	574	26	44	18	30	20	57	22

Level Four

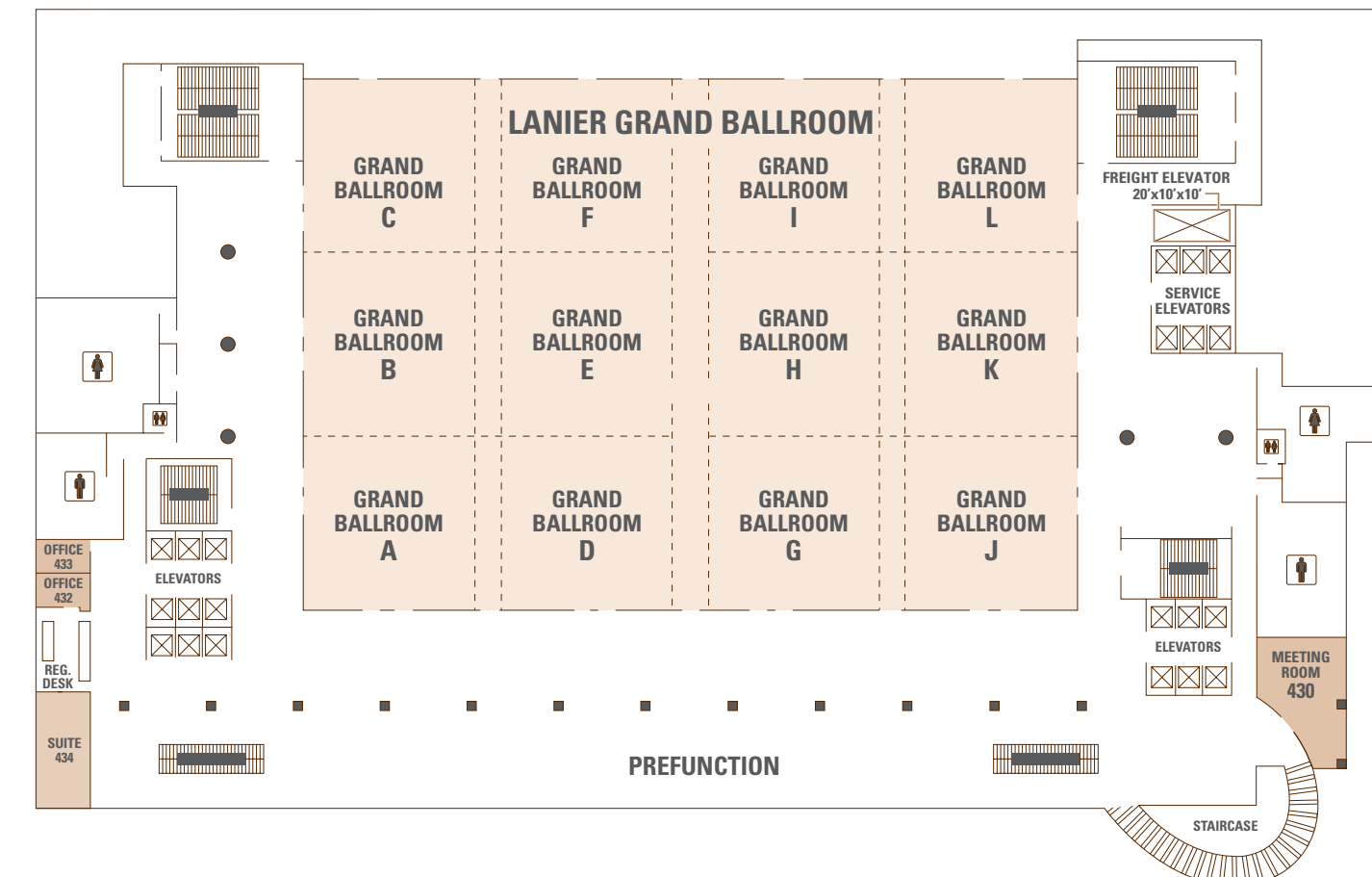

LEVEL FOUR

	Dimensions	Square Feet	Classroom	Theatre	Conference	Banquet	U-Shape	Reception	Hollow Square	Exhibit 8x10	Exhibit 10x10
Meeting Room 430	27'-5" x 37'-9" x 10'	815	—	70	12	30	10	80	12	—	—
Lanier Grand Ballroom	249'-2" x 156'-4" x 28'	39,138	2,174	3,558	—	2,800	—	3,900	—	290	230
Ballroom A	54'-8" x 48'-6" x 28'	2,741	140	249	32	200	47	270	60	—	—
Ballroom B	54'-8" x 55'-8" x 28'	3,071	158	279	40	220	54	370	72	—	—
Ballroom C	54'-8" x 51'-5" x 28'	2,831	145	257	32	210	54	280	60	—	—
Ballroom D	54'-8" x 48'-6" x 28'	2,732	140	248	32	200	47	270	60	—	—
Ballroom E	54'-8" x 55'-8" x 28'	3,080	161	280	40	220	54	300	72	—	—
Ballroom F	54'-8" x 51'-5" x 28'	2,840	146	258	32	210	47	280	60	—	—
Ballroom G	54'-8" x 48'-6" x 28'	2,732	140	248	32	200	47	270	60	—	—
Ballroom H	54'-8" x 55'-8" x 28'	3,080	161	280	40	220	47	300	72	—	—
Ballroom I	54'-8" x 51'-5" x 28'	2,840	146	258	32	210	47	280	60	—	—
Ballroom J	54'-8" x 48'-6" x 28'	2,741	140	249	32	200	47	270	60	—	—
Ballroom K	54'-8" x 55'-8" x 28'	3,071	158	279	40	220	47	370	72	—	—
Ballroom L	54'-8" x 51'-5" x 28'	2,831	145	257	32	210	47	280	60	—	—
Ballroom A-B, J-K (ea.)	54'-8" x 104'-6" x 28'	5,812	324	528	—	430	75	580	84	—	—
Ballroom A-C, J-L (ea.)	54'-8" x 156'-4" x 28'	8,643	508	785	—	640	—	860	—	—	—
Ballroom A-F, G-L (ea.)	118' x 156'-4" x 28'	18,620	1,095	1,692	—	1,380	—	1,860	—	—	—
Ballroom A-I, D-L (ea.)	185' x 156'-4" x 28'	29,170	1,715	2,650	—	2,160	—	2,910	—	—	—
Ballroom B-C, K-L (ea.)	54'-8" x 107'-5" x 28'	5,902	347	536	—	430	75	590	—	—	—
Ballroom D-E, G-H (ea.)	54'-8" x 104'-6" x 28'	5,812	342	528	—	430	75	580	84	—	—
Ballroom D-F, G-I (ea.)	54'-8" x 156'-4" x 28'	8,652	508	786	—	640	—	860	—	—	—
Ballroom D-I	121'-8" x 156'-4" x 28'	19,202	1,129	1,745	—	1,400	—	1,920	—	—	—
Ballroom E-F, H-I (ea.)	54'-8" x 107'-5" x 28'	5,920	348	538	—	430	75	590	84	—	—
Prefunction	289'-7" x 46'-8"	10,715	—	—	—	650	—	1,070	84	—	—
Office 432	12' x 10' x 8'	120	—	—	—	—	—	—	—	—	—
Office 433	12' x 10' x 8'	120	—	—	—	—	—	—	—	—	—
Suite 434	31' x 30' x 28'	930	—	—	—	50	—	100	—	—	—

