







wilderness rates

luxury rooms	\$425/guest
1-3 bdrm suites	\$465/guest

nightly rates based on minimum occupancies. extra guests are \$225/night (\$265/night in suites) each, up to max occupancies. children 4 and under are free - please call for single occupancy or corporate retreat pricing.

**lakeside, individually designed accommodation*

**valet parking, wireless internet, and nightly turn-down service*

**full board; 3 gourmet meals per day, hors d'oeuvres, and regular, non-alcoholic beverages*

**core resort amenities/all non-guided activities (lounge, games, media room, pool, hot tub, swim dock, canoes, kayaks, fishing off the dock or shore, bocce ball, horseshoes, yard games, mini-golf, and over 25 miles of private, hand-created hiking trails)*

**unlimited participation in scheduled/guided activities (zip lines, atv tours, water sport excursions, ranger tours, leisure boat rides, sunset cruises, guided nature hikes, canoe/kayak tours and other programmed events; each scheduled at least 1x daily, pending weather)*

an automatic 15% service charge (as the resort has a non-tipping environment) will be added to rates above and all resort charges, plus 5.975% sales tax. all buildings and areas are **non-smoking**, except for the designated bonfire pits. only 4 units are pet-friendly +\$40 per night; must pre-book. private boat slips are also available for \$25 per night extra.

accommodations

each unit is individually designed and features a large rainfall shower, champagne bubble tub, all natural *eco boutique* toiletries, complimentary wireless internet, a flat screen tv with satellite cable, dvd player upon request, an assortment of coffee/tea, and complimentary laundry.

luxury king and double queen (min 2 / max 4 guests)

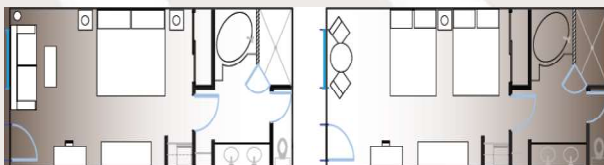

one bedroom suite (min 2 / max 4 guests)



two bedroom suite (min 4 / max 7 guests)



three bedroom suite (min 4 / max 9 guests)

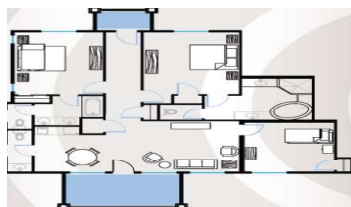

total # of separate bedrooms = 36, not including living rooms

dining

full board includes 3 gourmet meals per night of stay, including breakfast and lunch on the day of departure. regular/non-alcoholic beverages, evening hors d'oeuvres, snacks, and s'mores by the bonfires are included as well.

guided activities and spa services

on-site resort guided activities do not need to be reserved in advance unless with larger group or event specifics. please see the a la carte menu for pricing information. notify the resort concierge with as much advanced notice as possible (prior to arrival) for any desired treehouse spa services or professionally guided bass fishing trips. all other guided activities are scheduled daily for participation, weather pending, and may be booked while at the resort.

driving directions

please follow these driving directions once on highway mo-39. turn east (can only turn one way) onto stallion bluff; continue for about 1 mile. turn hard right to stay on stallion bluff rd and continue on the same road for approximately 12 more miles. expect to travel in every direction many times during this last 25-30 minutes, being careful of sharp turns.

booking policies

a \$500 per room deposit is required to reserve a stay. cancellation received no later than 30 days will receive a refund of the deposit. cancellation within 30 days prior to the arrival date will forfeit the deposit. other terms apply for group bookings; as listed in retreat agreement. guests who wish to rent a boat, please see *cape fair* and *hideaway marina* rental information at www.capefairmarina.com; resort boat transfer is available (\$40-\$80) for convenient pick-up and drop-off by water with a resort guide.

stonewater cove resort and spa, llc

1257 sunset timbers trail shell knob, missouri 65747

adventuring

non-guided activities

equipment available to use at your leisure

canoeing, kayaking, dock fishing, hiking, pool, hot tub, swim dock, yard games, lounge, bar area, media room games and movies, bocce ball, and miniature golf

guided activities

each scheduled daily for participation

- ✓ **zip line experiences** (full five run of zip lines); weight limit ~75-275 lbs.
- ✓ **atv tours** (one and two hours; not including safety training and skills assessment); beginner to advanced
- ✓ **ranger tours** (5 person atv with driver); motorized forest exploration
- ✓ **water sport excursions** (tubing, two skis, slalom skis, wakeboarding, and kneeboarding); activity guides to help!
- ✓ **sunset boat tours** (~1.5 hours total)
- ✓ *all guided activities are scheduled at least once per day – pending weather*

additional a la carte activities and guest services:

professionally guided fishing trip

half day | \$275 for 2 guests

\$75 each additional guest (max 3 per boat)

helicopter tour | priced upon request

car service | to/from branson entertainment or airports: springfield, mo (sgf) & fayetteville, ar (xna) – please contact us for private planes and smaller airports

treehouse spa services

guests should arrive to the treehouse spa at least 15 minutes before service appointment times to change into robes and enjoy the meditation room before the therapist brings you to one of our two private treatment treehouses. just a short amble on the north side of the lodge, the therapists work to meet the many unique needs of guests to harness and nourish tranquility of mind, restoration-rejuvenation of the body, and inspiration-comfort to the soul.

custom massage

swedish, deep tissue, therapeutic, sports, and prenatal

60 minutes | \$165 per person

90 minutes | \$215 per person

hot stone massage

60 minutes | \$190 per person

90 minutes | \$245 per person

enhancement services only, available to add-on to 60-90 minute massages:

basic foot soak | \$40 per guest

warm, aromatic foot bath

deluxe foot treatment | \$70 per guest

basic foot soak plus exfoliation,

mud mask, and massage

deluxe face treatment | \$95 per guest

gentle exfoliation and polish, including

a rose mud mask, shoulder and neck

massage, hot and cold stone facial

massage, and rich herbal crème

dining information

dining at stonewater cove is always a highlight of the day. our team takes pride in creating menus with only the finest of ingredients and delectable options for all of our guests.

for children 11 and under we have our kids menu, freshly made to order items for simpler tastes.

please let us know before your arrival if there are any dietary allergies or restrictions in your party.

dinner menu sample

one

duet of cauliflower and
butternut squash soup

two

blistered hatch pepper
compressed watermelon, seared sea scallop, feta,
prociutto chip, balsamic

three

short rib agnolotti
truffle jus and pecorino
or
pan seared salmon
wasabi mash, greens, miso buerre blanc
or
beef tenderloin
celeriac mousseline, heirloom baby carrot, truffle
jus

four

bond family's peach dream

plus nightly s'mores at the bonfires ©

thank you for choosing to visit stonewater cove resort and spa.

as you may notice, nothing we write is capitalized. for those of you who are curious as to why this is, it fits hand in hand with our philosophy on what we offer and how we treat our guests. no one, no name, and no place is more important than another here. wanting nothing more than to stand out beyond the wild, comfort and bliss, this is a place to come and escape and be at one with each other and nature.

children at heart, and children when here, we are born equal with eyes of curiosity, wonder and all-knowing, all at the same time. with no sense of importance beyond others and things, we strive to be in harmony with the birds and the trees.

no land versus water, no stars versus clouds... we are who we are...and for that we are proud. rustic and elegant, rugged and luxurious, outdoors and inside, to us, it's all the same. gourmet food, backyard barbeques, if it tastes good, that's all that matters.

the bond family



quick packing list

resort casual/casual wear
close-toed shoes and long pants
(for atv tours and hiking)
swimsuits, sunscreen, and sunglasses

airports

springfield, mo (sgf)

fayetteville, arkansas (xna)

(each approximately 1 ½ hours away)

**please call for private aircraft information*

directions from highway mo-39

turn east onto stallion bluff road

(only one way to turn; approximately 3 miles north of shell knob, across from the central crossing fire station)

continue for about 1 mile, and turn right
(following signs to "barnabus camp")

...

**continue on stallion bluff road
for another ~12 miles**

(look for cedar fence with black posts and hedges on the left side of the road)

gate entrance to stonewater is on the left
(follow signs to check-in at the main lodge)

additional transportation information

please call our concierge at (417)858-2563
or email info@stonewatercove.com
for help arranging car, helicopter, and boat
taxi service or marina rentals upon request.